

**Hypertherm®**

**PAC121TS**

**Torch Lead  
Replacement**

**Field Service Bulletin**

**IM-266**

**(P/N 802660)**

**Revision 1 December, 1997**

**HYPERTHERM, Inc.  
P.O. Box 5010  
Hanover, New Hampshire 03755-5010  
Tel.: (603) 643-3441  
Fax: (603) 643-5352**

**© Copyright 1996 Hypertherm, Inc.  
All Rights Reserved**

**HYPERTHERM is a trademark of Hypertherm, Inc.  
and may be registered in the United States and/or other countries**

## ***Hypertherm Offices Worldwide:***

### **Hypertherm, Inc.**

Etna Road, P.O. Box 5010  
Hanover, NH 03755 USA  
Tel.: (603) 643-3441 (Main Office)  
Fax: (603) 643-5352 (All Departments)  
Tel.: (800) 643-9878 (Technical Service – toll-free in USA and Canada)  
Tel.: (800) 737-2978 (Customer Service – toll-free in USA and Canada)  
email: info@hypertherm.com (General Information)  
email: service@hypertherm.com (Technical/Customer Services)

### **Hypertherm Plasmatechnik GmbH**

Technologiepark Hanau  
Rodenbacher Chaussee 6  
D-63457 Hanau-Wolfgang, Germany  
Tel.: 49 6181 58 2100  
Fax: 49 6181 58 2134

### **Hypertherm (S) Pte Ltd**

No. 19 Kaki Bukit Road 2  
K.B. Warehouse Complex  
Singapore 417847  
Tel.: 65 841 2489  
Fax: 65 841 2490

### **Hypertherm UK Ltd**

9 Berkeley Court, Manor Park  
Runcorn, Cheshire, England WA7 1TQ  
Tel.: 44 1928 579 074  
Fax: 44 1928 579 604

### **France**

15 Impasse des Rosiers  
95610 Eragny, France  
Tel.: 33 1 30 37 15 28  
Fax: 33 1 30 37 15 79

### **Hypertherm S.r.L.**

Via Torino 2  
20123 Milan, Italy  
Tel.: 39 02 725 46 312 (Customer Service)  
Tel.: 39 02 725 46 314 (Technical Service)  
Fax: 39 02 725 46 400 (All Departments)

### **Hypertherm B.V.**

Burg, Haverkampstraat 13  
7091 CN Dinxperlo, The Netherlands  
Tel.: 31 315 655 866 (Customer Service)  
Fax: 31 315 655 886

### **European Technical Support Organization (ETSO)**

Edisonstraat 12  
3281 NC Numansdorp, The Netherlands  
Tel.: 00 800 4973 7843 (00 800 Hypertherm) – (toll-free Technical Service)  
Tel.: 31 186 659494  
Fax: 31 186 659495

### **Japan**

Shinjuku Park Tower  
30th Floor  
3-7-1 Nishi-Shinjuku  
Shinjuku-ku, Tokyo  
163-1030, Japan  
Tel.: 81 03 5326 3142  
Fax: 81 03 5326 3001

# Replacing the PAC121TS Lead

P/N: 129001 or 129002



## WARNING



**SHOCK HAZARD: Disconnect the old torch lead from the power supply before replacing with the new torch lead.**

1. Remove the 5 screws that secure the handle halves together and remove handles from the torch main body, torch switch and safety trigger.

The following drawings represent 4 variations of torches called PAC121T and PAC121TS with their distinguishing features. If your torch looks like Torch #1, you need replacement lead 129063 (15 ft/4.5 m), or 029549 (25 ft/7.5 m), or 029550 (50 ft/15 m). This instruction bulletin applies to torches 2, 3 and 4.

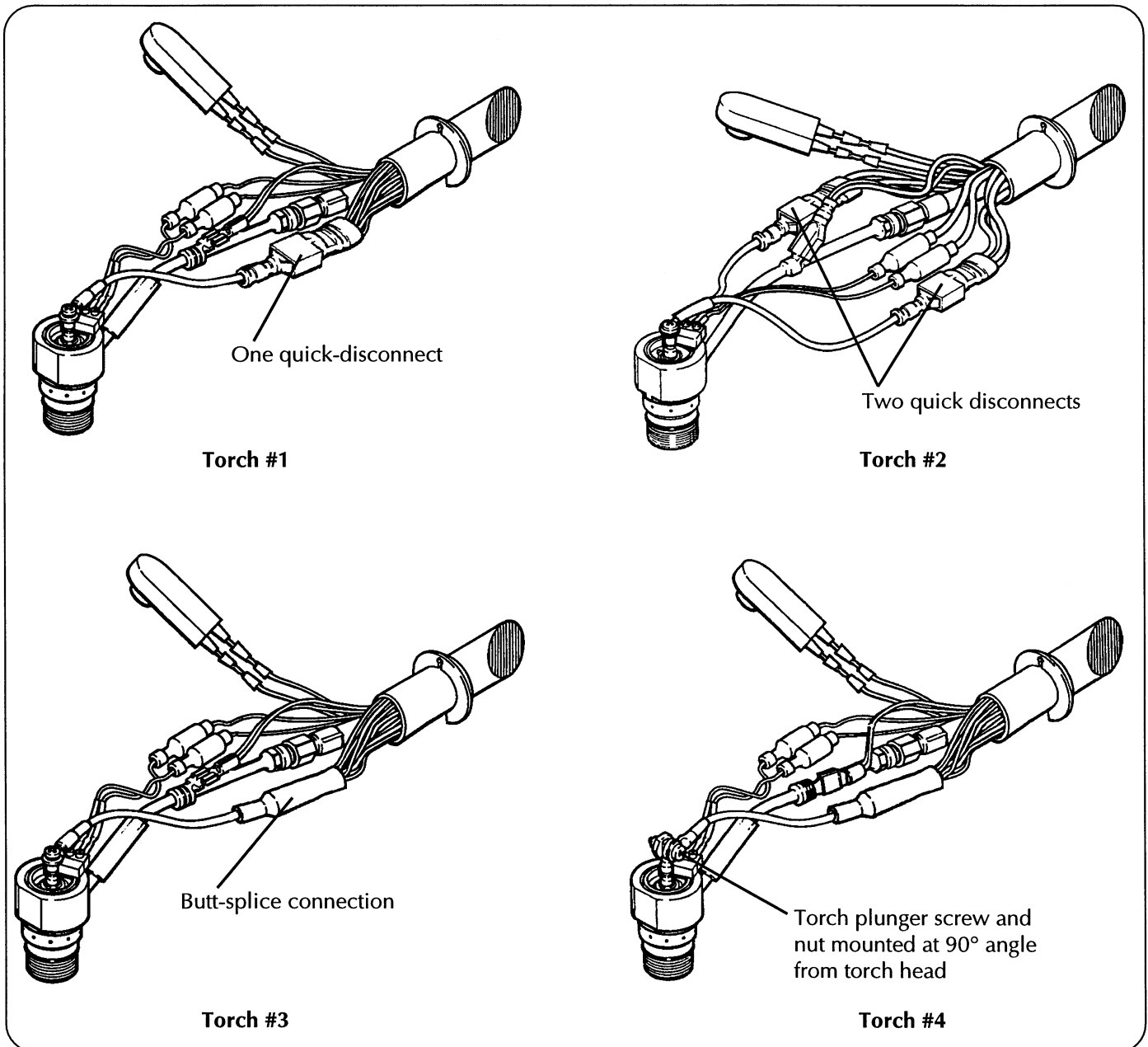

Figure 1 PAC121T and PAC121TS Torch Variations

## TORCH #2

### Torch Lead Removal and Replacement

Note: Disconnect wires by pulling on mating terminals. Do **not** pull on the wires.

#### Removal - Fig.2

1. Disconnect the red wires (2) attached to the pilot arc tab.
2. Disconnect the blue wires (2) from the cap sensor microswitch white wires (2).
3. Remove plunger screw from the torch main body and disconnect the black plunger wires (2). Note: Hold the plunger wire terminal with your fingers to keep the terminal and plunger from spinning as you turn the plunger screw.
4. Disconnect the torch main body and torch lead gas fittings using 5/16" (8mm) and 7/16" (11 mm) open-end wrenches.

#### Replacement - Fig.3

5. Connect the torch main body to the torch lead gas fitting using 5/16" (8mm) and 7/16" (11 mm) open-end wrenches.
6. Attach the red wire lead terminals to the pilot arc tab.
7. Connect the blue wires to the cap sensor microswitch white wires.
8. Remove the screw and nut from the replacement lead plunger wire. Screw the plunger wire lead into the torch main body using the screw that came with the replacement leads. Note: Hold the plunger wire terminal with your fingers to keep the terminal and plunger from spinning as you turn the plunger screw.
9. Install the torch main body and the torch switch back into the handle. Be certain that the torch switch slides into position above the safety trigger, and that trigger movement activates the switch pushbutton and then releases. While positioning the handle halves together, be careful not to pinch any wires.
10. Replace the 5 screws to secure the handle halves together.

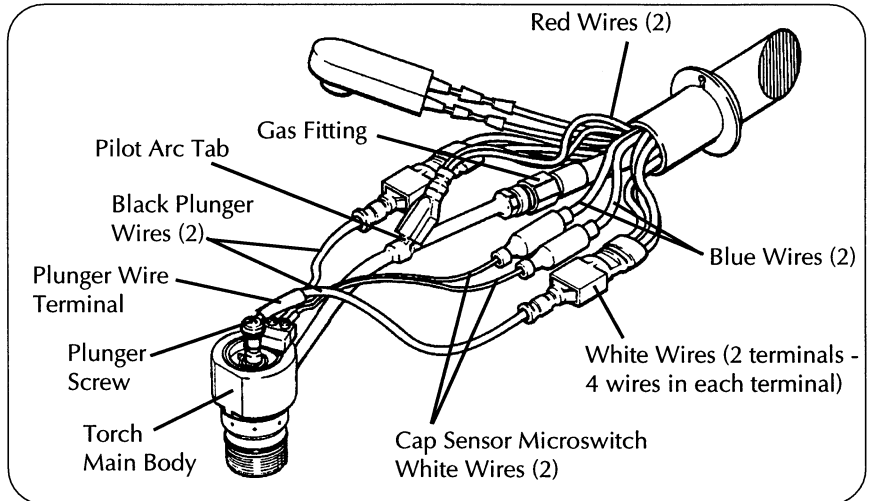

Figure 2 Torch #2 Torch Lead Removal

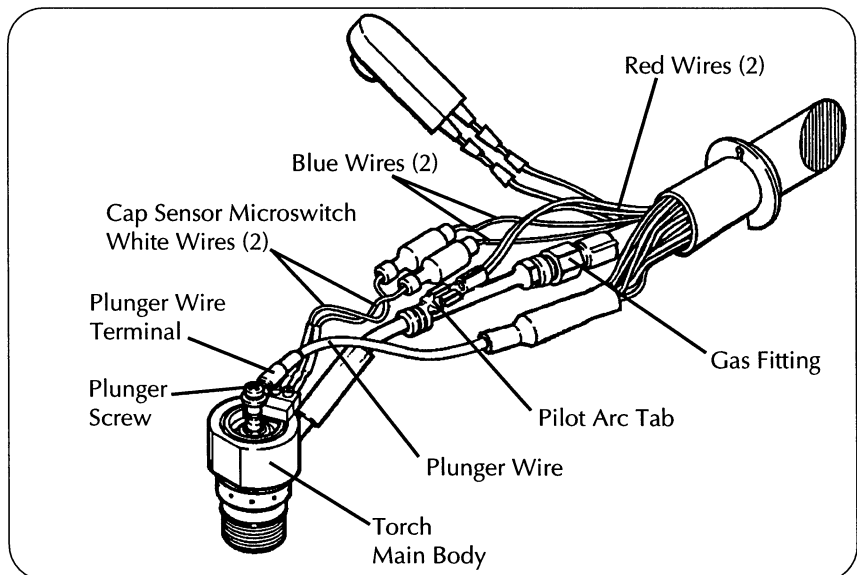

Figure 3 Torch #2 Torch Lead Replacement

## TORCH #3

### Torch Lead Removal and Replacement - Fig. 4

1. Disconnect the red wires (2) attached to the pilot arc tab.
2. Disconnect the blue wires (2) from the cap sensor microswitch white wires (2).
3. Disconnect the plunger wire from the torch main body by removing the plunger screw. Note: Hold the plunger wire terminal with your fingers to keep the terminal and plunger from spinning as you turn the plunger screw.
4. Disconnect the torch main body and torch lead gas fittings using 5/16" (8mm) and 7/16" (11 mm) open-end wrenches.
5. Replace the new torch leads by reversing instructions 1-4. Note: Screw the plunger wire lead into the torch main body using the screw that came with the replacement leads.
6. Install the torch main body and the torch switch back into the handle. Be certain that the torch switch slides into position above the safety trigger, and that trigger movement activates the switch pushbutton and then releases. While positioning the handle halves together, be careful not to pinch any wires.
7. Replace the 5 screws to secure the handle halves together.

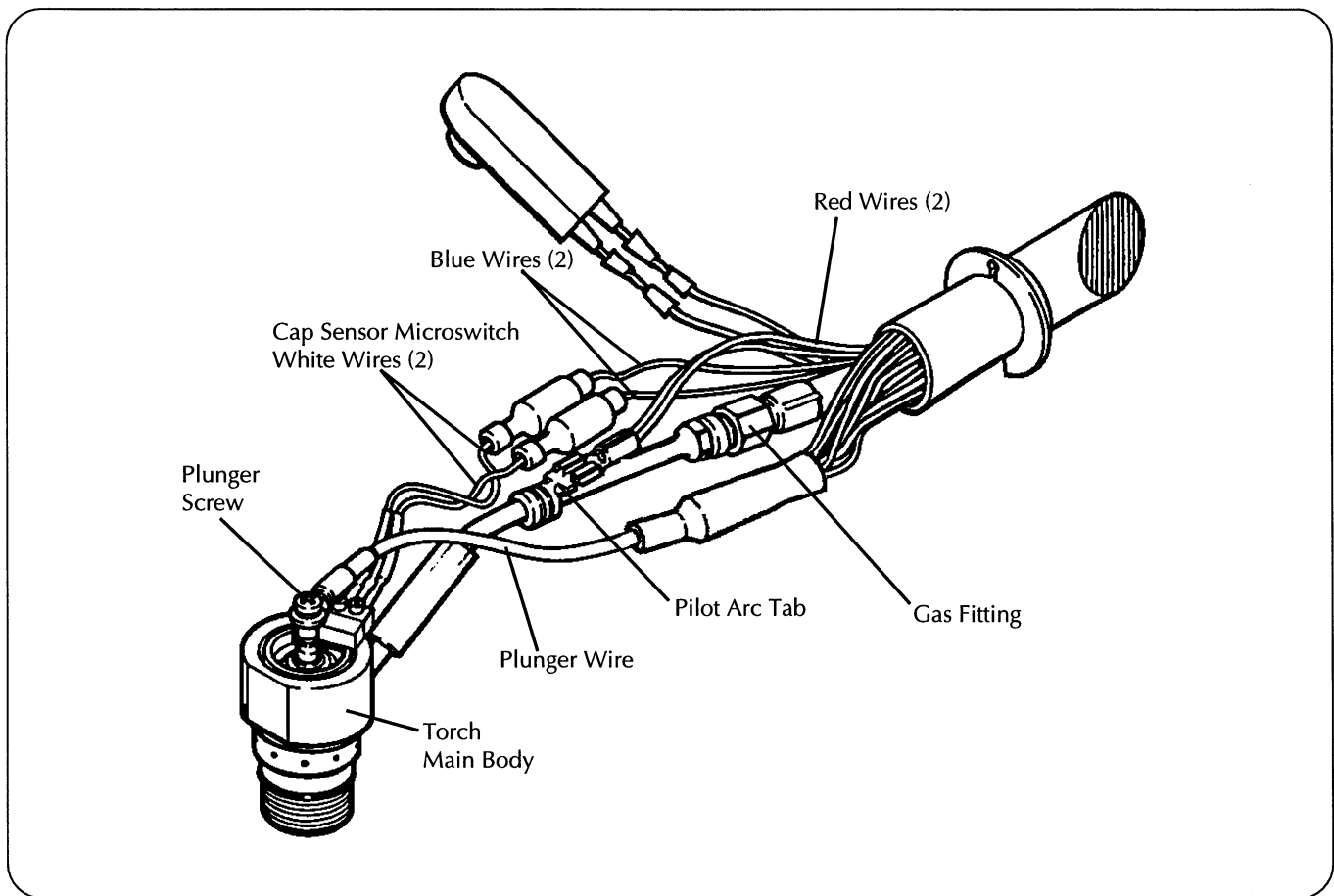

Figure 4 Torch #3 Lead Removal and Replacement

## TORCH #4

### Torch Lead Removal and Replacement - Fig. 5

1. Disconnect the red wires (2) attached to the pilot arc tab.
2. Disconnect the blue wires (2) from the cap sensor microswitch white wires (2).
3. Disconnect the plunger wire from the torch main body by removing the plunger screw. Note: Hold the plunger nut with a 1/4" nut driver or wrench when removing the screw.
4. Disconnect the torch main body and torch lead gas fittings using 5/16" (8mm) and 7/16" (11 mm) open-end wrenches.
5. Replace the new torch leads by reversing instructions 1-4.
6. Install the torch main body and the torch switch back into the handle. Be certain that the torch switch slides into position above the safety trigger, and that trigger movement activates the switch pushbutton and then releases. While positioning the handle halves together, be careful not to pinch any wires.
7. Replace the 5 screws to secure the handle halves together.

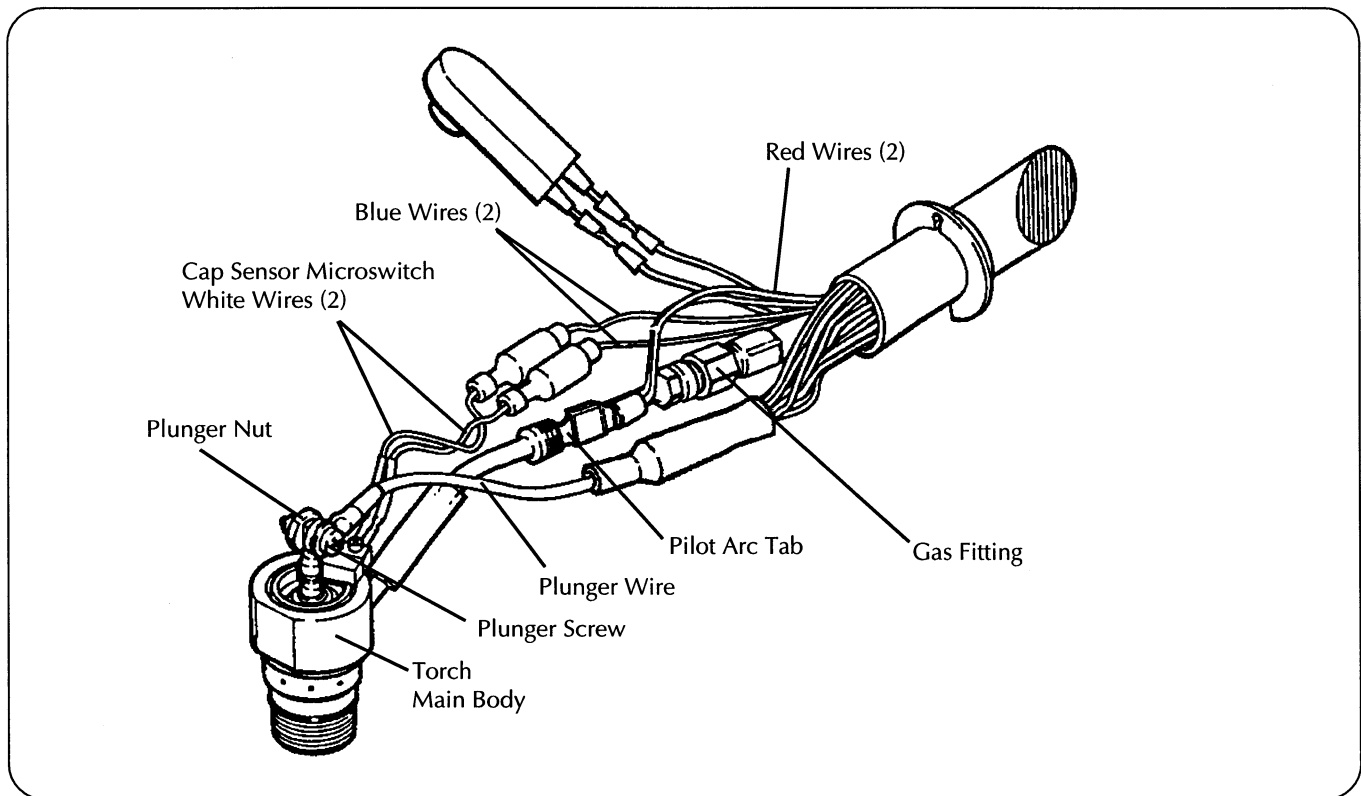

Figure 5 Torch #4 Lead Removal and Replacement

