

# ***PAC121MS***

## **Torch Plunger Wire Replacement**

**Kit: 128336**

### **Field Service Bulletin**

**IM-335**

**(P/N 803350)**

**Revision 0 August, 1998**

**HYPERTHERM, Inc.  
P.O. Box 5010  
Hanover, New Hampshire 03755-5010  
Tel.: (603) 643-3441  
Fax: (603) 643-5352  
<http://www.hypertherm.com>  
[email:info@hypertherm.com](mailto:info@hypertherm.com)**

© Copyright 1998 Hypertherm, Inc.  
All Rights Reserved

Hypertherm and Powermax are trademarks of Hypertherm, Inc., and may be registered in the United States and/or other countries

## ***Hypertherm Offices Worldwide:***

### **Hypertherm, Inc.**

**Etna Road, P.O. Box 5010  
Hanover, NH 03755 USA  
Tel.: (603) 643-3441 (Main Office)  
Fax: (603) 643-5352 (All Departments)  
Tel.: (800) 643-9878 (Technical Service)  
Tel.: (800) 737-2978 (Customer Service)**

### **Hypertherm Plasmatechnik GmbH**

**Technologiepark Hanau  
Rodenbacher Chaussee 6  
D-63457 Hanau-Wolfgang, Germany  
Tel.: 49 6181 58 2100  
Fax: 49 6181 58 2134**

### **European Technical Support Organization (ETSO)**

**Technologiepark Hanau  
Rodenbacher Chaussee 6  
D-63457 Hanau-Wolfgang, Germany  
Tel.: 49 6181 58 2100  
Fax: 49 6181 58 2134**

### **Hypertherm Singapore Pte Ltd**

**No. 19 Kaki Bukit Road 2  
K.B. Warehouse Complex  
Singapore 417847, Republic of Singapore  
Tel.: 65 841 2489  
Fax: 65 841 2490**

### **Hypertherm U.K.**

**9 Berkeley Court • Manor Park  
Runcorn, Cheshire, England WA7 1TQ  
Tel.: 44 1928 579 074  
Fax: 44 1928 579 604**

### **Hypertherm France**

**10, Allée de l'Isara  
F-95000 Cergy-Pontoise, France  
Tel.: 33 1 34 24 03 05  
Fax: 33 1 34 25 09 64**

### **Hypertherm Italy**

**Via Stillicone 18  
20154 Milan, Italy  
Tel.: 39 2 34 53 22 11  
Fax: 39 2 34 53 20 18**

# Replacing PAC121MS Torch Plunger Wire

Kit: 128336

## 128336 Kit Contents

Part Number	Description	Quantity
075503	Nut: 4-40	1
075504	Machine Screw: 4-40 X 5/16 in.	1
123357	PAC121MS Torch Replacement Plunger Wire (w/clear heat shrink)	1
-	4-inch Tie-wrap	3
803350	Field Service Bulletin: PAC121MS Torch Plunger Wire Replacement	1

# Replacing PAC121MS Torch Plunger Wire

Kit: 128336



## WARNING



**ALL WORK MUST BE PERFORMED ONLY BY  
HYPERTHERM DISTRIBUTORS OR QUALIFIED TECHNICIANS!!**

## TORCH LEAD PLUNGER WIRE - REMOVE (FIGURE 1)

1. Set the power supply power switch to O (off), unplug the power cable, and disconnect the gas supply. Disconnect the torch lead from the power supply.
2. Unscrew the torch position sleeve from the torch mounting sleeve and slide it back out of the way.
3. Remove the 3 screws securing the torch mounting sleeve to the torch body. Save the torch mounting sleeve and the screws.
4. Disconnect the two plunger wires from the torch lead connectors. Leave all other connections, including the red wire and the blue wires, intact.
5. Disconnect the plunger wire from the torch body plunger using a Philips head screwdriver. Some versions will also require a 1/4 inch (6 mm) nut driver. Discard the screw and nut, if applicable.
6. Remove the plunger wire.

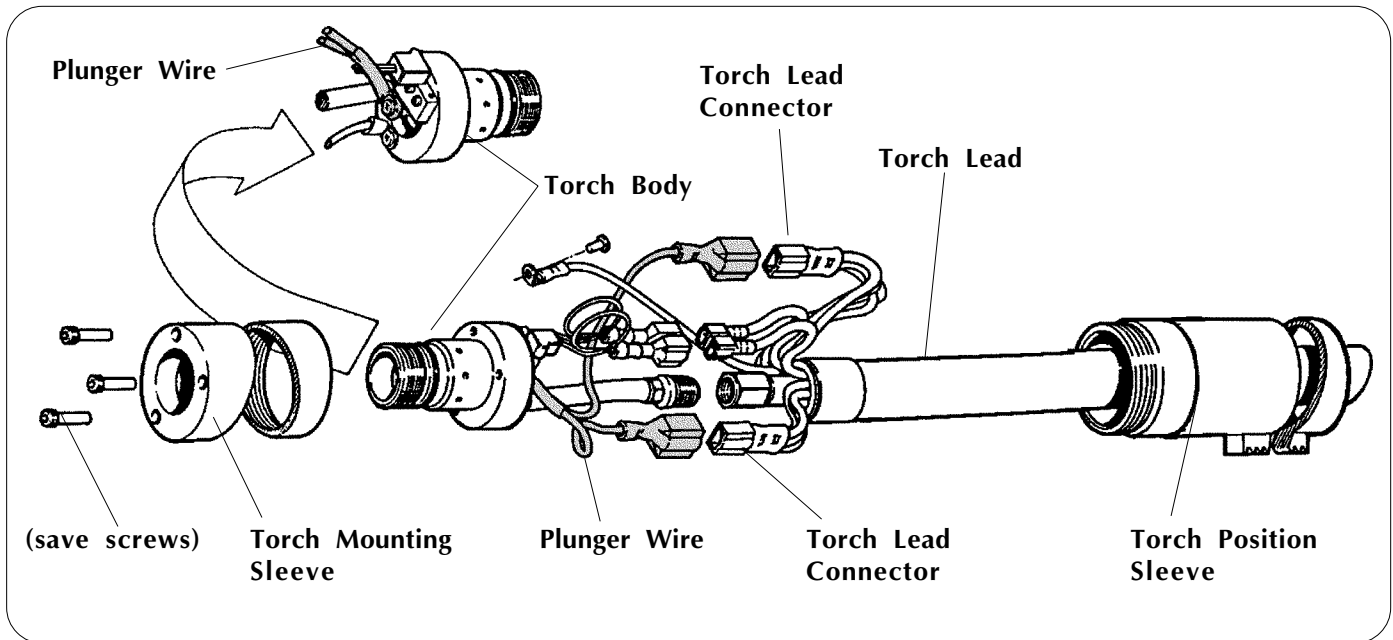

Figure 1 PAC121MS Torch Plunger Wire - Remove/Install

# Replacing PAC121MS Torch Plunger Wire

Kit: 128336

## TORCH LEAD PLUNGER WIRE - INSTALL (FIGURE 1 AND 2)

1. Install the new plunger wire to the plunger using the Phillips head screw (and nut if applicable) included in the kit. Some plunger designs will also require the use of the nut.
2. Torque the screw to 4 in. lb. If the screw and nut are required, torque to 7 in. lb.
3. Orient the terminal to point away from the torch body, bending the terminal if necessary.
4. Position the clear heat shrink tubing over the plunger terminal and apply heat until tubing is snug.
5. Connect the two plunger wires to the torch lead connectors.
6. Tie the plunger wires back on the torch lead as shown in Figure 2. With the ties in place and snugged down, adjust the wires so that there is 1/4 inch (6 mm) of slack between the wires and the gas nut. Tighten and trim ties.
7. Attach the torch mounting sleeve to the torch body with the 3 screws (Figure 1). Torque to 7 in. lb.
8. Screw the torch position sleeve to the torch mounting sleeve.
9. Reconnect the torch to the power supply.

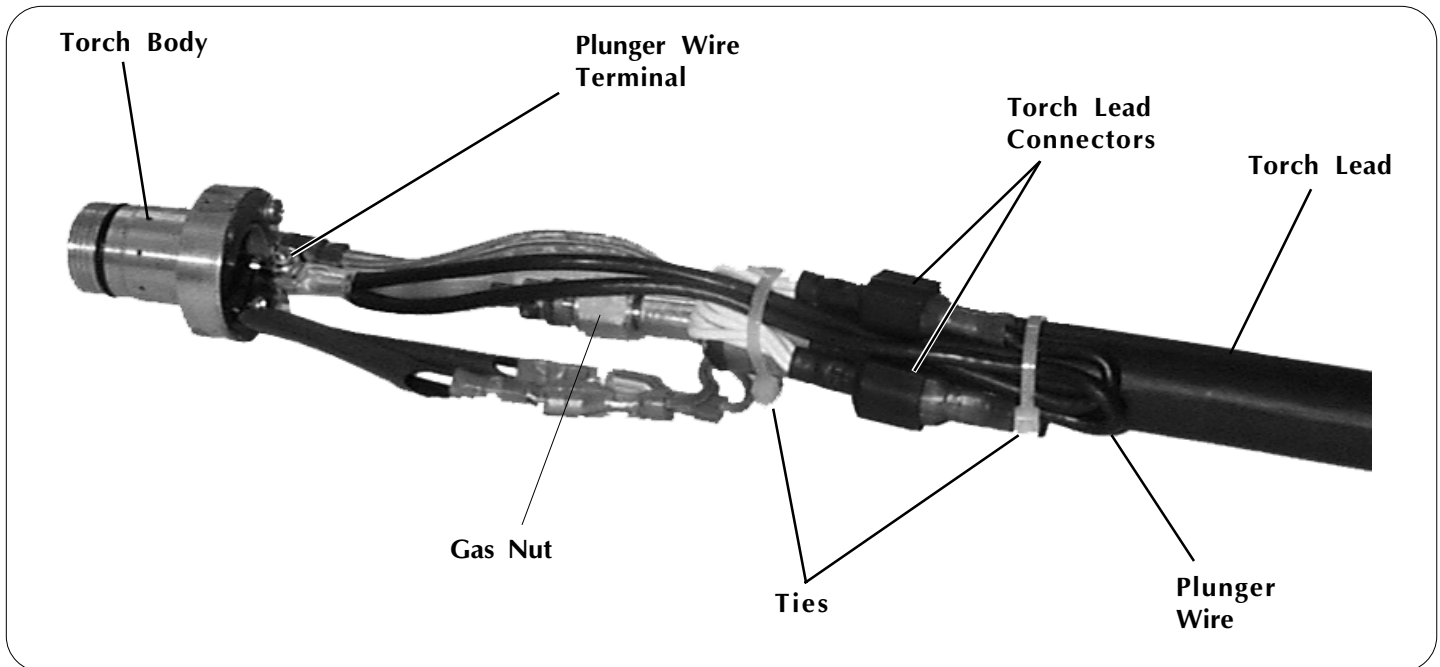

Figure 2 PAC121MS Torch Plunger Wire - Install