

# **PAC120**

## ***Torch Retrofit Instructions***

**801130 - Rev. 0**



# **PAC120**

## **Torch Retrofit Instructions**

**IM-113**  
**(P/N 801130)**

**Revision 0 August 1990**

**Hypertherm, Inc.**  
**P.O. Box A-10 Etna Road**  
**Hanover, New Hampshire 03755**  
**(603) 643-3441**

**© Hypertherm, Inc., 1990**  
**All Rights Reserved**

## ***Hypertherm Offices Worldwide:***

### **Hypertherm, Inc.**

Etna Road, P.O. Box 5010  
Hanover, NH 03755 USA  
Tel.: (603) 643-3441 (Main Office)  
Fax: (603) 643-5352 (All Departments)  
Tel.: (800) 643-9878 (Technical Service – toll-free in USA and Canada)  
Tel.: (800) 737-2978 (Customer Service – toll-free in USA and Canada)  
email: info@hypertherm.com (General Information)  
email: service@hypertherm.com (Technical/Customer Services)

### **Hypertherm Plasmatechnik GmbH**

Technologiepark Hanau  
Rodenbacher Chaussee 6  
D-63457 Hanau-Wolfgang, Germany  
Tel.: 49 6181 58 2100  
Fax: 49 6181 58 2134

### **Hypertherm (S) Pte Ltd**

No. 19 Kaki Bukit Road 2  
K.B. Warehouse Complex  
Singapore 417847  
Tel.: 65 841 2489  
Fax: 65 841 2490

### **Hypertherm UK Ltd**

9 Berkeley Court, Manor Park  
Runcorn, Cheshire, England WA7 1TQ  
Tel.: 44 1928 579 074  
Fax: 44 1928 579 604

### **France**

15 Impasse des Rosiers  
95610 Eragny, France  
Tel.: 33 1 30 37 15 28  
Fax: 33 1 30 37 15 79

### **Hypertherm S.r.L.**

Via Torino 2  
20123 Milan, Italy  
Tel.: 39 02 725 46 312 (Customer Service)  
Tel.: 39 02 725 46 314 (Technical Service)  
Fax: 39 02 725 46 400 (All Departments)

### **Hypertherm B.V.**

Burg, Haverkampstraat 13  
7091 CN Dinxperlo, The Netherlands  
Tel.: 31 315 655 866 (Customer Service)  
Fax: 31 315 655 886

### **European Technical Support Organization (ETSO)**

Edisonstraat 12  
3281 NC Numansdorp, The Netherlands  
Tel.: 00 800 4973 7843 (00 800 Hypertherm) – (toll-free Technical Service)  
Tel.: 31 186 659494  
Fax: 31 186 659495

### **Japan**

Shinjuku Park Tower  
30th Floor  
3-7-1 Nishi-Shinjuku  
Shinjuku-ku, Tokyo  
163-1030, Japan  
Tel.: 81 03 5326 3142  
Fax: 81 03 5326 3001

# PAC120 TORCH RETROFIT

---

## Purpose

The PAC120 torch main body retrofit instructions provide the necessary information to allow a person to remove the torch main body from the torch and replace it with the PAC120 torch retrofit kit.

## Customer Supplied Tools

#2 Phillips head screwdriver  
7/16" open-end wrench  
5/16" open-end wrench  
Wire cutters  
Sta-kon crimping tool  
T&B crimping tool, No. WT145A

## PAC120 Torch Retrofit Kit (# 028471)

Torch main body assembly, PAC120, # 020568  
Terminal, female QC insul 10-12, # 074017  
Bullet receptacle 16-14, # 074195  
Bullet plug 16-14 (2), # 074196

## Procedure

To remove the torch main body, refer to the procedure below and Figure 1. Note that the callouts on the figure correspond to the step numbers below.

1. Remove the five (5) screws holding the handle halves together.
2. Remove the torch main body and torch switch from the handle halves.

<p>Note: Prior to cutting any wires, identify the torch switch wires so that they are not accidentally cut; they are not part of the retrofit.</p>
--

3. Cut the two (2) white wires at the yellow splice. Leave approximately 3.5". (See Figure 2, Sheet 2 of 2 for wire lengths.)
4. Cut the red wire as close as possible to the terminal on the torch body fitting. Leave approximately 2.0".
5. Cut the two (2) blue wires 1/2" back from the cap sensor micro switch. Leave approximately 3.0".
6. Disconnect the torch main body and torch lead gas fittings using the wrenches.

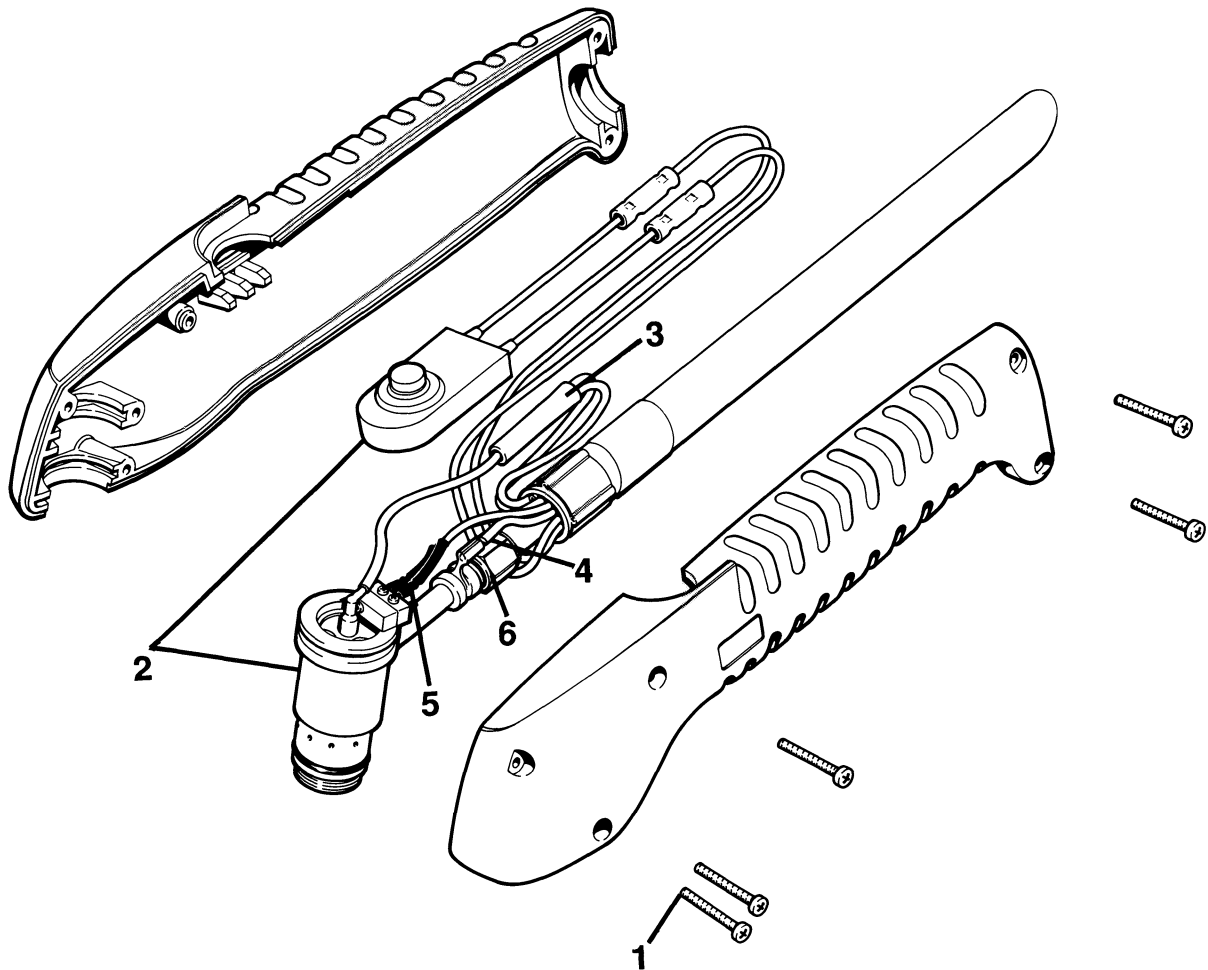

**Figure 1 PAC120 Torch Main Body Removal - Old Style**

To install the PAC120 retrofit kit, refer to the following procedure and Figure 2. Note that the callouts on the figure correspond to the step numbers.

1. Connect the torch main body assembly (# 020568) and torch lead gas fittings using the wrenches.
2. Connect the female terminal (# 074017) to the two (2) white wires from the torch lead using the T&B crimping tool. Connect the terminal to the black plunger wire terminal from the torch main body .
3. Connect the bullet receptacle (# 074195) to the red wire from the torch lead using the Sta-kon crimping tool. Connect the bullet receptacle to the bullet plug on the red wire from the torch main body.
4. Connect the bullet plugs (# 074196) to the two (2) blue wires using the Sta-kon crimping tool. Connect the bullet plugs to the bullet receptacles on the white wires from the cap sensor micro switch.

## PAC120 TORCH RETROFIT

5. Connect the Tytraps as shown.
6. Install the torch main body assembly and torch switch into one of the handle halves. While positioning the handle halves together, be careful not to pinch any wires. Be especially careful around the torch switch retainers.
7. Replace the five (5) screws to secure the handle halves together.

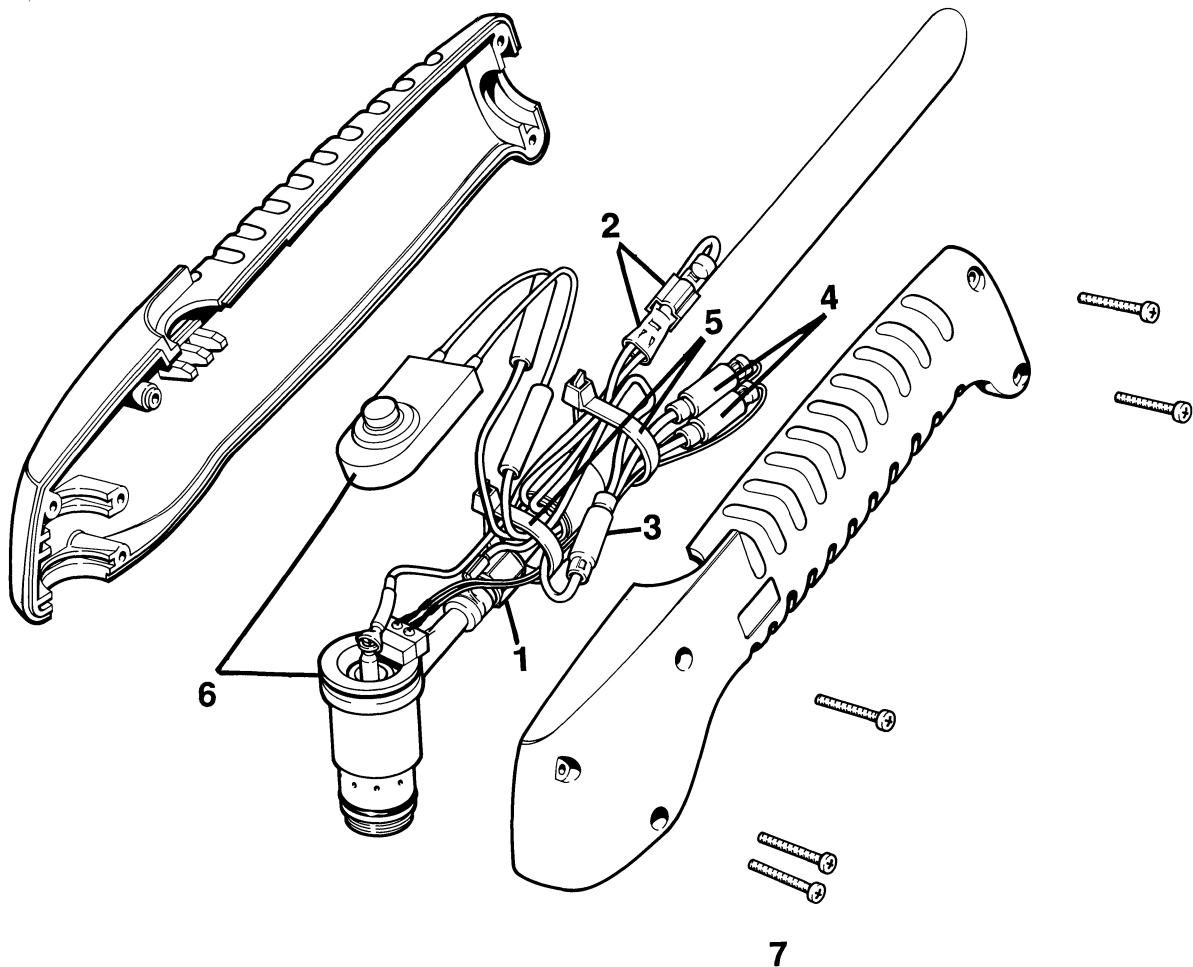

Figure 2 PAC120 Torch Retrofit Kit Installation (Sheet 1 of 2)

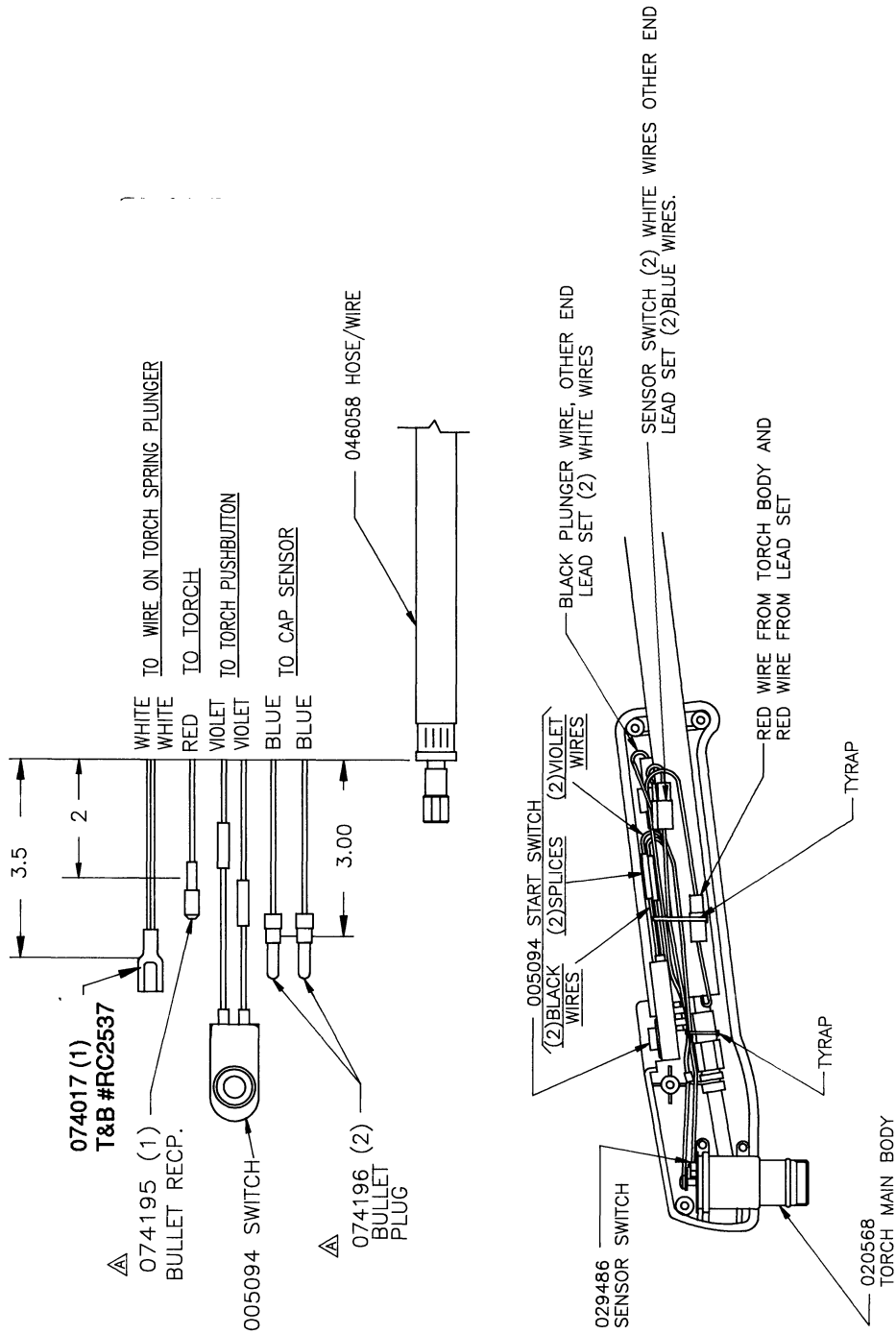

Figure 2 PAC120 Torch Retrofit Kit Installation (Sheet 2 of 2)