

powermax800

powermax900

600 Volt Conversion

Installation Manual
803200 - Rev. 0

Hypertherm
*The world leader in
plasma cutting technology*

powermax800®
powermax900®

600 Volt Conversion

Kit: 128312

Installation Manual
IM-320
(P/N 803200)

Revision 0 June, 1998

HYPERTHERM, Inc.
P.O. Box 5010
Hanover, New Hampshire 03755-5010
Tel.: (603) 643-3441
Fax: (603) 643-5352
<http://www.hypertherm.com>
[email:info@hypertherm.com](mailto:info@hypertherm.com)

© Copyright 1998 Hypertherm, Inc.
All Rights Reserved

HYPERTHERM and POWERMAX are trademarks of Hypertherm, Inc. and may be registered in the United States and/or other countries

Hypertherm Offices Worldwide:

Hypertherm, Inc.

Etna Road, P.O. Box 5010
Hanover, NH 03755 USA
Tel.: (603) 643-3441 (Main Office)
Fax: (603) 643-5352 (All Departments)
Tel.: (800) 643-9878 (Technical Service)
Tel.: (800) 737-2978 (Customer Service)

Hypertherm Plasmatechnik GmbH

Technologiepark Hanau
Rodenbacher Chaussee 6
D-63457 Hanau-Wolfgang, Germany
Tel.: 49 6181 58 2100
Fax: 49 6181 58 2134

European Technical Support Organization (ETSO)

Technologiepark Hanau
Rodenbacher Chaussee 6
D-63457 Hanau-Wolfgang, Germany
Tel.: 49 6181 58 2100
Fax: 49 6181 58 2134

Hypertherm Singapore Pte Ltd

No. 19 Kaki Bukit Road 2
K.B. Warehouse Complex
Singapore 417847, Republic of Singapore
Tel.: 65 841 2489
Fax: 65 841 2490

Hypertherm U.K.

9 Berkeley Court • Manor Park
Runcorn, Cheshire, England WA7 1TQ
Tel.: 44 1928 579 074
Fax: 44 1928 579 604

Hypertherm France

10, Allée de l'Isara
F-95000 Cergy-Pontoise, France
Tel.: 33 1 34 24 03 05
Fax: 33 1 34 25 09 64

Hypertherm Italy

Via Stillicone 18
20154 Milan, Italy
Tel.: 39 2 34 53 22 11
Fax: 39 2 34 53 20 18

Section 1 SPECIFICATIONS

In this section:

Introduction	1-2
Specifications	1-2
600 Volt Powermax900 Power Supply	1-2

SPECIFICATIONS

INTRODUCTION

The instructions in this manual will enable a qualified electronics technician to convert the 208/240/480 volt Powermax900 or 208/240/480 volt Powermax800 power supply into a 600 volt power supply. The kit (128312) contains a transformer and case, wheels, castors, and 2 line cords - one to hook up to a line disconnect box or 3-phase plug, and a shorter cord to connect from the transformer case to the link box at the rear of the Powermax - See Figure 2-1. See also **Section 3** for a list of parts for the 600 volt conversion kit.

When installation is complete, refer to the Operator Manual for setup, operating instructions and maintenance of the Powermax system.

SPECIFICATIONS See the operator manual for Powermax800 specifications

600 Volt Powermax900 Power Supply

Rated Open Circuit Voltage (OCV) (U_0)	300VDC
Rated Output Current (I_2)	20-50 amps
Rated Output Voltage (U_2)	120VDC
Duty Cycle (X) @ 40°C	50% ($I_2=55A$, $U_2=120V$) See data tag on power supply for more information on duty cycle
Ambient temperature/duty cycle	Power supplies will operate between +14° and 104° F (-10° and +40° C). Power supplies operated in an ambient temperature above 86° F (30° C) may show some decrease in duty cycle.
Apparent Input Power (S_1)	11.4kVA (U_1I_1)
Input Voltage (U_1)/Input Current (I_1)	
@ 6.6 kw Output	600V/12A - 3 ϕ , 60 Hz
Dimensions and Weight:	
Depth	23.1" (590 mm)
Width	15.25" (390 mm)
Height	27.7" (700 mm)
Weight	128 pounds (58 kg)
Gas Type	Air or Nitrogen
Gas Quality, Air	Clean, dry, oil-free
Gas Quality, Nitrogen	99.995% pure
Gas Inlet Pressure	90 psi (6.2 bar)
Gas Flow	360 scfh/6 scfm at 90 psi (170 l/min at 6.2 bar) supplied to power supply pressure regulator
Power Supply pressure regulator setting	70 psi (4.8 bar) flowing

Section 2 600V INSTALLATION

In this section:

Installation	2-2
Installation of Wheels and Casters to Transformer Case	2-4
Wheel Installation	2-4
Caster Installation	2-4
Attaching Power Supply Bracket to Powermax900 Chassis	2-6
Attaching 600V Transformer Case Assembly to Powermax900 Chassis	2-8
Switching Voltage Configuration to 480V	2-9
Hooking Up the Three-Phase Transformer Secondary Power Cord from 600V Transformer Case Assembly to Powermax900	2-10
Choosing Plug, Power Cord and Line Disconnect Box Fuse	2-11
Power Cord Plug	2-11
Power Cord - 600V	2-11
Line Voltage Disconnect Box and Fuses	2-11

600V INSTALLATION



WARNING



INSTALLATION MUST BE PERFORMED ONLY BY HYPERTHERM DISTRIBUTORS OR QUALIFIED ELECTRONICS TECHNICIANS!!

SHOCK HAZARD: Always turn off power, unplug cord from wall and wait 5 minutes before removing any cover of the power supply! If power unit is directly connected to a line disconnect box, place line disconnect switch to OFF position. Lock out and tag out switch before proceeding!

See **Section 3** for a parts list of the 128312 Powermax 600V conversion kit.

Note: All graphics and text in this document refer to the Powermax900. Unless otherwise noted, all instructions apply to either the Powermax800 or Powermax900.

INSTALLATION

The installation of the 600V kit to the 208/240/480V Powermax900 involves 6 basic steps:

1. Installation of wheels and casters to the transformer case.
2. Attaching the 600V power supply bracket to the Powermax900 chassis.
3. Attaching the 600V case assembly to the Powermax900 chassis.
4. Switching the power supply voltage configuration to 480V.
5. Hooking up the three-phase transformer secondary power cord from the 600V transformer case assembly to the Powermax900.
6. Choosing the plug, power cord and line disconnect box fuse.



WARNING



THE 208/240/480V POWERMAX900 POWER SUPPLY IS SET UP TO OPERATE AT 240V WITH A SINGLE-PHASE INPUT. WHEN CONVERTED TO A 600V POWER SUPPLY, THE VOLTAGE CONFIGURATION IN THE POWER SUPPLY MUST BE SWITCHED TO 480V, AND THE POWER CORD MUST BE HOOKED UP FOR THREE-PHASE OPERATION. See pages 2-9 to 2-10.

600V INSTALLATION

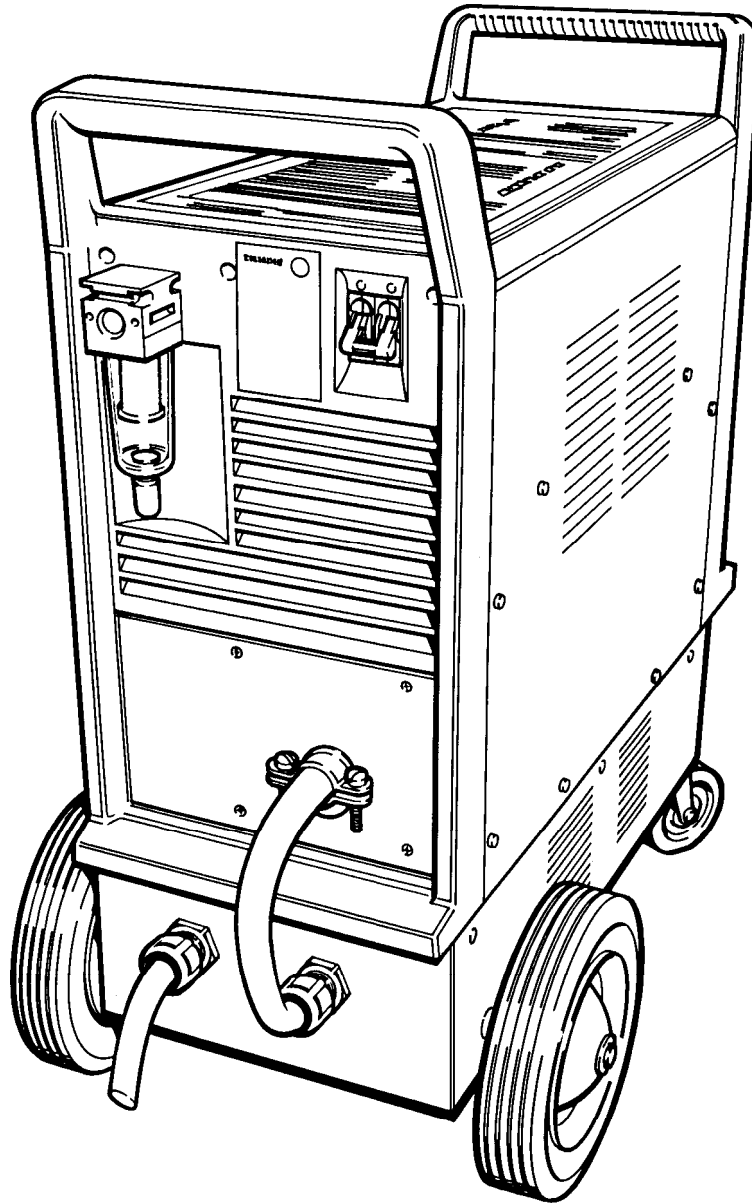

Figure 2-1 Powermax900 600V Power Supply Assembled

600V INSTALLATION

INSTALLATION OF WHEELS AND CASTERS TO TRANSFORMER CASE

Wheel Installation

1. Carefully turn transformer case assembly upside down.
2. Snap an 027249 retaining ring on one end of the 004672 wheel axle.
3. Slide one 027057 wheel on the axle.
4. Slide 008973 shoulder washer over the end of the axle with the larger diameter end of the washer facing the mounted wheel.
5. Slide the axle through both holes in the rear of the transformer case assembly.
6. Slide the second 008973 shoulder washer over the end of the axle with the smaller diameter end of the washer facing the transformer case.
7. Slide the second 027057 wheel onto the axle.
8. Snap the second 027249 retaining ring on the end of the axle to secure the second wheel.

Caster Installation

1. Attach the 027299 casters to the case with the 075470 10-32 screws and 075174 star washers as shown in Figure 2-2.
2. Turn transformer case back over on to wheels - Figure 2-3.

Wheel and caster installation complete.

600V INSTALLATION

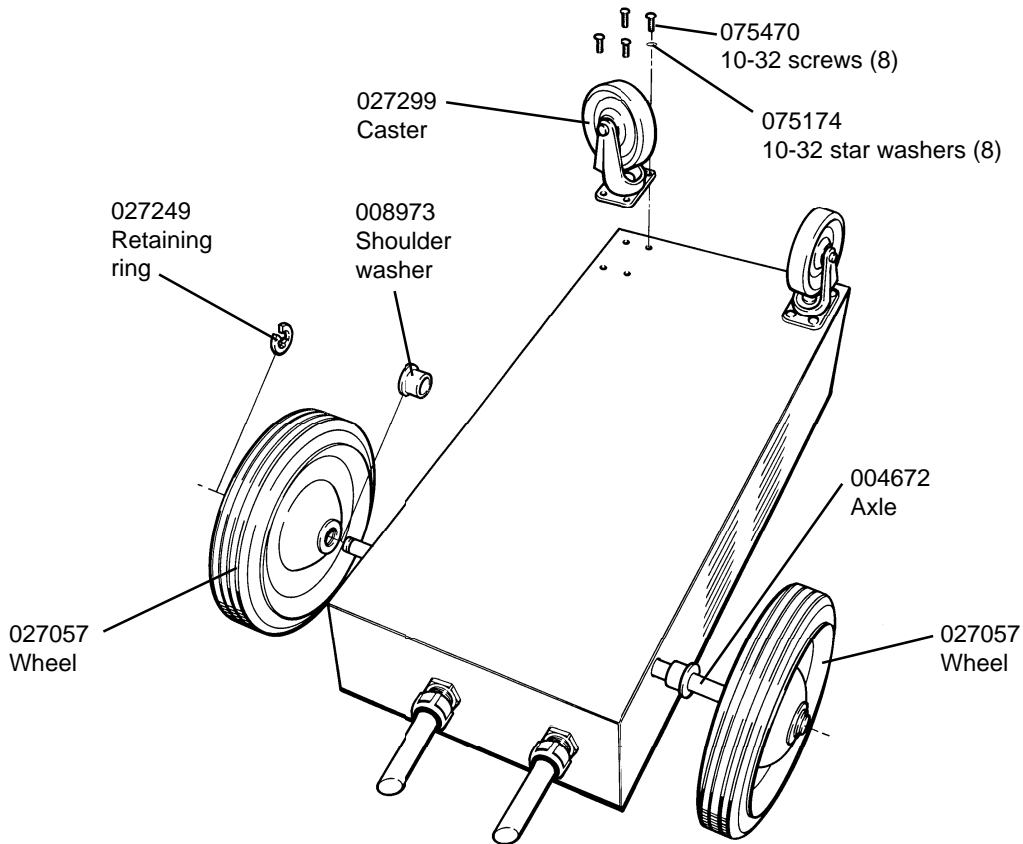

Figure 2-2 Wheel and Caster Installation

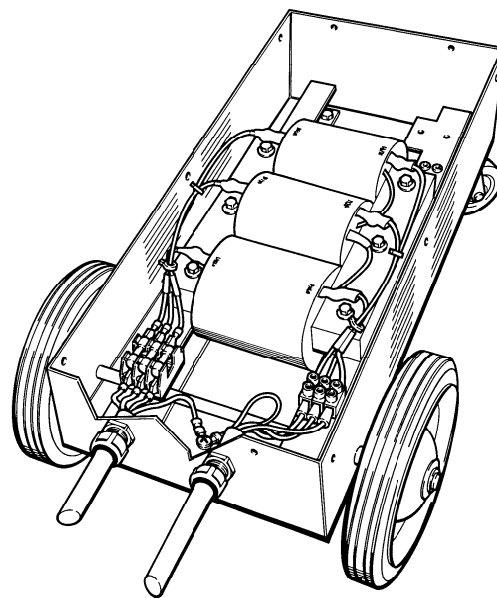



Figure 2-3 Wheels and Casters Installed on 600V Transformer Case

600V INSTALLATION

ATTACHING POWER SUPPLY BRACKET TO POWERMAX900 CHASSIS.

1. If torch is connected to power supply, disconnect it.



WARNING



INSTALLATION MUST BE PERFORMED ONLY BY HYPERTHERM DISTRIBUTORS OR QUALIFIED ELECTRONICS TECHNICIANS!!

SHOCK HAZARD: Always turn off power, unplug cord from wall and wait 5 minutes before removing any cover of the power supply! If power unit is directly connected to a line disconnect box, place line disconnect switch to OFF position and remove power cord from line disconnect box.

2. Remove power cord from line disconnect box or from receptacle.
3. Remove power cord from power supply. See Figure 2-4.
 - 3.1. Loosen the 2 screws on the power cord strain relief.
 - 3.2. Remove the screws securing the line cord rear panel.
 - 3.3. Slide rear panel down on power cord to expose link box.
 - 3.4. Disconnect power cord from link box.
 - 3.5. Remove power cord from rear panel.

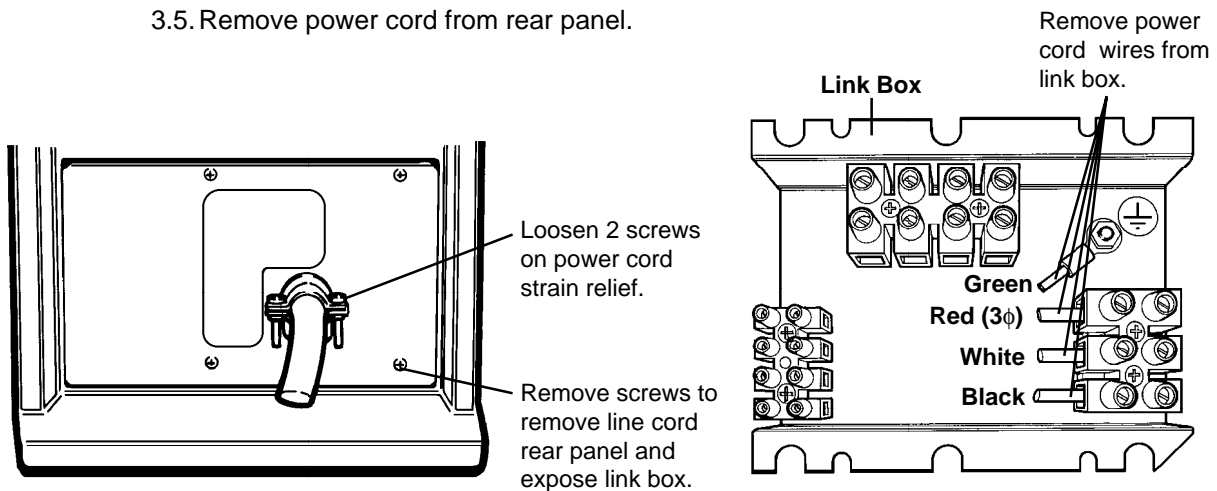

Figure 2-4 Removal of Power Cord from Powermax900 Power Supply

600V INSTALLATION

4. Remove the power supply cover (Powermax900 only).
5. Carefully tilt Powermax over onto its front handle as shown in Figure 2-5.
6. Place the 001568 power supply bracket against the bottom of the power supply as shown in Figure 2-5 and fasten with the 075470 10-32 screws, 075174 star washers and 075160 kepnuts in 12 locations.

Note: The Powermax800 chassis does not require the 075160 kepnuts.

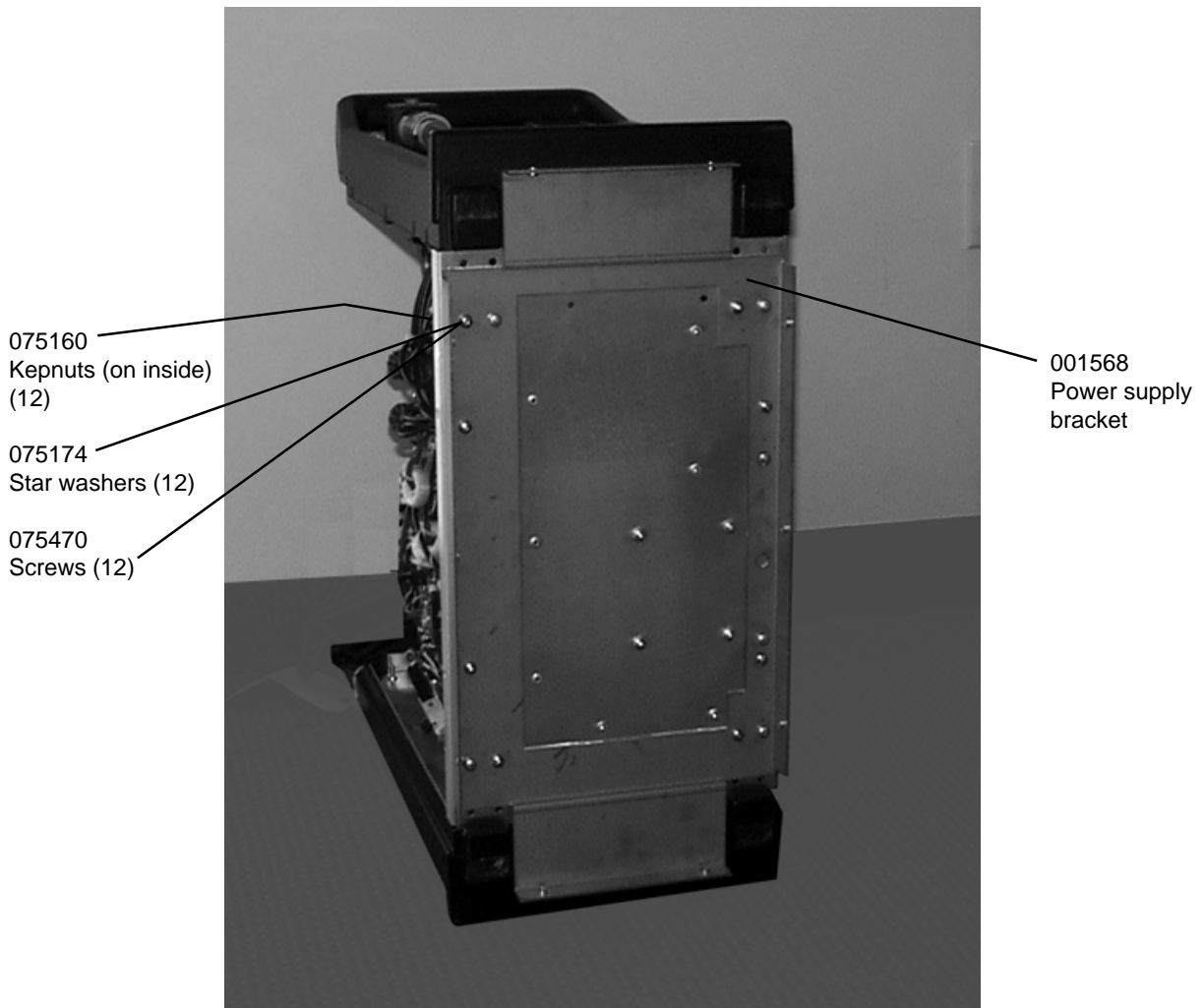

Figure 2-5 Attaching 600V Power Supply Bracket to Powermax Chassis

600V INSTALLATION

ATTACHING 600V TRANSFORMER CASE ASSEMBLY TO POWERMAX900 CHASSIS

1. Replace the power supply cover.
2. Lift Powermax over transformer case assembly with the rear of the power supply lined up over the power cord side of the transformer case.
3. Carefully set down the Powermax onto the transformer case assembly.
4. Fasten the Powermax to the transformer case assembly by screwing in the 075467 8-32 screws in 10 locations.
5. Thread the transformer secondary power cord (shorter cord) through the strain relief of the line cord rear panel.

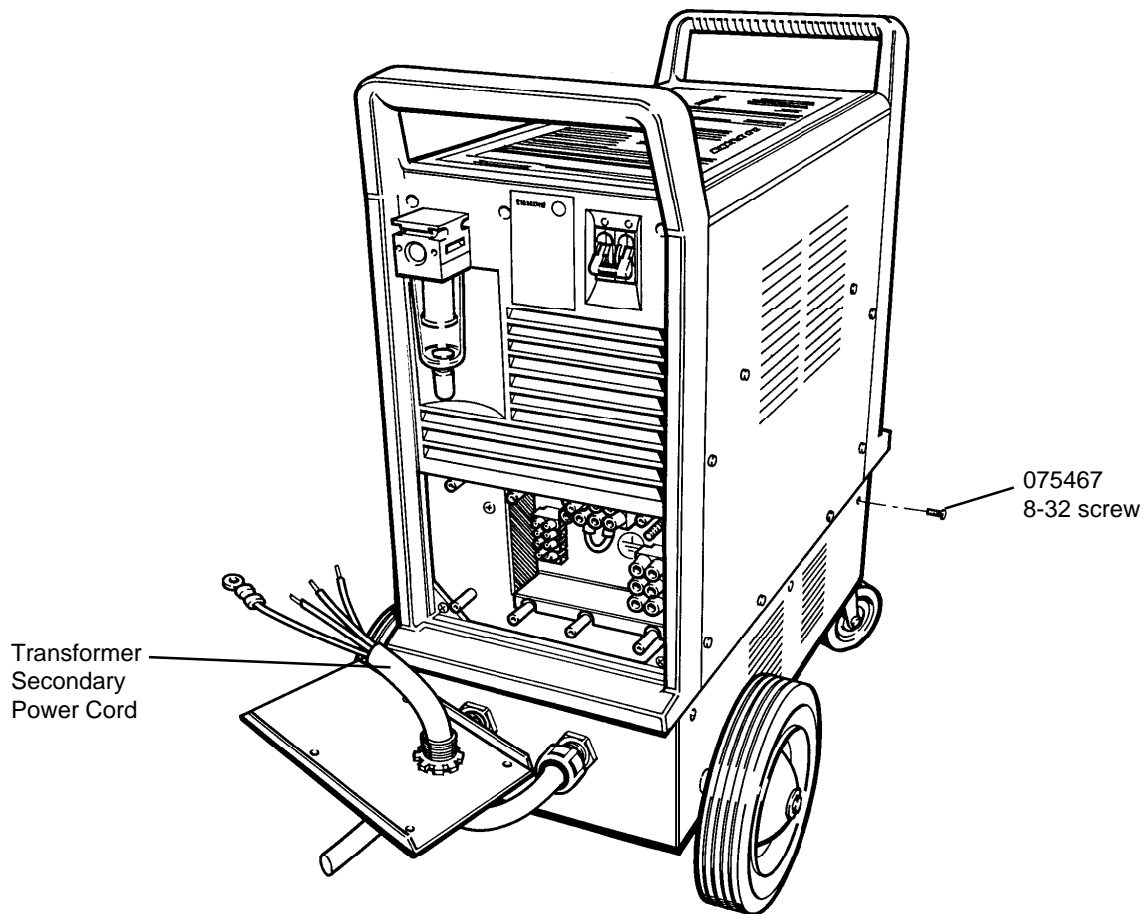

Figure 2-6 Attaching 600V Transformer Case Assembly to Powermax900 Chassis

600V INSTALLATION

SWITCHING VOLTAGE CONFIGURATION TO 480V

1. Configure TB2 by moving the voltage link wire (Black) to the position shown in Figure 2-7.

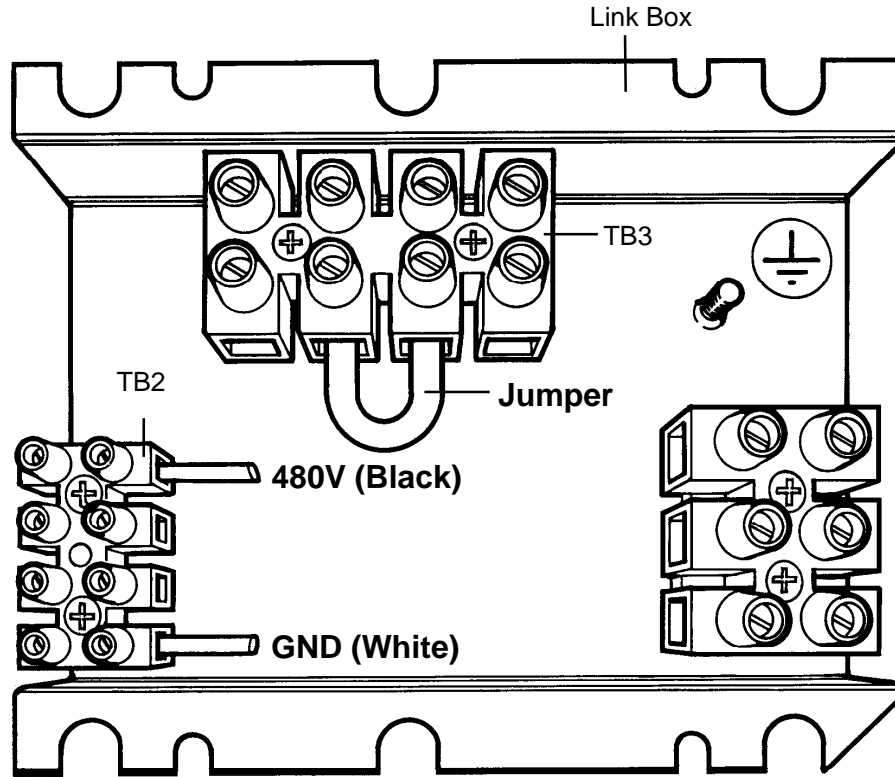

Figure 2-7 Switching Voltage Configuration to 480V

2. Configure TB3 with one jumper linked in the position shown in Figure 2-7.
3. Secure unused link jumper in the clip located in the link box,

600V INSTALLATION

HOOKING UP THE THREE-PHASE TRANSFORMER SECONDARY POWER CORD FROM 600V TRANSFORMER CASE ASSEMBLY TO POWERMAX900

1. Connect L1 (Black), L2 (White) and L3 (Red) of the three-phase transformer secondary power cord to TB1 of the link box as shown in Figure 2-8.
2. Connect the ground (Green) wire to the stud marked \oplus above the terminal block .

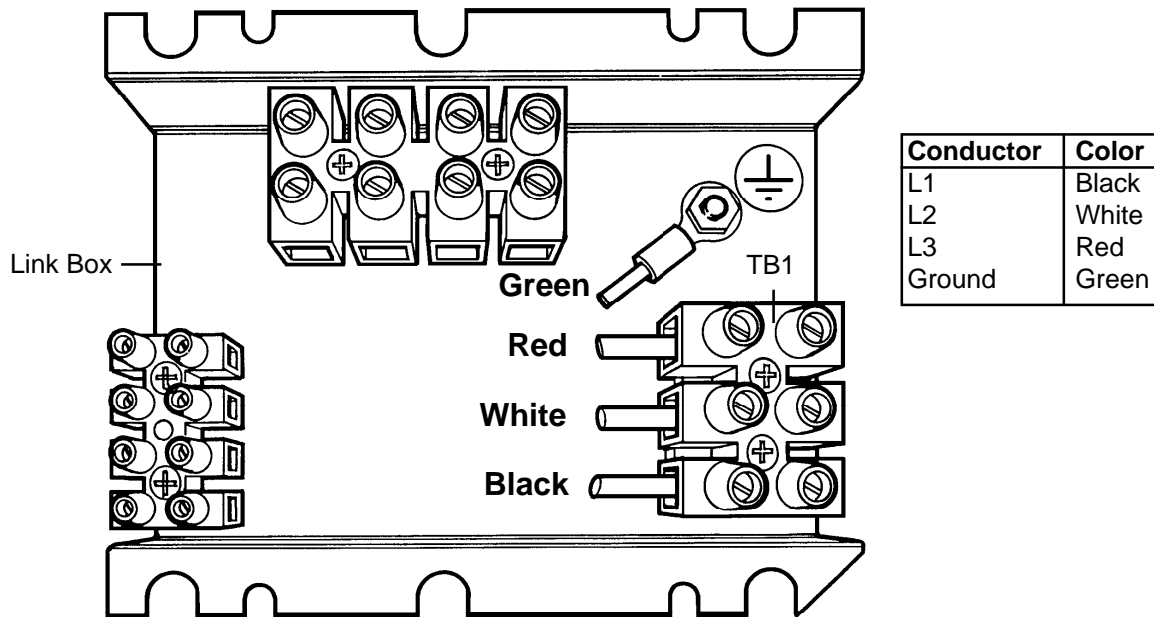

Figure 2-8 Connecting the Transformer Secondary Power Cord from 600V Transformer Case to Powermax900

3. Connect the rear panel to the Powermax900 power supply and secure with screws.
4. Tighten the strain relief screws around the power cord. Be certain that the strain relief grips the outer insulation of the power cord and not the individual wires. See completed assembly in Figure 2-1.



WARNING



BE CERTAIN THAT WIRES ARE CONNECTED EXACTLY AS SHOWN ABOVE. AS A PRECAUTION, CHECK CONTINUITY FROM POWER SUPPLY ENCLOSURE TO INCOMING GROUND WIRE BEFORE CONNECTING TO POWER.

600V INSTALLATION

CHOOSING PLUG, POWER CORD AND LINE DISCONNECT BOX FUSE

Power Cord Plug

The 600V Powermax900 kit is shipped with a three-phase power cord and no plug. The user must obtain a plug that is certified by national or local electrical codes. The plug should be connected to the power cord by a licensed electrician.

Power Cord - 600V

If the three-phase power cord length needs to be changed, use the table below to choose the proper gauge size for the appropriate length. Use a 4-conductor SO type cord for three-phase power supplies. The cord should be installed only by a licensed electrician.

Input Voltage	Input Current	Recommended Power Cord Gauge Size (AWG)				
		to 10 ft	10 – 25 ft	25 – 50 ft	50 – 100 ft	100 –150 ft
600 VAC	8 amps	12	12	12	12	10

Line Voltage Disconnect Box and Fuse

Use a line disconnect box for each power supply. This disconnect box allows the operator to turn the power supply off quickly in an emergency situation. The switch should be located on a wall near the power supply, and should be easily accessible to the operator. The interrupt level of the switch must be equal to or exceed the continuous rating of the fuses. Use slow-blow fuses according to the power requirements listed below.

<u>Input Voltage</u>	<u>Phase</u>	<u>Input Current @ 6.6 kw Output</u>	<u>Recommended Slow-Blow Fuse Size</u>
600 VAC	3	12 amps	20 amp

The 600Volt conversion is now complete. See the Powermax Operator Manual for further instructions to setup, operate and maintain the Powermax system.

600V INSTALLATION

Section 3 PARTS LIST

In this section:

Powermax900 600 Volt Conversion Kit - 128312.....	3-2
---	-----

PARTS LIST

POWERMAX900 600 VOLT CONVERSION KIT - 128312

Index No.	Part No.	Description	Quantity
1	001568	Panel:Powermax800 600V	1
2	004672	Axle:Powermax800 Power Unit	1
3	008973	Shoulder Washer:1/2" X 27/64 Nylon	2
4	027057	Wheel:8" X 1.75"	2
5	027249	Retaining Ring:1/2" Shaft Extension	2
6	027299	Caster:MAX70 Swivel	2
7	075467	M/S:8-32 X 3/8 Phillips Head Round SSB	10
8	075470	M/S:10-32 X 3/4 Phillips Head Pan	20
9	075174	Lockwasher :#10 Internal	20
	075160	Keypnut:10-32 S/Z	12
	129364	Powermax900 600V Conversion SA	1
10	001672	Cover:Powermax900 600V	1
11	001570	Bracket:Powermax800 600V	2
12	008752	Fuseblock:3Position 30A600V 13/32X1-1/2	1
13	008949	Terminal board:3-Terminal	1
14	008962	Fuse:20A 600V .406X1.5 Slow	3
15	008963	Strain relief:3/4" X .625-.750	2
16	014235	Transformer:Powermax900 600V Input	1
17	123060	Cable:Powermax800 600V Conv. Fuses	1
18	123061	Cable:Powermax800 600V Conv. Term. Block	1

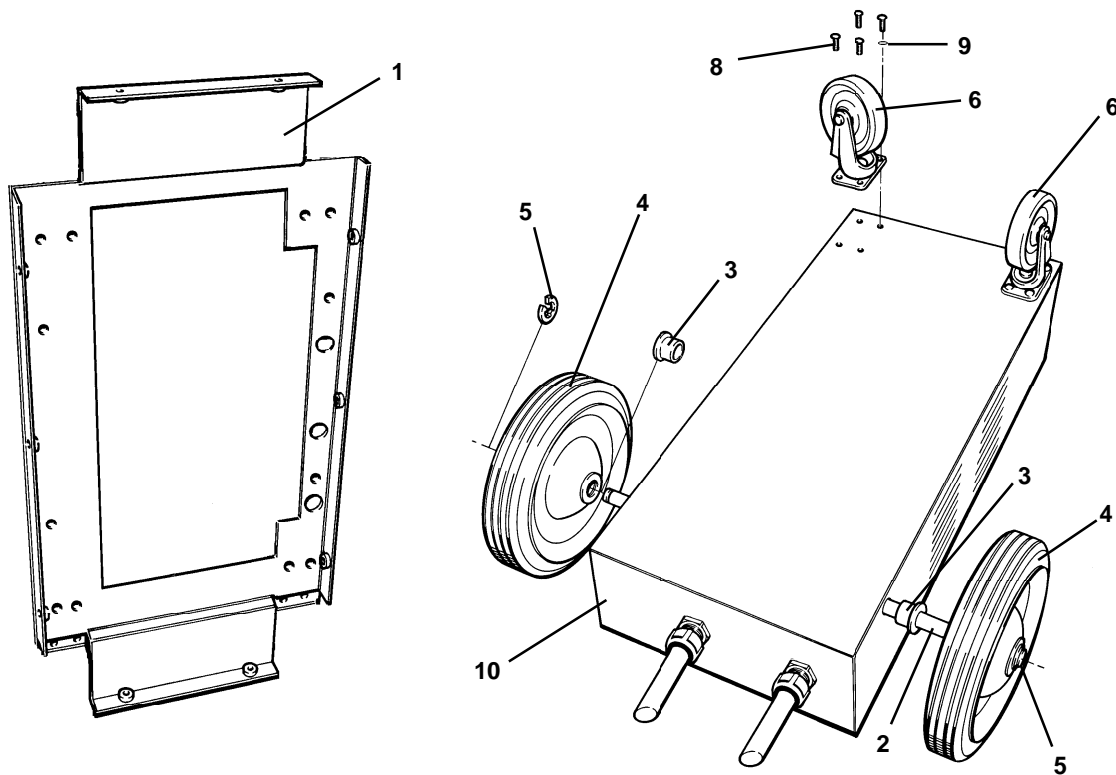

Figure 3-1 Powermax900 600V Panel, Wheels and Casters

PARTS LIST

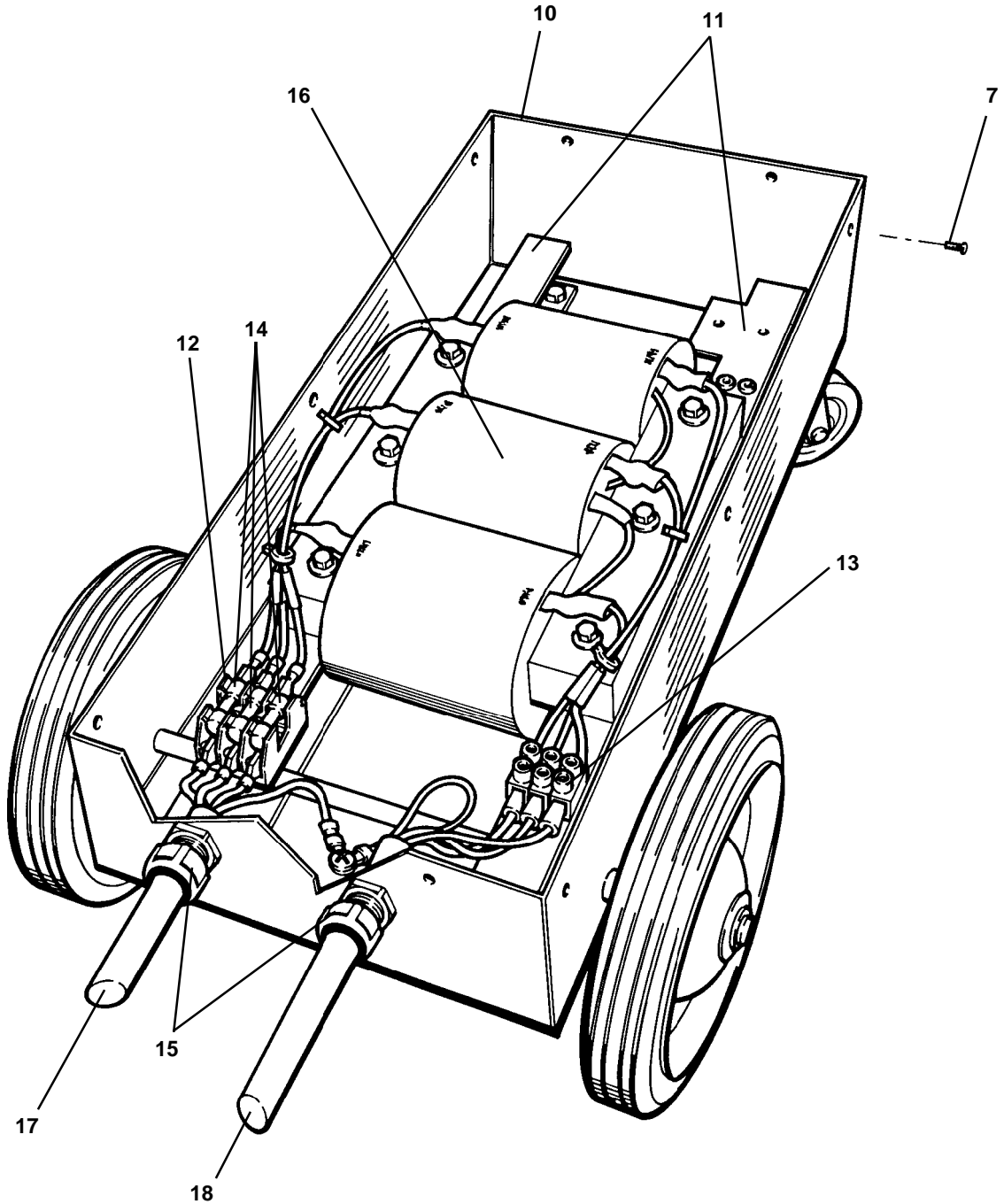
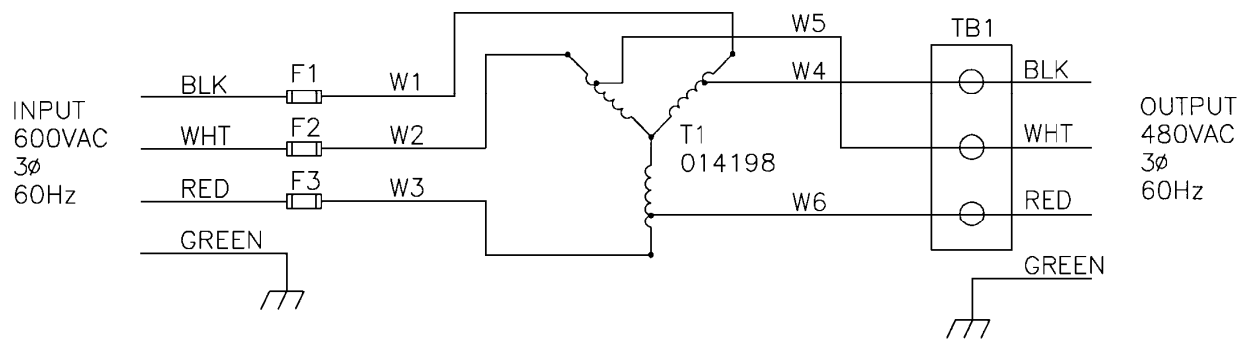

Figure 3-2 Powermax900 600V Conversion Subassembly - 129364



Wiring Diagram: Powermax900 600V Transformer - 014235