

# *HySpeed HT2000<sup>®</sup>*

## *Plasma Arc Cutting System*

*Product Configuration Manual  
801790 – Revision 7*

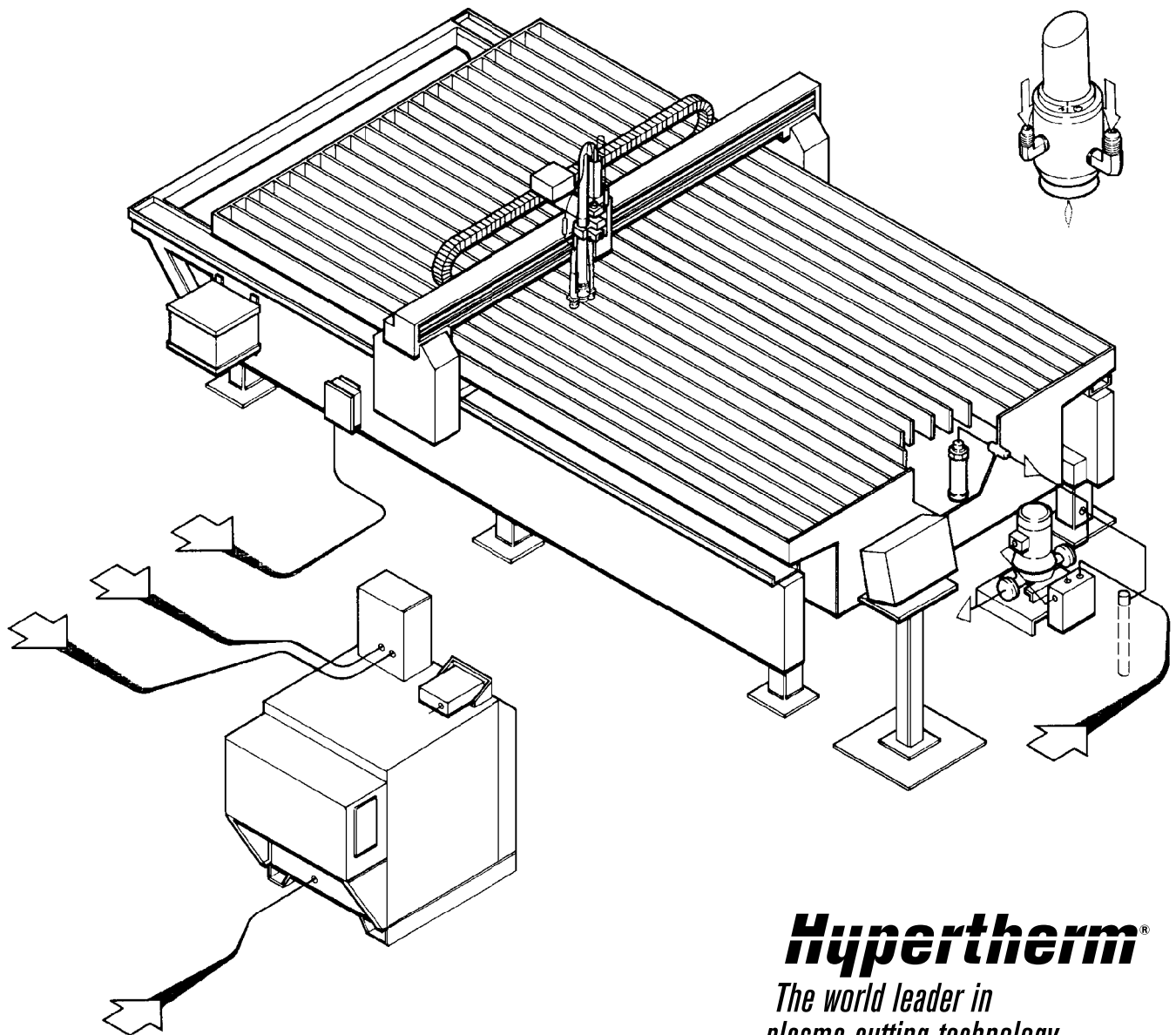

**Hypertherm<sup>®</sup>**  
*The world leader in  
plasma cutting technology*

# *HySpeed HT2000*

## **Product Configuration Manual**

**(P/N 801790)**

**Revision 7 – March, 2003**

**Hypertherm, Inc.  
Hanover, NH USA**

**[www.hypertherm.com](http://www.hypertherm.com)**

© Copyright 2003 Hypertherm, Inc.  
All Rights Reserved

Hypertherm, HT, LongLife, and HySpeed are trademarks of Hypertherm, Inc.  
and may be registered in the United States and/or other countries

**Hypertherm, Inc.**

Etna Road, P.O. Box 5010  
Hanover, NH 03755 USA  
603-643-3441 Tel (Main Office)  
603-643-5352 Fax (All Departments)  
**800-643-9878 Tel (Technical Service)**  
800-737-2978 Tel (Customer Service)

**Hypertherm Automation, LLC**

5 Technology Drive  
West Lebanon, NH 03755 USA  
603-298-7970 Tel  
603-298-7977 Fax

**Hypertherm Plasmatechnik, GmbH**

Technologiepark Hanau  
Rodenbacher Chaussee 6  
63457 Hanau-Wolfgang, Deutschland  
49 6181 58 2100 Tel  
49 6181 58 2134 Fax  
**49 6181 58 2123 (Technical Service)**

**Hypertherm (S) Pte Ltd**

No. 19 Kaki Bukit Road 2  
K.B. Warehouse Complex  
Singapore 417847, Republic of Singapore  
65 6 841 2489 Tel  
65 6 841 2490 Fax  
**65 6 841 2489 (Technical Service)**

**Japan**

1952-14 Yata-Natsumegi  
Mishima City, Shizuoka Pref.  
411-0801 Japan  
81 0 559 75 7387 Tel  
81 0 559 75 7376 Fax

**Hypertherm UK, Ltd**

9 Berkeley Court, Manor Park  
Runcorn, Cheshire, England WA7 1TQ  
44 1928 579 074 Tel  
44 1928 579 604 Fax

**France**

15 Impasse des Rosiers  
95610 Eragny, France  
00 800 3324 9737 Tel  
00 800 4973 7329 Fax

**Hypertherm S.r.l.**

Via Torino 2  
20123 Milano, Italia  
39 02 725 46 312 Tel  
39 02 725 46 400 Fax  
**39 02 725 46 314 (Technical Service)**

**Hypertherm Europe B.V.**

Vaartveld 9  
4704 SE Roosendaal, Nederland  
31 165 596908 Tel  
31 165 596901 Fax

**Technical Service:**

**00 800 49 73 7843 – toll-free in Europe**  
31 165 596900 Tel

**Hypertherm Brasil Ltda.**

Rua Visconde de Santa Isabel, 20 – Sala 611  
Vila Isabel, RJ  
Brasil CEP 20560-120  
55 21 2278 6162 Tel  
55 21 2578 0947 Fax

<b>Section 1 SPECIFICATIONS</b> .....	<b>1-1</b>
System Specifications and Dimensions – Required Equipment .....	1-2
System Requirements .....	1-2
1 Power Supply .....	1-2
2 Torch Assembly .....	1-2
3 Remote High Frequency Console .....	1-3
4 Leads Between Power Supply and RHF Console.....	1-3
5 Shielded Leads Between Torch and RHF Console.....	1-4
6 Gas Console .....	1-4
7 Motor Valve Console .....	1-5
8 Leads Between Gas Console and Motor Valve Console .....	1-5
9 Shield Gas Hose Set Between Gas Console and RHF Console .....	1-5
10 Cable Between Gas Console and Power Supply .....	1-6
11 Cable Between Motor Valve Console and Power Supply .....	1-6
12 Current Remote (CR) Control .....	1-6
12 Digital Remote (DR) V/C Control .....	1-7
12 Programmable Remote (PR) V/C Control .....	1-7
13 Cable Between 1X7 PS Connector and Dig., Progr. or Curr. Remote .....	1-8
14 Cable Between 1X8 PS Connector and Progr. Remote.....	1-8
15 Cable Between PS and Machine Computer Interface.....	1-8
16 Cable Between PS and Work Table.....	1-8
System Specifications and Dimensions – Optional and Additional Equipment .....	1-9
17 Hold Cable Between Power Supplies in Multi-Torch Systems.....	1-9
18 Inductive IHS System.....	1-9
18a Inductive IHS Air Regulator Mounting Bracket.....	1-10
19 Inductive IHS Lead Set .....	1-10
20 Timer/Counter .....	1-10
20a Timer/Counter Cable .....	1-10
21 Water Muffler System – Pump .....	1-11
22 Cable Between Water Muffler Pump and Power Supply.....	1-11
23 Hosing Between Supply Gases and Gas Console.....	1-11
24 Argon/Hydrogen Console.....	1-12
25 Cable Between Argon/Hydrogen Console and Power Supply .....	1-12
26 Hose Between Argon/Hydrogen Console and Torch .....	1-12
Quick Reference to Cable / Hose Dimensions .....	1-13
<b>Section 2 ORDERING PROCEDURE</b> .....	<b>2-1</b>
Introduction .....	2-2
Multi-Torch Systems .....	2-3
Layout of Cutting Machine and System .....	2-4
Ordering Information.....	2-5
Ordering Procedure – Required Equipment .....	2-6
1 Power Supply .....	2-6
2 Torch Assembly .....	2-6

## TABLE OF CONTENTS

---

3	Remote High Frequency (RHF) Console .....	2-6
4	Leads Between the Power Supply and the Remote High Frequency Console .....	2-8
5	Shielded Leads Between the Torch and the Remote High Frequency Console .....	2-8
6	Gas Console .....	2-8
7	Motor Valve Console .....	2-10
8	Leads Between the Gas Console and the Motor Valve Console .....	2-10
9	Shield Hose Set Between the Gas Console and the Remote High Frequency Console .....	2-10
10	Cable Between the Gas Console and the Power Supply .....	2-10
11	Cable Between the Motor Valve Console and the Power Supply .....	2-12
12	Remote Voltage/Current (V/C) Control .....	2-12
13	Cable Between the Power Supply and the Digital V/C or Current Remote .....	2-14
14	Cable Between the Power Supply and the Programmable Remote .....	2-14
15	Interface Cables Between the Power Supply and the Machine Computer Interface .....	2-14
16	Cable Between the Power Supply and the Work Table .....	2-14
	Ordering Procedure – Optional and Additional Equipment .....	2-16
17	Hold Cable .....	2-16
18	Inductive Initial Height Sensing (IHS) System .....	2-16
18a	IHS Pressure Regulator Assembly .....	2-16
19	Inductive IHS Lead Set .....	2-16
20	Timer/Counter .....	2-18
20a	Timer/Counter Cable .....	2-18
21	Water Muffler (WM) System .....	2-18
22	WM Cable Between the WM Pump and Power Supply .....	2-18
23	Hosing Between Gas Supplies and Gas Console .....	2-18
24	Argon/Hydrogen Console .....	2-20
25	Cable Between the Argon/Hydrogen Console and the Power Supply .....	2-20
26	Hose Between the Argon/Hydrogen Console and the Torch .....	2-20
	Spare Parts Kit .....	2-20

*In this section:*

System Specifications and Dimensions – Required Equipment .....	1-2
System Requirements .....	1-2
1 Power Supply .....	1-2
2 Torch Assembly .....	1-2
3 Remote High Frequency Console .....	1-3
4 Leads Between Power Supply and RHF Console .....	1-3
5 Shielded Leads Between Torch and RHF Console .....	1-4
6 Gas Console .....	1-4
7 Motor Valve Console .....	1-5
8 Leads Between Gas Console and Motor Valve Console .....	1-5
9 Shield Gas Hose Set Between Gas Console and RHF Console .....	1-5
10 Cable Between Gas Console and Power Supply .....	1-6
11 Cable Between Motor Valve Console and Power Supply .....	1-6
12 Current Remote (CR) Control .....	1-6
12 Digital Remote (DR) V/C Control .....	1-7
12 Programmable Remote (PR) V/C Control .....	1-7
13 Cable Between 1X7 PS Connector and Dig., Progr. or Curr. Remote .....	1-8
14 Cable Between 1X8 PS Connector and Progr. Remote .....	1-8
15 Cable Between PS and Machine Computer Interface .....	1-8
16 Cable Between PS and Work Table .....	1-8
System Specifications and Dimensions – Optional and Additional Equipment .....	1-9
17 Hold Cable Between Power Supplies in Multi-Torch Systems .....	1-9
18 Inductive IHS System .....	1-9
18a Inductive IHS Air Regulator Mounting Bracket .....	1-10
19 Inductive IHS Lead Set .....	1-10
20 Timer/Counter .....	1-10
20a Timer/Counter Cable .....	1-10
21 Water Muffler System – Pump .....	1-11
22 Cable Between Water Muffler Pump and Power Supply .....	1-11
23 Hosing Between Supply Gases and Gas Console .....	1-11
24 Argon/Hydrogen Console .....	1-12
25 Cable Between Argon/Hydrogen Console and Power Supply .....	1-12
26 Hose Between Argon/Hydrogen Console and Torch .....	1-12
Quick Reference to Cable / Hose Dimensions .....	1-13

## System Specifications and Dimensions – Required Equipment

### System Requirements

#### Power Requirements:

Refer to power supply specifications below:

#### Gas Requirements:

Plasma Gas Types .....	Oxygen (O <sub>2</sub> ), Nitrogen (N <sub>2</sub> ), Air, Argon/Hydrogen (H35 = 35% Hydrogen/65% Argon)
Shield Gas Types .....	Air, Nitrogen (N <sub>2</sub> ), Carbon Dioxide (CO <sub>2</sub> )
Gas Quality	
Oxygen .....	99.5% pure (liquid gas recommended)
Nitrogen .....	99.995% pure (liquid gas recommended)
Air .....	Clean, dry, oil-free
Carbon Dioxide .....	99.5% pure (liquid gas recommended)

#### Plasma Gas Inlet Pressures and Flowrates

Air .....	90 psi (6.2 bar) at 82 scfh (2322 l/h)
Oxygen .....	120 psi (8.3 bar) at 90 scfh (2549 l/h)
Nitrogen .....	120 psi (8.3 bar) at 80 scfh (2265 l/h)
Argon/Hydrogen .....	120 psi (8.3 bar) at 105 scfh (2973 l/h)

#### Shield Gas Inlet Pressures and Flowrates

Air .....	90 psi (6.2 bar) at 280 scfh (7929 l/h)
Carbon Dioxide .....	90 psi (6.2 bar) at 220 scfh (6230 l/h)
Nitrogen .....	90 psi (6.2 bar) at 275 scfh (7787 l/h)

### ① Power Supply

#### Dimensions and Weight

Width .....	28-1/4" (71 cm)
Height .....	35-1/2" (90 cm)
Depth .....	41-1/4" (104 cm)
Weight .....	780 pounds (351 kg)

### ② Torch Assembly

#### Dimensions and Weight:

Length with sleeve: .....	17-3/4" (45 cm)
Sleeve Diameter .....	2" (50 mm) std&stnlss.; 1-3/4" (44 mm) optional torch
Weight .....	2-1/2 pounds (1.13 kg)

Lead	Lead Diameter (O.D.)	Connector/Lug Diameter
Off valve Plasma Hose	3/8" (9.5 mm)	3/8" (9.5 mm)
Off valve Control Cable	1/4" (6 mm)	3/4" (19 mm)

③ Remote High Frequency Console

**Dimensions and Weight:**

Width .....	16" (40.6 cm)
Height .....	16-3/4" (42 cm)
Depth .....	12-3/4" (32 cm)
Weight .....	75 pounds (34 kg)

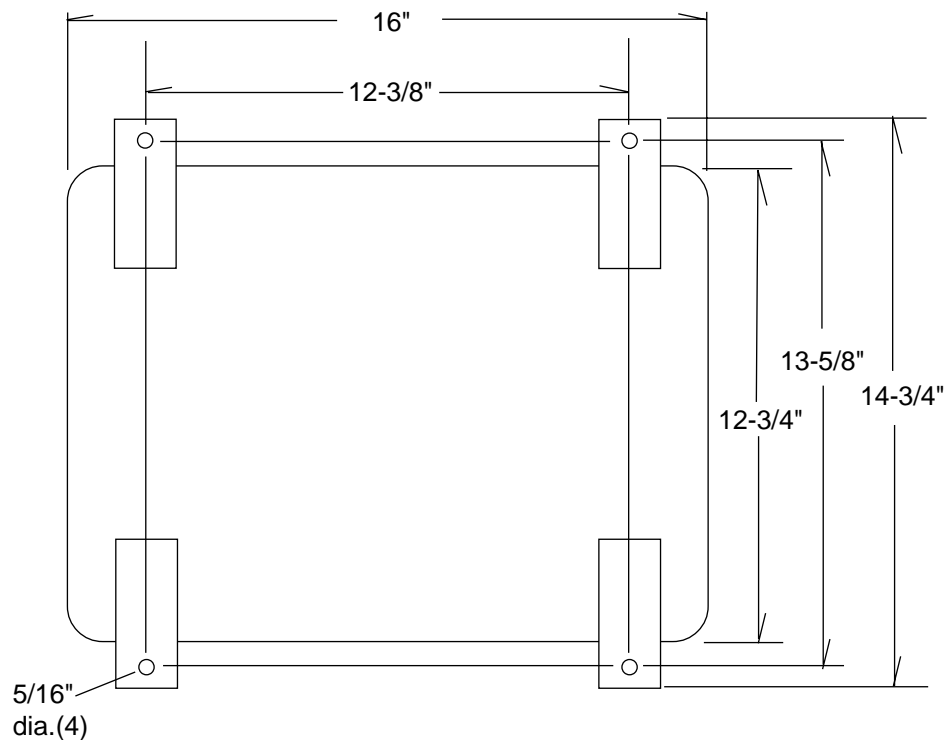

Figure 1-1 RHF Console Mounting Dimensions

④ Leads Between Power Supply and RHF Console

Lead	Lead Diameter (O.D.)	Connector/Lug Diameter
RHF Cons Control Cable	3/8" (9.5 mm)	1-3/8" (35 mm)
Negative Cable	3/4" (19 mm)	1" (25 mm)
Pilot Arc (PA) Cable	1/4" (6.5 mm)	1/2" (13 mm)
Cooling Hose	5/8" (16 mm)	5/8" (16 mm)
Cooling Hose	5/8" (16 mm)	5/8" (16 mm)



## SPECIFICATIONS

---

### ⑤ Shielded Leads Between Torch and RHF Console

Lead	Lead Package Diameter (O.D.)
Shld Trch Leads	1-1/2" (38 mm)

### ⑥ Gas Console

#### Dimensions and Weight:

Width .....	11-1/2 " (29 cm)
Height .....	14-5/8 " (37 cm)
Depth .....	4 " (10 cm)
Weight .....	23 pounds (10.4 kg)

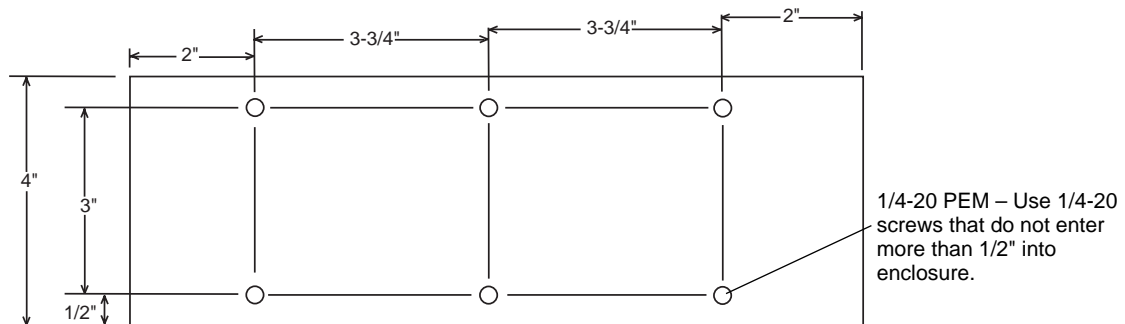
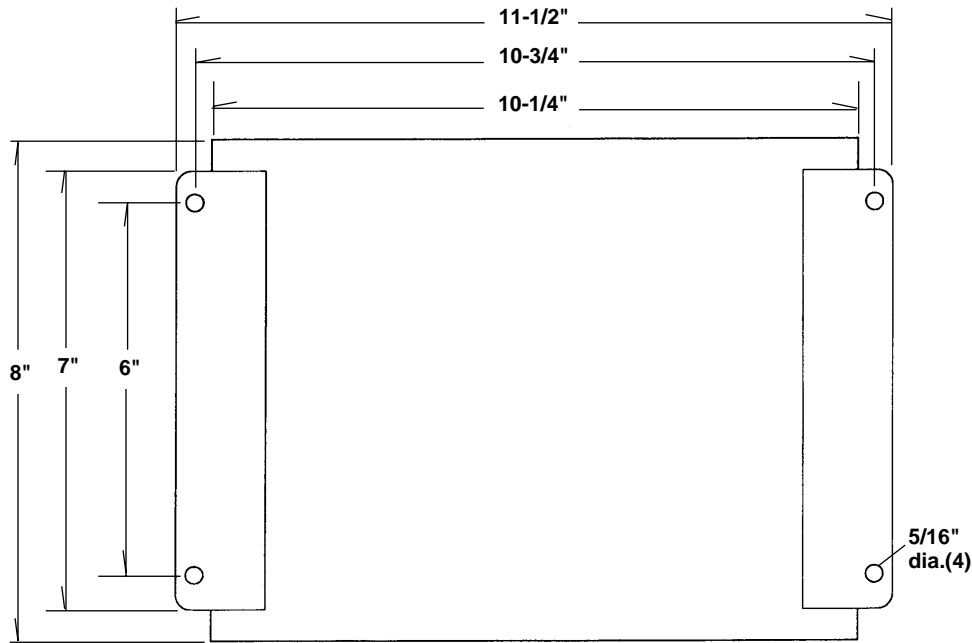

Figure 1-2 Gas Console Mounting Dimensions:

⑦ **Motor Valve Console**

**Dimensions and Weight:**

Width .....11-1/2 " (29 cm)  
 Height.....4 1/4" (11 cm)  
 Depth.....8" (20 cm)  
 Weight.....18 pounds (8.2 kg)



**Figure 1-3 Motor Valve Console Mounting Dimensions**

⑧ **Leads Between Gas Console and Motor Valve Console**

Lead	Lead Diameter (O.D.)	Connector/Lug Diameter
Preflow Gas Hose	1/2" (13 mm)	1/2" (13 mm)
Cutflow Gas Hose	1/2" (13 mm)	1/2" (13 mm)

⑨ **Shield Gas Hose Set Between Gas Console and RHF Console**

Hose	Hose Diameter (O.D.)	Connector/Lug Diameter
Gas Csl/RHF Csl Hose	5/8" (16 mm)	5/8" (16 mm)
Gas Csl/RHF Csl Hose	5/8" (16 mm)	5/8" (16 mm)

## SPECIFICATIONS

---

### ⑩ Cable Between Gas Console and Power Supply

**Cable**  
Gas Cons/PS Cable

**Cable Diameter (O.D.)**  
1/2" (13 mm)

**Connector/Lug Diameter**  
1-3/4" (44 mm)

### ⑪ Cable Between Motor Valve Console and Power Supply

**Cable**  
Mtr Vlv Cons/PS Cable

**Cable Diameter (O.D.)**  
1/2" (13 mm)

**Connector/Lug Diameter**  
1-3/4" (44 mm)

### ⑫ Current Remote (CR) Control

**Dimensions and Weight:**

Width .....6-1/2" (16.5 cm)  
 Height.....2-1/2" (6.2 cm)  
 Depth.....8-1/2" (21.6 cm)  
 Weight .....3 pounds (1.4 kg)

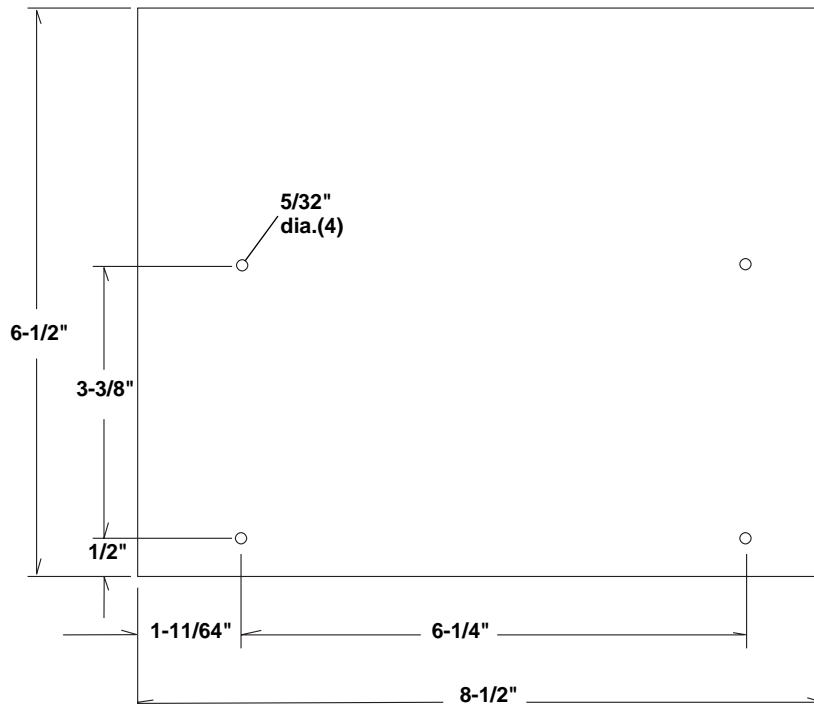

**Figure 1-4A Current Remote Control Mounting Dimensions**

⑫ Digital Remote (DR) V/C Control

**Dimensions and Weight:**

Width .....	11-1/2" (29 cm)
Height .....	3" (7.6 cm)
Depth .....	13-3/8" (34 cm)
Weight .....	5 pounds-5 oz. (2.4 kg)

⑬ Programmable Remote (PR) V/C Control

**Dimensions and Weight:**

Width .....	11-1/2" (29 cm)
Height .....	3" (7.6 cm)
Depth .....	12-1/2" (31.8 cm)
Weight .....	5 pounds-5 oz. (2.4 kg)

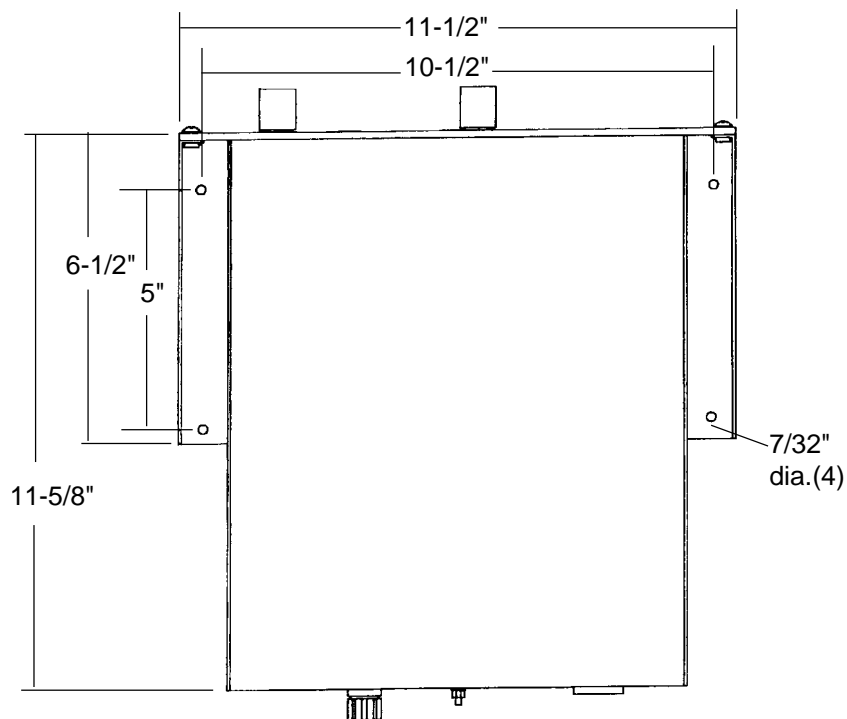

Figure 1-4B Remote V/C Module Mounting Dimensions (Digital Remote Shown)

## SPECIFICATIONS

---

### ⑬ Cable Between 1X7 PS Connector and Dig., Progr. or Curr. Remote

<b>Cable</b>	<b>Cable Diameter (O.D.)</b>	<b>Connector/Lug Diameter</b>
DR-PR V/C/PS Cable	1/2" (13 mm)	1-1/4" (32 mm)
CR/PS Cable	1/2" (13 mm)	1-1/4" (32 mm)

### ⑭ Cable Between 1X8 PS Connector and Progr. Remote

<b>Cable</b>	<b>Cable Diameter (O.D.)</b>	<b>Connector/Lug Diameter</b>
PR V/C/PS Cable	1/2" (13 mm)	1-1/4" (32 mm)

### ⑮ Cable Between PS and Machine Computer Interface

<b>Cable</b>	<b>Cable Diameter (O.D.)</b>	<b>Connector/Lug Diameter</b>
Mach. I/O Interface Cable	1/2" (13 mm)	No connector on Interface end
Mach. V/C Interface Cable	1/2" (13 mm)	No connector on Interface end

### ⑯ Cable Between PS and Work Table

<b>Cable</b>	<b>Cable Diameter (O.D.)</b>	<b>Connector/Lug Diameter</b>
Positive (work) Cable	7/8" (22 mm)	1-1/4" (32 mm)

## System Specifications and Dimensions – Optional and Additional Equipment

### ⑰ Hold Cable Between Power Supplies in Multi-Torch Systems

**Cable**  
Hold Cable, PS1/PS2

**Cable Diameter (O.D.)**  
20 AWG-1/8" (3 mm)

**Connector/Lug Diameter**  
No connectors

### ⑱ Inductive IHS System

#### IHS Console

**Dimensions and Weight:**

Width .....9" (23 cm)  
 Height.....4-1/2" (11 cm)  
 Depth.....11-1/2" (29 cm)  
 Weight .....13 pounds (6 kg)

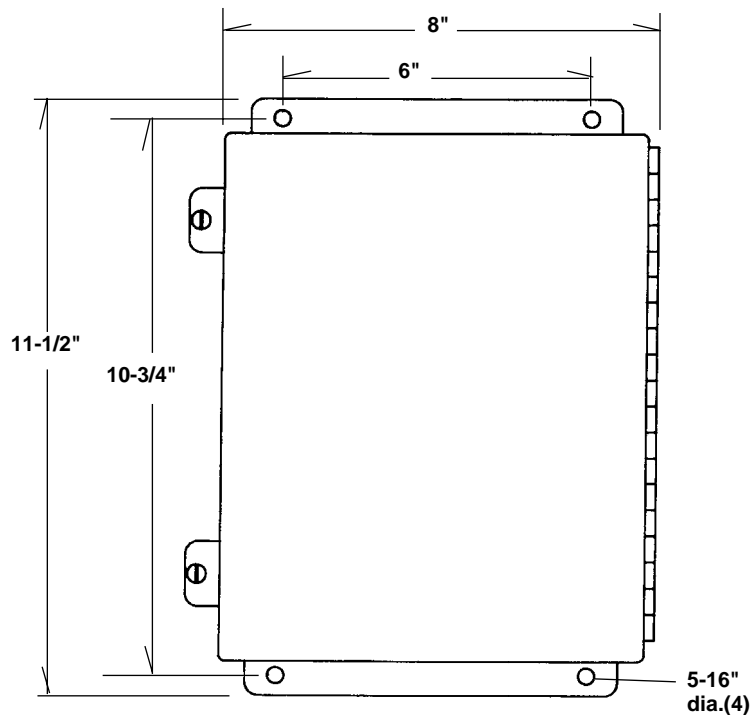

Figure 1-5 IHS Console Mounting Dimensions

## SPECIFICATIONS

---

### 18a Inductive IHS Air Regulator Mounting Bracket

**Dimensions:**

Width .....3-3/8" (8.6 cm)  
 Height.....2-1/8" (5.4 cm)  
 Depth.....1" (2.5 cm)

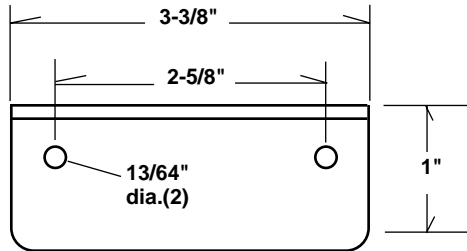

Figure 1-6 IHS Air Regulator Bracket Mounting Dimensions

### 19 Inductive IHS Lead Set

Lead	Lead Diameter (O.D.)	Connector/Lug Diameter
IHS Sensor Probe Cable	1/4" (6 mm)	7/8" (22 mm)
IHS Sensor Probe Cable	1/4" (6 mm)	7/8" (22 mm)
Air Cylinder Hose	1/2" (13 mm)	1/2" (13 mm)
IHS Cntrl Cable	3/8" (9.5 mm)	1" (25 mm)

### 20 Timer/Counter

**Dimensions:**

Width .....6-1/2" (16.5 cm)  
 Height.....2-1/2" (6.4 cm)  
 Depth.....8-5/8" (22 cm)  
 Weight .....3 pounds (1 kg)

### 20a Timer/Counter Cable

Cable	Cable Diameter (O.D.)	Connector/Lug Diameter
Tmr-Cntr/PS Cable	5/16" (8 mm)	No connector

**②1 Water Muffler System – (not used with the stnls. steel torch)**

**Dimensions and Weight of Pump:**

Width .....11" (28 cm)  
 Height.....19" (48 cm)  
 Depth.....17" (43 cm)  
 Weight .....85 pounds (38.6 kg)

<b>Hose</b>	<b>Hose Diameter (O.D.)</b>	<b>Connector/Lug Diameter</b>
WM Pump/WM	1" ( 24 mm)	1" (24 mm)

**②2 Cable Between Water Muffler Pump and Power Supply**

<b>Cable</b>	<b>Cable Diameter (O.D.)</b>	<b>Connector/Lug Diameter</b>
WM/PS Cable	1/4" ( 6 mm)	No connector on pump side

**②3 Hosing Between Supply Gases and Gas Console**

<b>Hose</b>	<b>Hose Diameter (O.D.)</b>	<b>Connector/Lug Diameter</b>
Oxygen Hosing	3/4" (19 mm)	3/4" (19 mm)
Nitrogen Hosing	5/8" (16 mm)	5/8" (16 mm)
Shield Hosing	3/4" (19 mm)	3/4" (19 mm)



## SPECIFICATIONS

---

### ②④ Argon/Hydrogen Console

**Dimensions:**

Width .....5" (12.7 cm)  
 Height .....10" (25.4 cm)  
 Depth .....5" (12.7 cm)  
 Weight .....5-3/4 pounds (2.6 kg)

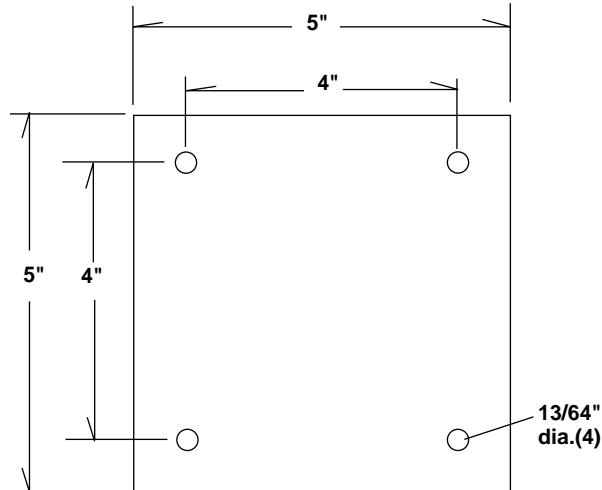

**Figure 1-7 Argon/Hydrogen Console Mounting Dimensions**

### ②⑤ Cable Between Argon/Hydrogen Console and Power Supply

**Cable**  
 Ar-H2/PS Cable

**Cable Diameter (O.D.)**  
 1/2" (13 mm)

**Connector/Lug Diameter**  
 1-1/4" (32 mm)

### ②⑥ Hose Between Argon/Hydrogen Console and Torch

**Hose**  
 Ar-H2/Trch Hose

**Hose Diameter (O.D.)**  
 3/8" (9.5 mm)

**Connector/Lug Diameter**  
 3/8" (9.5 mm)

### Quick Reference to Cable / Hose Dimensions

The following figures are a one-to-one representation of the HT2000 system interconnecting cables and hoses. Figure 1-8 shows cables and hoses that would lay in the rail at the site. Figure 1-9 shows cables and hoses that would lay in the cutting machine's cable/hose carrier. The rulers have been added to use as a guide. Arrangement of cables and hoses laying in rails or carriers are roughly suggested here.

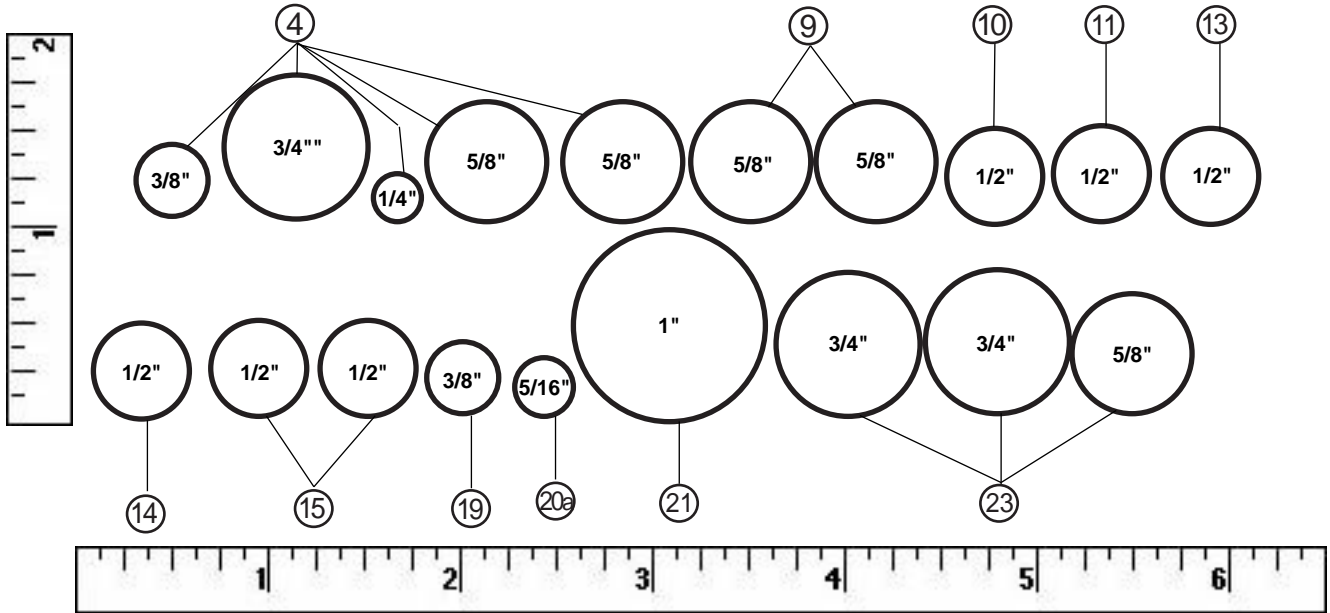

Figure 1-8 Cables / Hoses in Rail

Key – Figure 1-8	
4	Leads – PS/RHF Csl 3/8" RHF Csl Cntrl Cbl 3/4" Negative Cbl 1/4" Pilot Arc Cbl 5/8" Cooling Hose (2)
9	Shield Gas Hose – Gas Csl/ RHF Csl (2)
10	Cable – Gas Csl/PS
11	Cable – Mtr Vlv Csl/PS
13	Cable – PS 1X7/DR,PR, CR
14	Cable – PS 1X8/PR
15	Cable – PS/Mach. Comp. 1/2" Mach. I/O Cbl 1/2" Mach. V/C Cbl
19	Ind. IHS Lead 3/8" IHS Cntrl Cbl
20a	Cable – Tmr-Cntrl/PS
21	WM System 1" WM Pump/WM Hose
23	Hose – Supply/Gas Csl 3/4" Oxygen Hose 3/4" Shield Hose 5/8" Nitrogen Hose

Key – Figure 1-9	
5	Shld Leads – Trch/RHF Csl
8	Leads – Gas Csl/ Mtr Vlv Csl 1/2" Preflow Hose 1/2" Cutflow Hose
11	Cable – Mtr Vlv Csl/PS
19	Ind. IHS Lead Set 1/2" IHS Air Cyl. Hose 1/4" IHS Snsr Probe Cbl (2)
21	WM System 1" W/M Pump to W/M Hose

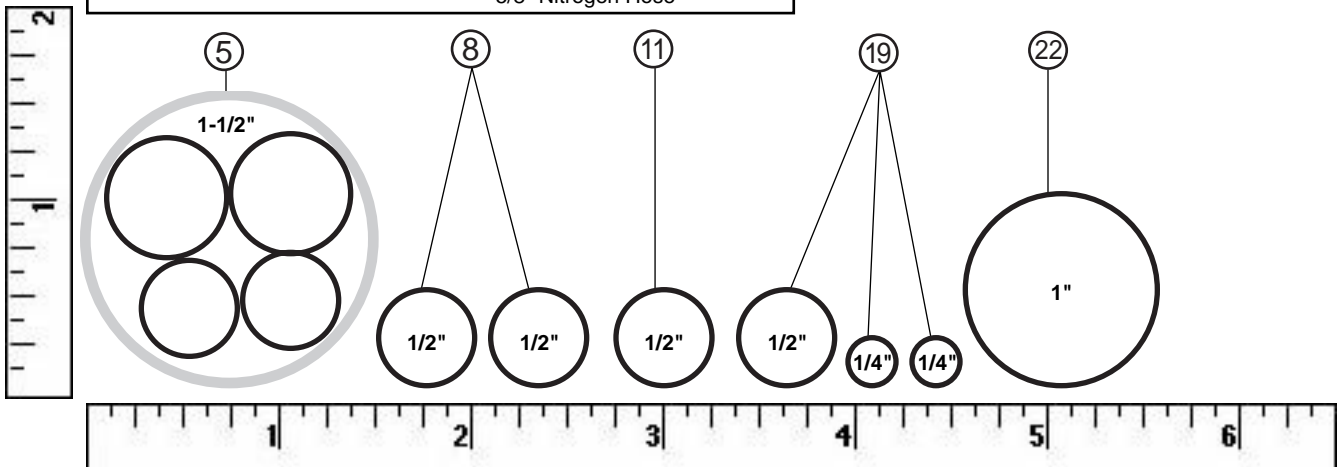

Figure 1-9 Cables / Hoses in Machine Cable/Hose Carrier



### ORDERING PROCEDURE

---

*In this section:*

Introduction .....	2-2
Multi-Torch Systems .....	2-3
Layout of Cutting Machine and System .....	2-4
Ordering Information .....	2-5
Ordering Procedure – Required Equipment .....	2-6
1 Power Supply .....	2-6
2 Torch Assembly .....	2-6
3 Remote High Frequency (RHF) Console .....	2-6
4 Leads Between the Power Supply and the Remote High Frequency Console .....	2-8
5 Shielded Leads Between the Torch and the Remote High Frequency Console .....	2-8
6 Gas Console .....	2-8
7 Motor Valve Console .....	2-10
8 Leads Between the Gas Console and the Motor Valve Console .....	2-10
9 Shield Hose Set Between the Gas Console and the Remote High Frequency Console .....	2-10
10 Cable Between the Gas Console and the Power Supply .....	2-10
11 Cable Between the Motor Valve Console and the Power Supply .....	2-12
12 Remote Voltage/Current (V/C) Control .....	2-12
13 Cable Between the Power Supply and the Digital V/C or Current Remote .....	2-14
14 Cable Between the Power Supply and the Programmable Remote .....	2-14
15 Interface Cables Between the Power Supply and the Machine Computer Interface .....	2-14
16 Cable Between the Power Supply and the Work Table .....	2-14
Ordering Procedure – Optional and Additional Equipment .....	2-16
17 Hold Cable .....	2-16
18 Inductive Initial Height Sensing (IHS) System .....	2-16
18a IHS Pressure Regulator Assembly .....	2-16
19 Inductive IHS Lead Set .....	2-16
20 Timer/Counter .....	2-18
20a Timer/Counter Cable .....	2-18
21 Water Muffler (WM) System .....	2-18
22 WM Cable Between the WM Pump and Power Supply .....	2-18
23 Hosing Between Gas Supplies and Gas Console .....	2-18
24 Argon/Hydrogen Console .....	2-20
25 Cable Between the Argon/Hydrogen Console and the Power Supply .....	2-20
26 Hose Between the Argon/Hydrogen Console and the Torch .....	2-20
Spare Parts Kit .....	2-20

### Introduction

Hypertherm's HT200 is designed as a dual gas, machine-mounted plasma cutting system for production cutting up to 1" (25 mm) thick. Maximum cutting capacity without piercing is 2" (50 mm). A micro-controller on the power supply control board helps to provide extended life for the torch consumable parts. To achieve consumable long life, **all cuts must begin and end on the plate surface**; this allows for the proper control of gases and DC current to extend the life of the torch nozzle and electrode.

The system provides the user with capability of locating the power supply a maximum distance of 200 feet from the torch. This is accomplished by adding a remote high frequency (RHF) console.

The provides continuously variable current output from 40 to 200 amps for optimum performance on all thicknesses of metal. This allows the operator wide variations in cutting speeds on the same thickness of metal. Three nozzle sizes are provided to produce high-quality cuts throughout its range of cut thicknesses.

The HT2000 can be configured for air, oxygen, nitrogen or argon/hydrogen cutting. For cutting stainless steel, aluminum, and other non-ferrous materials, nitrogen or argon/hydrogen can be used as the plasma gas (Hypertherm recommends a mixture of 35% hydrogen and 65% argon). When cutting mild (carbon) steel, oxygen can be used as the plasma gas. Shield gases other than air which can be used are nitrogen and carbon dioxide.

## **Multi-Torch Systems**

If more than one torch is required, increase the quantity of each component by the number of torches to be used.

To specify the correct components for each application, follow the guidelines in this section.

## Layout of Cutting Machine and HT2000 System

When configuring an HT2000 system(s), it is important to know where each major component will be placed. This will vary with the cutting machine type (gantry or cantilever) and with the particular installation. After the location of the major components has been determined, the interconnecting leads and cable lengths can be specified.

It is critical to follow the path that the interconnecting leads will follow and allow for some slack when specifying their lengths. **Do not try to get by with the next shorter length!** Cable stretchers are not provided.

Pictured below are two diagrams showing overhead views of typical cantilever and gantry systems. Installations vary, so use these diagrams as a guide.

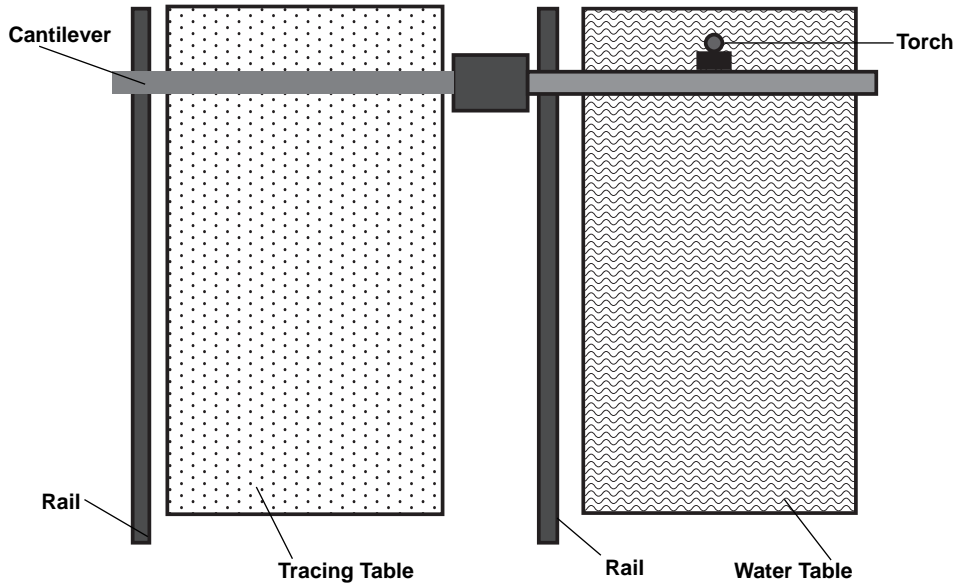
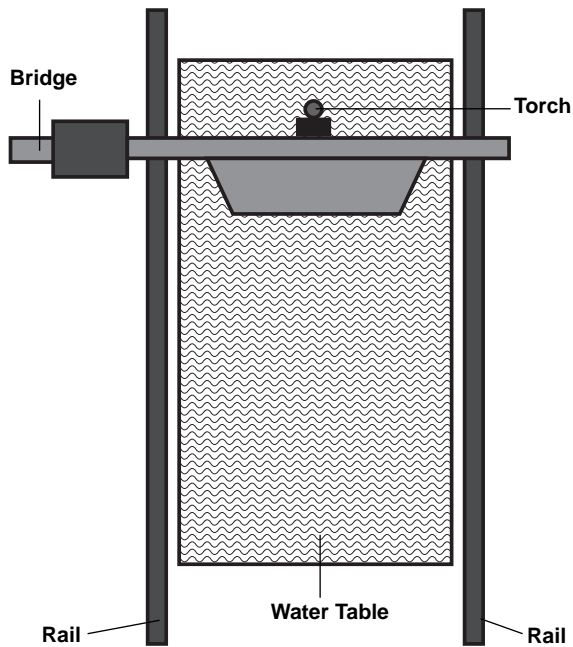

Figure 2-1 Cantilever Layout\*



\* Cables are usually in a power track or festoon system. Cable, lead and hose lengths must allow for routing through the system.

Figure 2-1 Gantry (Bridge) Layout\*

## Ordering Information

To configure an HT2000 system for a particular site, use the following steps as a guide.

Each numbered step is cross-referenced in four areas: in the sample gantry system diagram on page 2-24; in block diagrams to clarify interfacing components; in the accompanying parts lists; and in the specifications section to clarify size and weight of major components. (Block diagrams are offered to clarify *connection* points and do not necessarily reflect relative sizes or distances between components.)

Note: If the cutting system has a power track for cabling and hosing, be certain to see the **Specifications** section to check hose, cable and connector diameters.

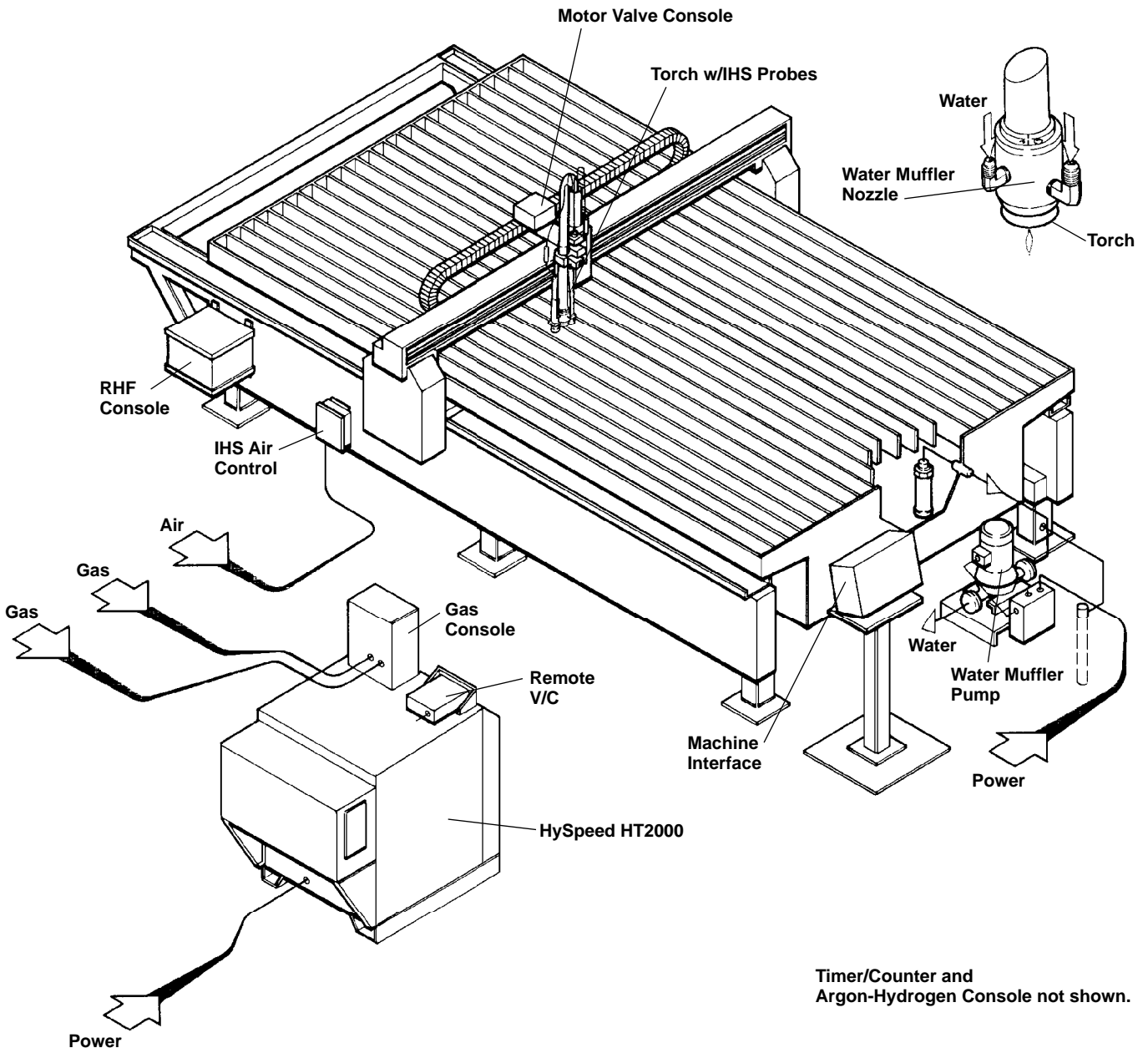

Figure 2-3 HySpeed HT2000 System with Major Components in a Gantry Layout



## Ordering Procedure – Required Equipment

### ① Specify the Power Supply

This unit houses two 100-amp, 15kHz chopper power supplies to produce constant current DC output, variable from 40 to 200 amps. Also located in this unit is the Torch Height Control (THC). The power supply interconnects with the RHF console, IHS, computer interface, remote V/C, water muffler, gas console, valve console, timer/counter, and the workpiece.

- Determine the placement of the power supply and the voltage available at the site. Multi-voltage power supplies are wired for only one voltage from the factory. In order to have the factory pre-set the power supply to an alternate voltage, first order the part number that contains the correct voltage from the parts list on page 2-7. Next, see if that power supply is normally wired for the desired voltage by checking the table below. If you want it wired for the optional voltage, add the number in the right hand column to the number listed on page 2-7 when ordering.

Multi-Voltage Power Supply	Normally wired for	Optional Voltage(s)	Add this # for Optional V
240/480V	480	240	560132
220/380/415V	380	220 415	560131 560135
575/600V	575	600	560138

### ② Specify the Torch Assembly

There are 3 torches available for the HySpeed HT2000: the standard machine torch with a 2" diameter sleeve, an optional machine torch with a 1-3/4" sleeve, and the stainless steel machine torch with a 2" diameter sleeve. The stainless steel machine torch was developed with improved coolant flow to extend the life of the torch. All 3 torches consist of the torch main body, oxygen consumables, torch sleeve, the plasma-off valve, the off-valve cable and the plasma hose that attaches to the motor valve console. Be sure to order the appropriate torch mounting bracket to go on the sleeve after selecting the torch (see 2a).

- Note: **If you plan on using the water muffler system, do not order the stainless steel torch.**
- Order the torch.

### ②a Specify the Torch Mounting Bracket

A torch mounting bracket is needed to attach the torch/valve assembly to the torch lifter on the cutting machine. The standard machine torch and the stainless steel machine torch take the 2" diameter mounting bracket. The optional machine torch takes the 1-3/4" diameter mounting bracket.

- Order the appropriate torch mounting bracket.
- Note: If the IHS option is chosen, a torch mounting bracket is included in the IHS system.

### ③ Specify the Remote High Frequency (RHF) Console

This unit houses water and gas plumbing and related control devices as well as the high-frequency starting circuit. The high-frequency starting circuit permits more effective RF shielding and allows the power supply to be installed at a distance of up to 200 feet from the torch. Fabrication of mounting brackets may be necessary.

- Determine approximately where the console will be mounted on the cutting machine and note the distance from the power supply and the torch. The console is usually mounted on the back of the bridge as close to the torch station as possible. Check the mounting holes and weight of the console to determine where it

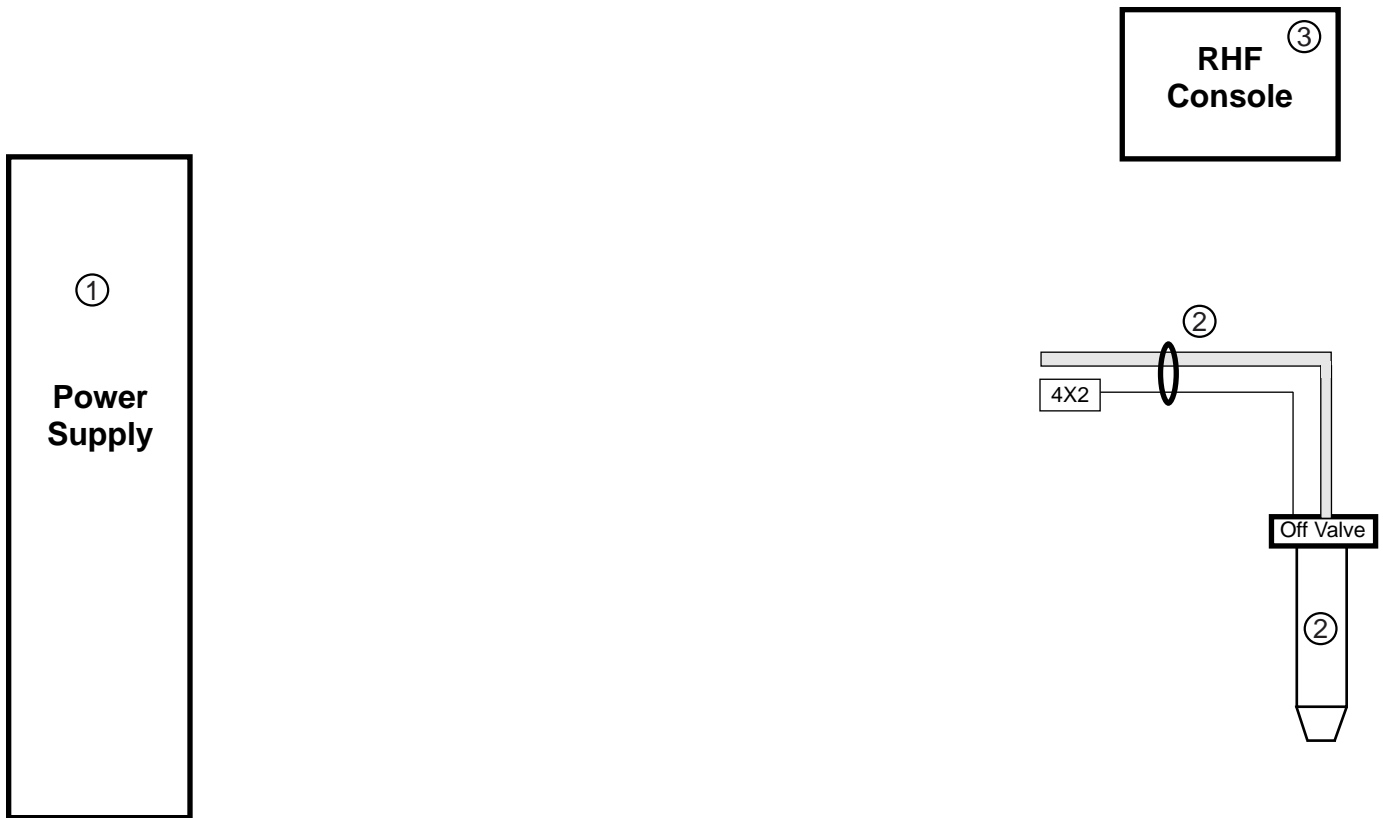

- ① **HySpeed HT2000 Power Supply**
  - 073063 Power Spply 200V, 50 Hz, 3Ø, w/THC
  - 073064 Power Spply 208V, 60 Hz, 3Ø, w/THC
  - 073065 Power Spply 220/380/415V, 50 Hz, 3Ø, w/THC
  - 073198 Power Spply 400V, CE, 50 Hz, 3Ø, w/THC
  - 073054 Power Spply 240/480V, 60 Hz, 3Ø, w/THC
  - 073196 Power Spply 440/460V, 50-60 Hz, 3Ø, w/THC
  - 073066 Power Spply 575/600V, 60 Hz, 3Ø, w/THC
  
  - 073104 Power Spply 200V, 50 Hz, 3Ø, wo/THC
  - 073105 Power Spply 208V, 60 Hz, 3Ø, wo/THC
  - 073107 Power Spply 220/380/415V, 50 Hz, 3Ø, wo/THC
  - 073199 Power Spply 400V, CE, 50 Hz, 3Ø, wo/THC
  - 073106 Power Spply 240/480V, 60 Hz, 3Ø, wo/THC
  - 073108 Power Spply 575/600V, 60 Hz, 3Ø, wo/THC
- ② **HySpeed HT2000 Machine Torch Assembly with 2" Dia. Sleeve**
  - 128381 Torch with Off vlv, Cable, and Hose to Mtr Vlv Csl
- ② **HySpeed Stainless Steel Machine Torch Assembly with 2" Dia. Sleeve**
  - 128367 Torch with Off vlv, Cable, and Hose to Mtr Vlv Csl
- ② **HySpeed Optional Machine Torch Assembly with 1-3/4" Dia. Sleeve**
  - 128141 Optional Torch with Off vlv, Cable, and Hose to Mtr Vlv Csl
- ②a **Torch Mounting Bracket for 2" Dia. Sleeve**
  - 020046 Torch Mounting Bracket for 2" Sleeve
- ②a **Torch Mounting Bracket for 1-3/4" Dia. Sleeve**
  - 020522 Torch Mounting Bracket for 1-3/4" Sleeve
- ③ **Remote High Frequency Console**
  - 073067 RHF Csl, HySpeed HT2000

Figure 2-4 Steps 1 through 3

can best be attached.

### ④ **Specify the Leads Between the Power Supply and the Remote High Frequency Console**

The lead package between the power supply and the remote high frequency console consists of one negative lead (4/0 cable), one pilot arc lead, one control cable, and two coolant hoses.

- Based on the distance (the path that the leads will have to run) between the power supply and the remote high frequency console, order the appropriate lead package.

### ⑤ **Specify the Shielded Leads Between the Torch and the Remote High Frequency Console**

The shielded lead package between the remote high frequency console and the torch consists of two torch coolant hoses, one pilot arc lead and one cap-sensor hose. This lead package is bound together by an external sheathing. If the leads are being placed in a power track, then measure the length from torch through the power track to the console and allow about 3-5 feet of extra length. If a festoon system is used, measure the width of the bridge and double it for lead length.

- Based on the distance between the torch and the remote high frequency console and the above considerations, order the appropriate lead package.

### ⑥ **Specify the Gas Console**

This unit houses metering and solenoid valves for shield and plasma gases, flowmeters and pressure gauges for nitrogen and oxygen plasma, and a pressure gauge for the shield gas supply. The gas console interfaces with the plasma and shield gas supplies, the RHF console, the motor valve console and the power supply. Fabrication of a mounting bracket may be necessary.

- The gas console should be mounted in a convenient location for the operator – usually next to the cutting machine controller. Determine approximately where the console will be mounted in relation to the operator, power supply, gas supplies, motor valve console, remote high frequency console, and the torch. Check mounting holes and weight and order the gas console.

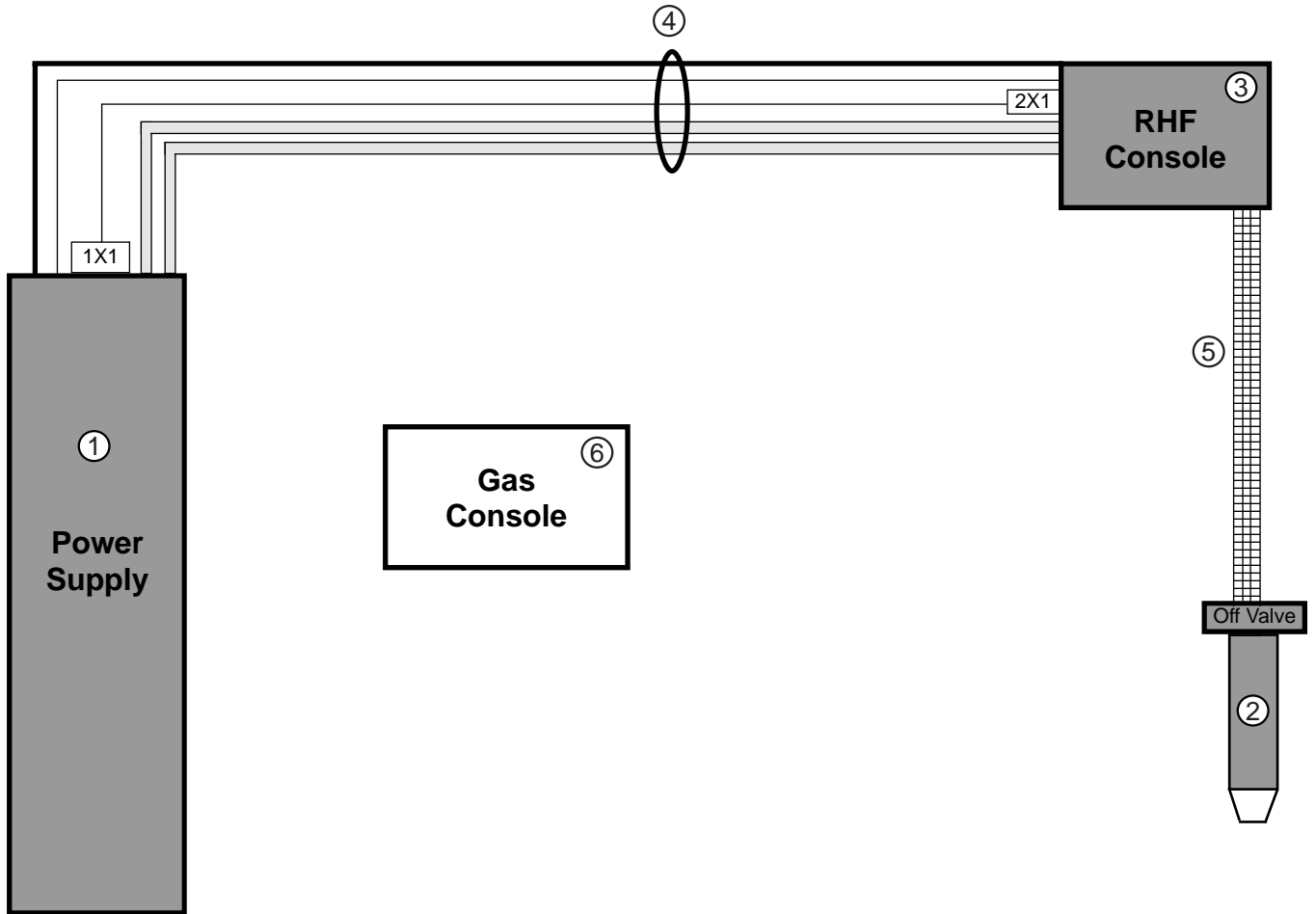

- ④ **Leads Between Power Supply and Remote High Frequency Csl**
- |        |                      |                 |        |                      |                 |
|--------|----------------------|-----------------|--------|----------------------|-----------------|
| 028604 | Lead set, PS/RHF Csl | 25 ft (7.6 m)   | 028901 | Lead set, PS/RHF Csl | 110 ft (33.6 m) |
| 028605 | Lead set, PS/RHF Csl | 50 ft (15.3 m)  | 028895 | Lead set, PS/RHF Csl | 115 ft (35.1 m) |
| 128051 | Lead set, PS/RHF Csl | 60 ft (18.3 m)  | 128128 | Lead set, PS/RHF Csl | 120 ft (36.6 m) |
| 028606 | Lead set, PS/RHF Csl | 75 ft (22.9 m)  | 028746 | Lead set, PS/RHF Csl | 125 ft (38.1 m) |
| 128077 | Lead set, PS/RHF Csl | 85 ft (25.9 m)  | 028608 | Lead set, PS/RHF Csl | 150 ft (45.8 m) |
| 028607 | Lead set, PS/RHF Csl | 100 ft (30.5 m) | 028651 | Lead set, PS/RHF Csl | 200 ft (61 m)   |
- ⑤ **Shielded Leads Between Torch and Remote High Frequency Csl**
- |        |                          |                |        |                          |                |
|--------|--------------------------|----------------|--------|--------------------------|----------------|
| 028657 | Shld Leads, RHF Csl/Trch | 10 ft (3 m)    | 028662 | Shld Leads, RHF Csl/Trch | 40 ft (12.2 m) |
| 028658 | Shld Leads, RHF Csl/Trch | 15 ft (4.6 m)  | 028663 | Shld Leads, RHF Csl/Trch | 45 ft (13.7 m) |
| 028659 | Shld Leads, RHF Csl/Trch | 20 ft (6.1 m)  | 028547 | Shld Leads, RHF Csl/Trch | 50 ft (15.3 m) |
| 028546 | Shld Leads, RHF Csl/Trch | 25 ft (7.6 m)  | 028767 | Shld Leads, RHF Csl/Trch | 55 ft (16.8 m) |
| 028660 | Shld Leads, RHF Csl/Trch | 30 ft (9.2 m)  | 028768 | Shld Leads, RHF Csl/Trch | 60 ft (18.3 m) |
| 028661 | Shld Leads, RHF Csl/Trch | 35 ft (10.6 m) |        |                          |                |
- ⑥ **Gas Console**
- |        |                                |
|--------|--------------------------------|
| 073218 | Gas Console II, HySpeed HT2000 |
|--------|--------------------------------|

Figure 2-5 Steps 4 through 6

### ⑦ **Specify the Motor Valve Console**

This unit houses a motorized plasma gas metering valve and a preflow/operate solenoid valve. Preflow and cutflow gas lines connect the motor valve console to the gas console. A control cable connects the motor valve console with the power supply. The motor valve console also interfaces with the torch via a plasma gas hose and a control cable.

Note: The motor valve console *must* be mounted 10 feet (3 m) from the torch. In most cases, this means that the console will be mounted to the torch lifter station. Fabrication of mounting brackets may be necessary.

- Determine where the motor valve console will be mounted in relation to the torch, the gas console, and the power supply. Order the console.

### ⑧ **Specify the Leads Between the Gas Console and the Motor Valve Console**

The lead package between the gas console and the motor valve console consists of one plasma preflow gas hose and one plasma cut flow gas hose.

- Based on the distance (the path the leads will take) between the gas console and the valve console, specify the appropriate lead package part number.

### ⑨ **Specify the Shield Hose Set Between the Gas Console and the Remote High Frequency Console**

- Based on the distance (the path the leads will take) between the gas console and the remote high frequency console, specify the appropriate part number.

### ⑩ **Specify the Cable Between the Gas Console and the Power Supply**

- Based on the distance (the path the leads will take) between the gas console and the power supply, specify the appropriate part number.

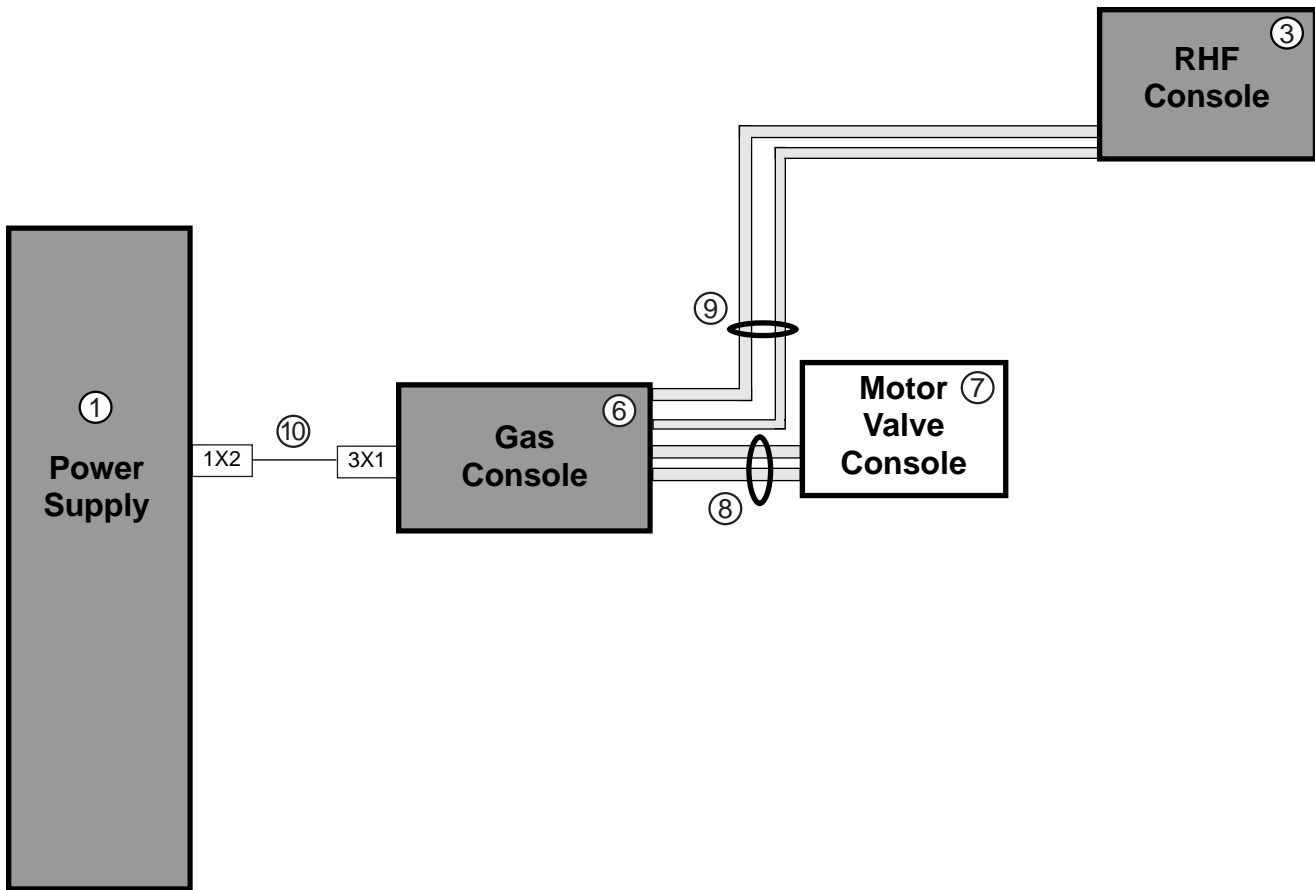

⑦ **Motor Valve Console**  
073219 Motor Valve Console II, HySpeed HT2000

⑧ **Leads Between Gas Csl and Motor Valve Csl**  
028622 Leads, Gas Csl/Mtr Vlv Csl 10 ft (3 m)  
028623 Leads, Gas Csl/Mtr Vlv Csl 15 ft (4.6 m)  
028624 Leads, Gas Csl/Mtr Vlv Csl 20 ft (6.2 m)  
028625 Leads, Gas Csl/Mtr Vlv Csl 25 ft (7.6 m)  
028626 Leads, Gas Csl/Mtr Vlv Csl 30 ft (9.2 m)

028627 Leads, Gas Csl/Mtr Vlv Csl 35 ft (10.6 m)  
028774 Leads, Gas Csl/Mtr Vlv Csl 45 ft (13.7 m)  
028654 Leads, Gas Csl/Mtr Vlv Csl 50 ft (15.3 m)  
028852 Leads, Gas Csl/Mtr Vlv Csl 61 ft (18.6 m)  
028655 Leads, Gas Csl/Mtr Vlv Csl 75 ft (22.9 m)  
028656 Leads, Gas Csl/Mtr Vlv Csl 100 ft (30.5 m)

⑨ **Shield Gas Hose Set Between Gas Csl and RHF Csl**  
028683 Hoses, Gas Csl/RHF Csl 10 ft (3 m)  
028684 Hoses, Gas Csl/RHF Csl 15 ft (4.6 m)  
028685 Hoses, Gas Csl/RHF Csl 20 ft (6.2 m)  
028686 Hoses, Gas Csl/RHF Csl 25 ft (7.6 m)

028687 Hoses, Gas Csl/RHF Csl 30 ft (9.2 m)  
028688 Hoses, Gas Csl/RHF Csl 35 ft (10.6 m)  
028689 Hoses, Gas Csl/RHF Csl 50 ft (15.3 m)  
128040 Hoses, Gas Csl/RHF Csl 75 ft (22.9 m)

⑩ **Cable Between Gas Csl and Power Supply**  
023989 Cable, Gas Csl/PS 10 ft (3 m)  
023549 Cable, Gas Csl/PS 15 ft (4.6 m)  
023605 Cable, Gas Csl/PS 25 ft (7.6 m)  
023757 Cable, Gas Csl/PS 38 ft (11.6 m)  
023606 Cable, Gas Csl/PS 50 ft (15.3 m)  
123044 Cable, Gas Csl/PS 60 ft (18.3 m)  
023607 Cable, Gas Csl/PS 75 ft (22.9 m)

123077 Cable, Gas Csl/PS 85 ft (25.9 m)  
023608 Cable, Gas Csl/PS 100 ft (30.5 m)  
023963 Cable, Gas Csl/PS 115 ft (35.1 m)  
123147 Cable, Gas Csl/PS 120 ft (36.6 m)  
023743 Cable, Gas Csl/PS 125 ft (38.1 m)  
023609 Cable, Gas Csl/PS 150 ft (45.8 m)  
023953 Cable, Gas Csl/PS 200 ft (61 m)

Figure 2-6 Steps 7 through 10

### ⑪ **Specify the Cable Between the Motor Valve Console and the Power Supply**

- Based on the distance (the path the leads will take) between the motor valve console and the power supply, specify the appropriate part number.

### ⑫ **Specify the Remote Voltage/Current (V/C) Control**

This unit provides accurate operator control of the arc voltage and current. It includes high intensity LED displays which indicate the setpoints for volts and amperes prior to starting the arc. After the arc is initiated, the displays automatically switch to show the actual values of the voltage and current reached. This unit interfaces with the power supply and requires the THC control board in the power supply. When using torch height control other than the Command THC, a special current remote is required (see optional current remote below).

#### **Digital Remote (DR)**

Includes the voltage and current displays and two potentiometers used to select the desired values. It is used with guidance machinery that already includes plasma control switches.

#### **Programmable Remote (PR)**

Includes the voltage and current displays. No switches or potentiometers are included. All functions are controlled by the guidance machinery computer. Unlike Digital and Remote Current Control units, this unit connects to the power supply via two control cables.

#### **Current Remote (CR) – optional**

Used for non-Command THC applications. Includes a thumbwheel switch and display for setting cutting current.

- Determine where the remote control unit will be mounted (usually close to the machine control station) in relation to the power supply and the operator. Select the remote unit that best fits the application.

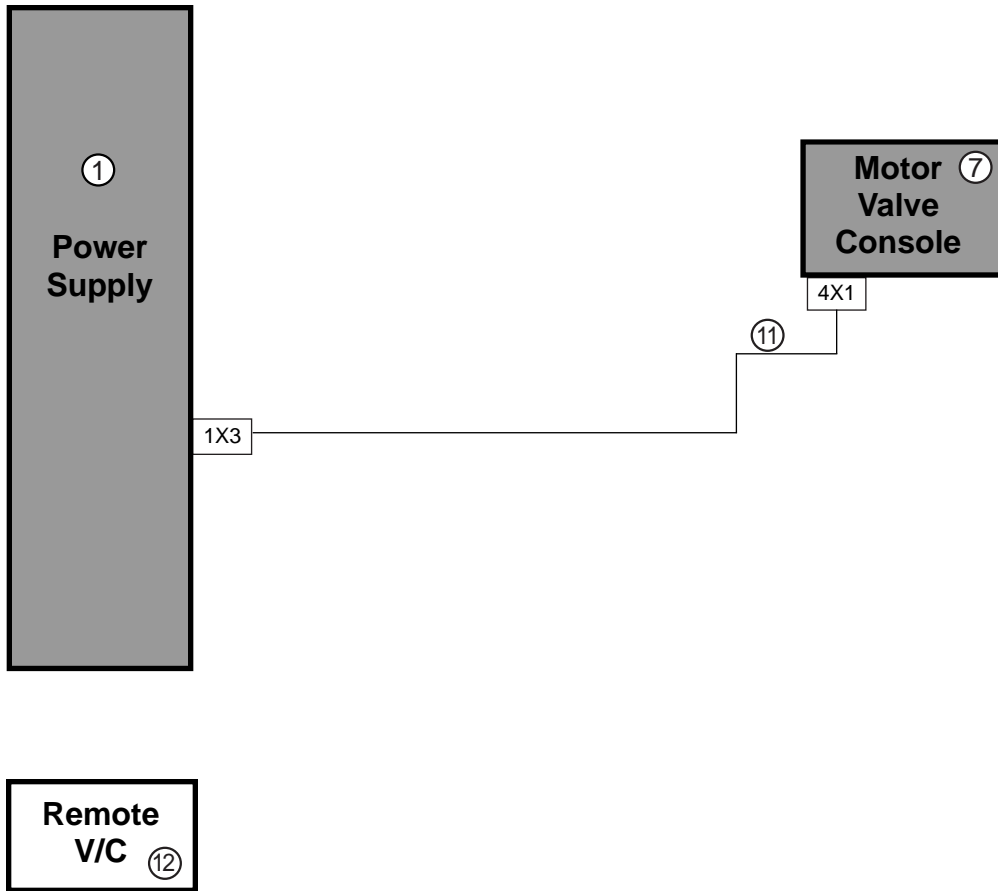

- ⑪ **Cable Between Motor Valve Csl and Power Supply**
- |        |                       |                 |
|--------|-----------------------|-----------------|
| 023551 | Cable, Mtr Vlv Csl/PS | 15 ft (4.6 m)   |
| 023590 | Cable, Mtr Vlv Csl/PS | 25 ft (7.6 m)   |
| 023776 | Cable, Mtr Vlv Csl/PS | 35 ft (10.7 m)  |
| 023591 | Cable, Mtr Vlv Csl/PS | 50 ft (15.3 m)  |
| 023592 | Cable, Mtr Vlv Csl/PS | 75 ft (22.9 m)  |
| 123045 | Cable, Mtr Vlv Csl/PS | 85 ft (25.9 m)  |
| 023593 | Cable, Mtr Vlv Csl/PS | 100 ft (30.5 m) |
| 123078 | Cable, Mtr Vlv Csl/PS | 110 ft (33.6 m) |
| 023967 | Cable, Mtr Vlv Csl/PS | 120 ft (36.6 m) |
| 123143 | Cable, Mtr Vlv Csl/PS | 130 ft (39.7 m) |
| 023594 | Cable, Mtr Vlv Csl/PS | 150 ft (45.8 m) |
| 023658 | Cable, Mtr Vlv Csl/PS | 200 ft (61 m)   |

- ⑫ **Remote Voltage/Current (V/C) Control**
- |        |                                  |
|--------|----------------------------------|
| 073007 | Control, Digital Remote V/C      |
| 055004 | Control, Programmable Remote V/C |
| 073045 | Control, Current Remote          |

Figure 2-7 Steps 11 through 12



### ⑬ Specify the Cable Between the Power Supply and the Digital V/C or Current Remote

There are two different cables that connect the remote units to the power supply: one cable connects the digital V/C remote to the power supply (13a), and one cable connects the current remote to the power supply (13b).

- ⑬a • Based on the distance between the digital remote and the power supply, order the appropriate part number.
- ⑬b • Based on the distance between the current remote and the power supply, order the appropriate part number.

### ⑭ Specify the Cables Between the Power Supply and the Programmable Remote

There are two cables from the power supply to the programmable remote.

- Based on the distance between the programmable remote and the power supply, specify the appropriate part number. (Part numbers include both cables.)

### ⑮ Specify the Interface Cables Between the Power Supply and the Machine Computer Interface

There are two cables that connect from the power supply to the machine computer interface: An I/O cable (input/output) and a V/C cable (voltage/current). The I/O cable is always required. The V/C cable is used with programmable V/C control, or when no V/C control is specified.

- ⑮a • Determine the necessary length of the machine I/O interface cable and order the appropriate part number.
- ⑮b • Determine the necessary length of the machine V/C interface cable and order the appropriate part number.

### ⑯ Specify the Cable Between the Power Supply and the Work Table

The work (positive) cable connects the positive side of the power supply circuit to the workpiece via the cutting table. It should be kept as short as possible.

- Determine the necessary length for the work cable and order from parts list on page 2-15.

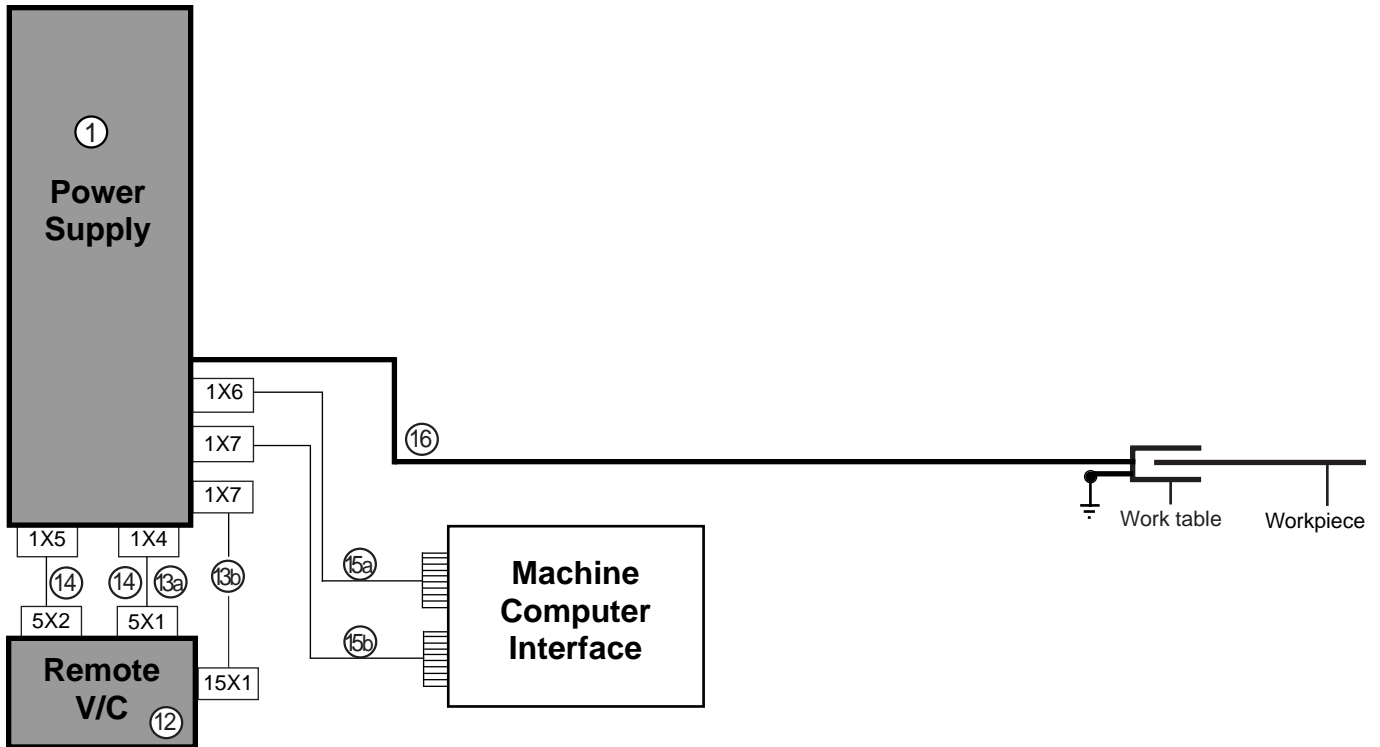

**13a Cable Between PS and Digital Remote**

023990 Cable, PS/DR 7 ft (2.1 m)	023880 Cable, PS/DR 75 ft (22.9 m)	023883 Cable, PS/DR 150 ft (45.8 m)
023911 Cable, PS/DR 15 ft (4.6 m)	123073 Cable, PS/DR 85 ft (25.9 m)	023884 Cable, PS/DR 200 ft (61 m)
023878 Cable, PS/DR 25 ft (7.6 m)	023881 Cable, PS/DR 100 ft (30.5 m)	023885 Cable, PS/DR 250 ft (76.3 m)
023879 Cable, PS/DR 50 ft (15.3 m)	123188 Cable, PS/DR 120 ft (36.6 m)	023886 Cable, PS/DR 275 ft (83.9 m)
123040 Cable, PS/DR 60 ft (18.3 m)	023882 Cable, PS/DR 125 ft (38.1 m)	023887 Cable, PS/DR 300 ft (91.5 m)

**13b Cable Between PS and Current Remote**

123150 Cable, PS/CR 10 ft (3 m)	023874 Cable, PS/CR 75 ft (22.9 m)	023876 Cable, PS/CR 150 ft (45.8 m)
023871 Cable, PS/CR 25 ft (7.6 m)	023875 Cable, PS/CR 100 ft (30.5 m)	123032 Cable, PS/CR 170 ft (51.9 m)
023872 Cable, PS/CR 38 ft (11.6 m)	123068 Cable, PS/CR 110 ft (33.6 m)	023877 Cable, PS/CR 200 ft (61 m)
023873 Cable, PS/CR 50 ft (15.3 m)	123088 Cable, PS/CR 125 ft (38.1 m)	

**14 Cables Between PS and Programmable Remote**

028831 Cables, PS/PR 15 ft (4.6 m)	028612 Cables, PS/PR 100 ft (30.5 m)	028833 Cables, PS/PR 250 ft (76.3 m)
028609 Cables, PS/PR 25 ft (7.6 m)	028832 Cables, PS/PR 125 ft (38.1 m)	028834 Cables, PS/PR 275 ft (83.9 m)
028610 Cables, PS/PR 50 ft (15.3 m)	028613 Cables, PS/PR 150 ft (45.8 m)	028835 Cables, PS/PR 300 ft (91.5 m)
028611 Cables, PS/PR 75 ft (22.9 m)	028614 Cables, PS/PR 200 ft (61 m)	

**15a Cable Between PS and Machine Computer I/O Interface**

023841 Cable, PS/Ma.I/O 6 ft (1.8 m)	123047 Cable, PS/Ma.I/O 60 ft (18.3 m)	123148 Cable, PS/Ma.I/O 120 ft (36.6 m)
023842 Cable, PS/Ma.I/O 15 ft (4.6 m)	023846 Cable, PS/Ma.I/O 75 ft (22.9 m)	023848 Cable, PS/Ma.I/O 125 ft (38.1 m)
023843 Cable, PS/Ma.I/O 25 ft (7.6 m)	123080 Cable, PS/Ma.I/O 85 ft (25.9 m)	023849 Cable, PS/Ma.I/O 150 ft (45.8 m)
023844 Cable, PS/Ma.I/O 35 ft (10.6 m)	023847 Cable, PS/Ma.I/O 100 ft (30.5 m)	023850 Cable, PS/Ma.I/O 200 ft (61 m)
023845 Cable, PS/Ma.I/O 50 ft (15.3 m)	023962 Cable, PS/Ma.I/O 115 ft (35.1 m)	

**15b Cable Between PS and Machine Computer V/C Interface**

023902 Cable, PS/Ma.V/C 6 ft (1.8 m)	023854 Cable, PS/Ma.V/C 50 ft (15.3 m)	023903 Cable, PS/Ma.V/C 125 ft (38.1 m)
023851 Cable, PS/Ma.V/C 15 ft (4.6 m)	023855 Cable, PS/Ma.V/C 75 ft (22.9 m)	023857 Cable, PS/Ma.V/C 150 ft (45.8 m)
023852 Cable, PS/Ma.V/C 25 ft (7.6 m)	023856 Cable, PS/Ma.V/C 100 ft (30.5 m)	023858 Cable, PS/Ma.V/C 200 ft (61 m)
023853 Cable, PS/Ma.V/C 35 ft (10.6 m)		

**16 Cable Between PS and Work Table**

023755 Cable, PS/Wk Tbl 4 ft (1.2 m)	023403 Cable, PS/Wk Tbl 15 ft (4.6 m)	023986 Cable, PS/Wk Tbl 35 ft (10.7 m)
023920 Cable, PS/Wk Tbl 8 ft (2.4 m)	023404 Cable, PS/Wk Tbl 25 ft (7.6 m)	023405 Cable, PS/Wk Tbl 50 ft (15 m)
023508 Cable, PS/Wk Tbl 10 ft (3 m)	023968 Cable, PS/Wk Tbl 30 ft (9.2 m)	

Figure 2-8 Steps 13 through 16

### Ordering Procedure – Optional and Additional Equipment

#### ⑰ Specify the Hold Cable

If the application is to use a two-torch system, a hold cable is required to interface the power supplies.

- Determine where the additional power supply is to be positioned, and order the appropriate hold cable from the parts list on page 2-17.

#### ⑱ Specify the Inductive Initial Height Sensing (IHS) System

This unit, consisting of a control box with two inductive probes, is designed to automatically detect the workpiece surface and index the torch to the pierce position. This system can be used for underwater, at the water line, or above-water applications. This unit interconnects with the power supply through the IHS lead set and the inductive probes, and requires an air supply to operate.

The IHS console must be located within 40 feet of the torch. See Figure 1-5 on pg. 1-9 for weight and mounting requirements.

- There are 2 IHS systems to choose from. One is used with the 2" (50 mm) diameter torch and the other is used with the 1-3/4" (44 mm) diameter torch. Order the IHS system to match the same diameter torch ordered in step 2. The IHS number includes the IHS console, torch mounting bracket, air cylinder and inductive sensor assemblies.

Note: The torch mounting bracket from step 2a is not needed when the IHS is ordered.

#### ⑱a Specify the IHS Pressure Regulator Assembly

- Order the pressure regulator assembly. This number includes air regulator and regulator mounting bracket. See Figure 1-6 on pg. 1-10 for IHS air regulator mounting bracket dimensions.

#### ⑲ Specify the Inductive IHS Lead Set

- Order the IHS lead set. The lead set consists of two 40-foot sensor probe cables, a 50-foot air cylinder hose, and a control cable that is connected to the power supply. Based on the distance between the power supply and the IHS console, select the appropriate number from the parts list on page 2-17.

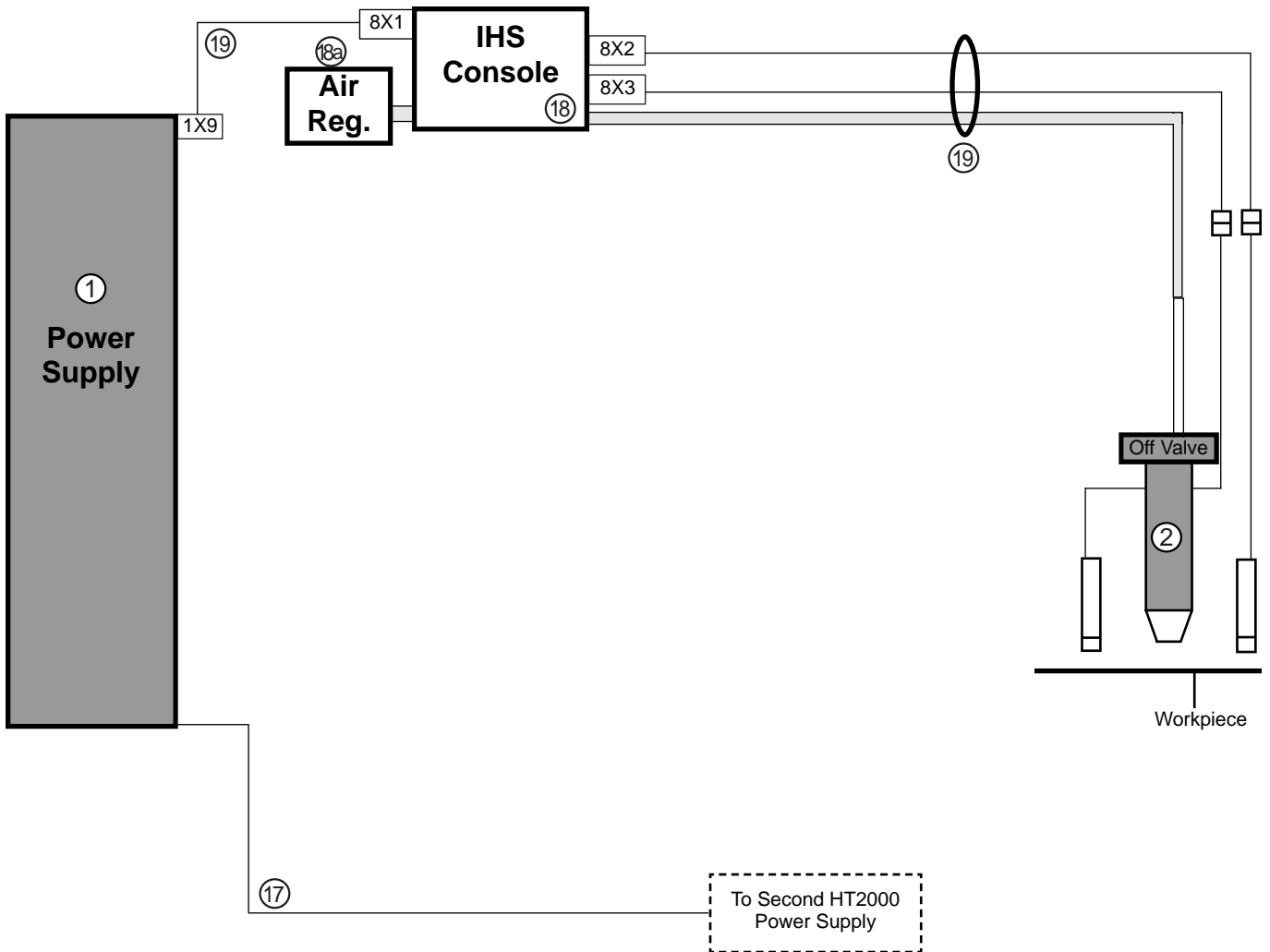

- ⑰ Hold Cable Between Power Supplies in Multi-Torch Systems**
- |        |                |                |  |        |                |                 |
|--------|----------------|----------------|--|--------|----------------|-----------------|
| 023340 | Cable, PS1/PS2 | 15 ft (4.6 m)  |  | 023343 | Cable, PS1/PS2 | 100 ft (30.5 m) |
| 023341 | Cable, PS1/PS2 | 25 ft (7.6 m)  |  | 023344 | Cable, PS1/PS2 | 150 ft (45.8 m) |
| 023342 | Cable, PS1/PS2 | 50 ft (15.3 m) |  |        |                |                 |
- ⑱ Inductive Initial Height Sensing (IHS) System for 2" Torch**
- 028720 IHS System, Inductive for 2" Dia. Torch
- ⑱ Inductive Initial Height Sensing (IHS) System for 1-3/4" Torch**
- 028390 IHS System, Inductive for 1-3/4" Dia. Torch
- ⑱ IHS Pressure Regulator Assembly**
- 029758 IHS Pressure Reg. SA
- ⑲ Inductive IHS Lead Set**
- |        |               |                |  |        |               |                 |
|--------|---------------|----------------|--|--------|---------------|-----------------|
| 028811 | Lead Set, IHS | 25 ft (7.6 m)  |  | 028814 | Lead Set, IHS | 100 ft (30.5 m) |
| 028812 | Lead Set, IHS | 50 ft (15.3 m) |  | 028815 | Lead Set, IHS | 150 ft (45.8 m) |
| 028813 | Lead Set, IHS | 75 ft (22.9 m) |  | 028816 | Lead Set, IHS | 200 ft (61 m)   |

Figure 2-9 Steps 17 through 19

### ②0 Specify the Timer/Counter

This unit allows the operator to monitor the number of arc starts and the cumulative time that the arc is on in hours.

- The timer/counter usually rests on the power supply. Order the timer/counter.

### ②0a Specify the Timer/Counter Cable

- Order the timer/counter cable.

### ②1 Specify the Water Muffler (WM) System

The water muffler for the HT2000 system is an option which greatly improves cutting safety and pollution control capabilities. A water table must be installed in order to use this option. The water muffler can be used to cut both above and below water. Supply water is taken from the water table. The system consists of a torch shield, a nozzle assembly, a water pump, a filter/strainer, a 50 ft (15 m) hose, and a 4 ft (1 m) hose. Systems can be ordered with or without the hoses. See page 2-19 for system interface configuration.

- Note: **The water muffler system will not work with the stainless steel torch.**

- ②1 • Determine the voltage available at the site (for the pump), and whether the customer wants to provide his/her own hosing or not. Order the appropriate system from the parts list on page 2-19.
- ②1a • For installations requiring longer hose lengths, specify the additional length required with the appropriate additional length part number.

### ②2 Specify the WM Cable Between the WM Pump and Power Supply

- Based on the distance between the water muffler pump and the power supply, order the appropriate cable from the parts list on page 2-19.

### ②3 Specify the Hose Between Gas Supplies and Gas Console

Hypertherm offers hose to interface from the source gas supplies to the gas console.

- ②3a • Order oxygen plasma gas hose.

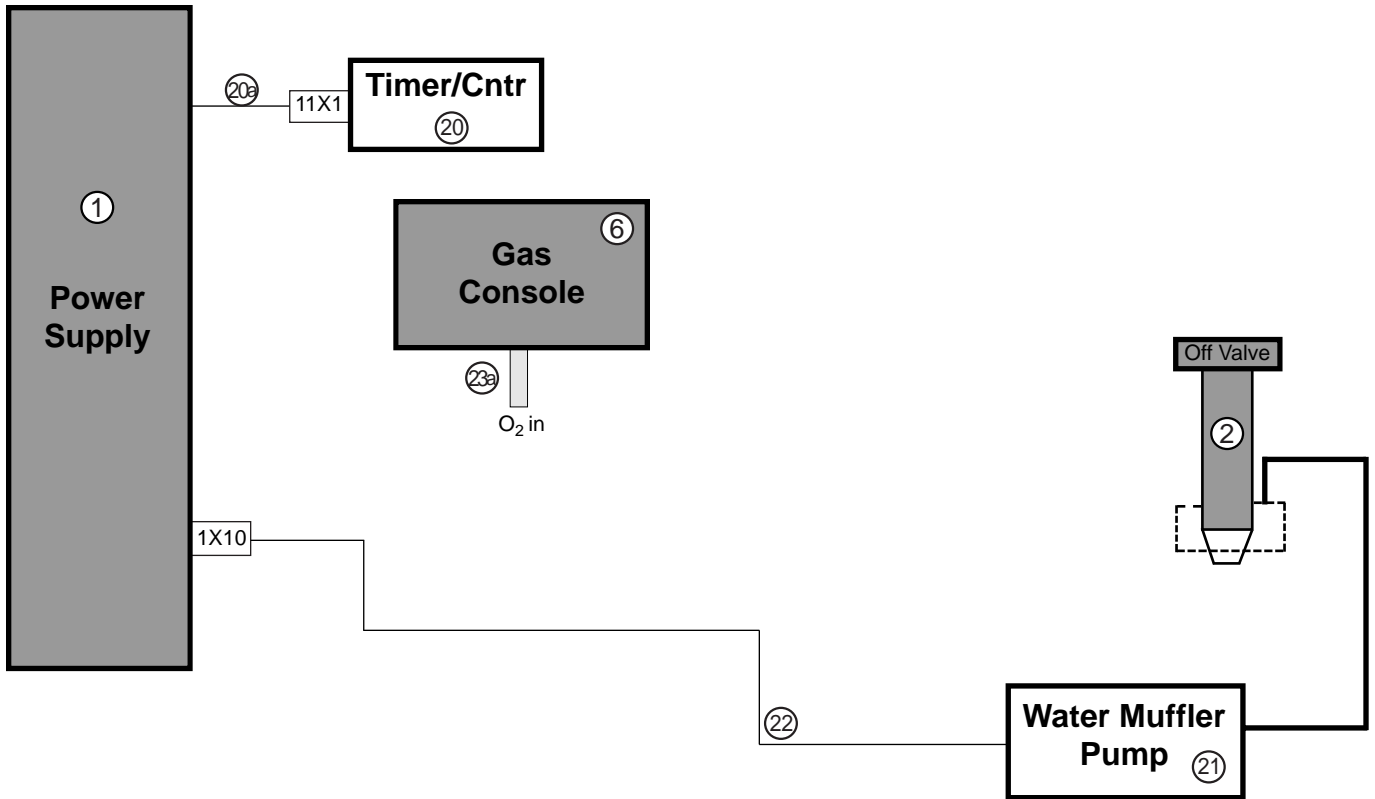

②① **Timer / Counter**  
073194 Tmr-Cntr

②② **Cable Between Timer / Counter and Power Supply**

023687	Cable, Tmr-Cntr/PS	10 ft (3 m)
023692	Cable, Tmr-Cntr/PS	25 ft (7.6 m)
023758	Cable, Tmr-Cntr/PS	38 ft (11.6 m)
023693	Cable, Tmr-Cntr/PS	50 ft (15.3 m)
123046	Cable, Tmr-Cntr/PS	60 ft (18.3 m)
023694	Cable, Tmr-Cntr/PS	75 ft (22.9 m)
123079	Cable, Tmr-Cntr/PS	85 ft (25.9 m)
023695	Cable, Tmr-Cntr/PS	100 ft (30.5 m)
023993	Cable, Tmr-Cntr/PS	115 ft (35.1 m)
123189	Cable, Tmr-Cntr/PS	120 ft (36.6 m)
023696	Cable, Tmr-Cntr/PS	150 ft (45.8 m)
023954	Cable, Tmr-Cntr/PS	200 ft (61 m)

②③ **Water Muffler Systems – with hoses (not used with stnls. steel torch)**

034096	WM Sys/w hoses	240/480V, 3Ø, 60Hz
034100	WM Sys/w hoses	380/415V, 3Ø, 60Hz
034098	WM Sys/w hoses	600V, 3Ø, 60 Hz

②④ **Water Muffler Systems – without hoses (not used with stnls. steel torch)**

034097	WM Sys/wo hoses	240/480V, 3Ø, 60 Hz
034101	WM Sys/wo hoses	380/415V, 3Ø, 60 Hz
034099	WM Sys/wo hoses	600V, 3Ø, 60 Hz

②⑤ **Additional Length WM Hose (specify length in ft)**  
034051 Add'l Length W-M Hose (Qty in Ft.)

②⑥ **Cable Between Water Muffler Pump and Power Supply**

023866	Cable, WM/PS	50 ft (15.3 m)
023867	Cable, WM/PS	75 ft (22.9 m)
023868	Cable, WM/PS	100 ft (30.5 m)

②⑦ **Hose Between Oxygen Supply and Gas Csl**

024204	Hose, O2/Gas Csl	15 ft (4.6 m)
024205	Hose, O2/Gas Csl	25 ft (7.6 m)
024155	Hose, O2/Gas Csl	50 ft (15.3 m)
024398	Hose, O2/Gas Csl	75 ft (22.9 m)
024487	Hose, O2/Gas Csl	85 ft (25.9 m)
024206	Hose, O2/Gas Csl	100 ft (30.5 m)
024481	Hose, O2/Gas Csl	110 ft (33.6 m)
024450	Hose, O2/Gas Csl	115 ft (35.1 m)
024516	Hose, O2/Gas Csl	120 ft (36.6 m)
024490	Hose, O2/Gas Csl	125 ft (38.1 m)
024159	Hose, O2/Gas Csl	150 ft (45.8 m)
024470	Hose, O2/Gas Csl	180 ft (54.9 m)
024333	Hose, O2/Gas Csl	200 ft (61 m)

Figure 2-10 Steps 20 through 23

### ②③ Specify the Hose Between Gas Supplies and Gas Console (continued)

- ②③b • Order nitrogen plasma gas hose.
- ②③c • Order shield gas hose.

### ②④ Specify the Argon/Hydrogen Console

This unit houses a flowmeter for argon/hydrogen, a metering valve, a pressure switch, and a plasma-off valve. The argon/hydrogen console interfaces with the power supply, the argon/hydrogen supply gas, and the torch.

Note: The argon/hydrogen console must be mounted within 40 feet (12 m) of the torch. Fabrication of mounting brackets may be necessary.

- Determine where the argon/hydrogen console will be mounted and order the console.

### ②⑤ Specify the Cable Between the Argon/Hydrogen Console and the Power Supply

This unit houses a flowmeter for argon/hydrogen, a metering valve, a pressure switch, and a plasma-off valve. The argon/hydrogen console interfaces with the power supply, the argon/hydrogen supply gas, and the torch.

- Based on the distance (the path the leads will take) between the argon/hydrogen console and the power supply, specify the appropriate part number.

### ②⑥ Specify the Hose Between the Argon/Hydrogen Console and the Torch

This hosing connects to the off valve which is attached to the torch.

- Order the argon/hydrogen hose.

## Spare Parts Kit

The spare parts kit provides an initial supply of consumables, O-rings, tools and silicone grease. One spare parts kit should be ordered with each system. Part number 028602 has standard consumables. Part number 128825 has HySpeed consumables.

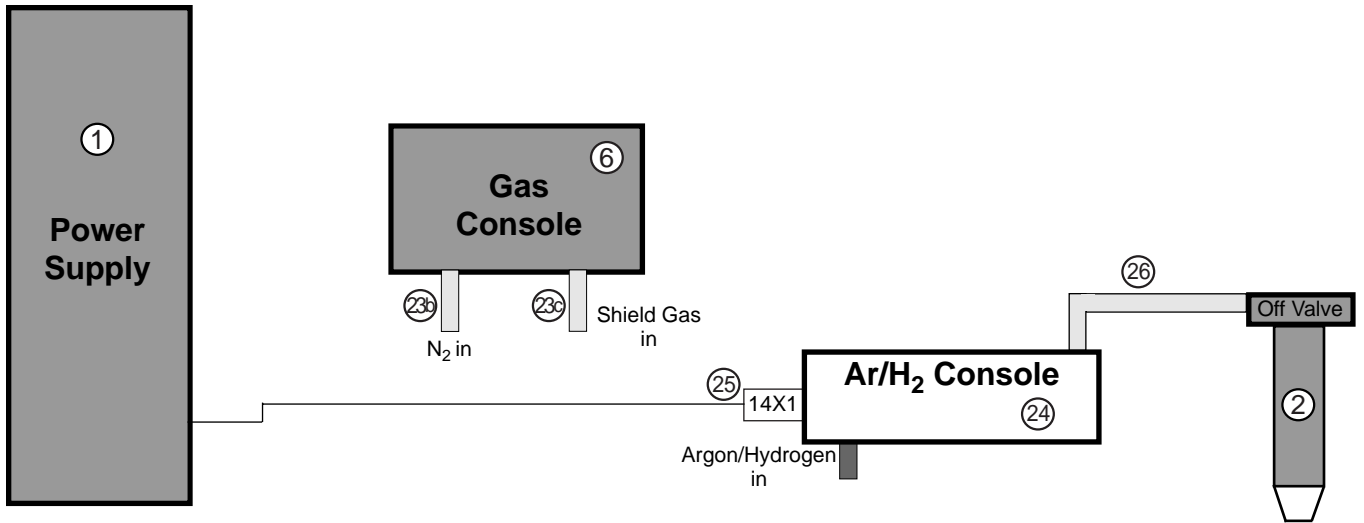

**23b Hose Between Nitrogen Supply and Gas Csl**

024505	Hose, N2/Gas Csl	6 ft (1.8 m)
024210	Hose, N2/Gas Csl	10 ft (3 m)
024203	Hose, N2/Gas Csl	15 ft (4.6 m)
024232	Hose, N2/Gas Csl	20 ft (6.1 m)
024134	Hose, N2/Gas Csl	25 ft (7.6 m)
024211	Hose, N2/Gas Csl	35 ft (10.7 m)
024112	Hose, N2/Gas Csl	50 ft (15.3 m)
024148	Hose, N2/Gas Csl	75 ft (22.9 m)
024488	Hose, N2/Gas Csl	85 ft (25.9 m)
024116	Hose, N2/Gas Csl	100 ft (30.5 m)
024482	Hose, N2/Gas Csl	110 ft (33.6 m)
024451	Hose, N2/Gas Csl	115 ft (35.1 m)
024517	Hose, N2/Gas Csl	120 ft (36.6 m)
024491	Hose, N2/Gas Csl	125 ft (38.1 m)
024120	Hose, N2/Gas Csl	150 ft (45.8 m)
024185	Hose, N2/Gas Csl	180 ft (54.9 m)
024124	Hose, N2/Gas Csl	200 ft (61 m)

**23c Hose Between Shield Gas Supply and Gas Csl**

024043	Hose, Shld Gas/Gas Csl	4 ft (1.2 m)
024341	Hose, Shld Gas/Gas Csl	10 ft (3 m)
024200	Hose, Shld Gas/Gas Csl	15 ft (4.6 m)
024342	Hose, Shld Gas/Gas Csl	20 ft (6.1 m)
024133	Hose, Shld Gas/Gas Csl	25 ft (7.6 m)
024448	Hose, Shld Gas/Gas Csl	35 ft (10.7 m)
024407	Hose, Shld Gas/Gas Csl	45 ft (13.7 m)
024012	Hose, Shld Gas/Gas Csl	50 ft (15.3 m)
024472	Hose, Shld Gas/Gas Csl	60 ft (18.3 m)
024147	Hose, Shld Gas/Gas Csl	75 ft (22.9 m)
024486	Hose, Shld Gas/Gas Csl	85 ft (25.9 m)
024115	Hose, Shld Gas/Gas Csl	100 ft (30.5 m)
024452	Hose, Shld Gas/Gas Csl	110 ft (33.6 m)
024449	Hose, Shld Gas/Gas Csl	115 ft (35.1 m)
024515	Hose, Shld Gas/Gas Csl	120 ft (36.6 m)
024395	Hose, Shld Gas/Gas Csl	125 ft (38.1 m)
024119	Hose, Shld Gas/Gas Csl	150 ft (45.8 m)
024480	Hose, Shld Gas/Gas Csl	170 ft (51.9 m)
024184	Hose, Shld Gas/Gas Csl	180 ft (54.9 m)
024123	Hose, Shld Gas/Gas Csl	200 ft (61 m)

**24 Argon/Hydrogen Console**

073109	Ar/H2 Csl	
--------	-----------	--

**25 Cable Between Argon/Hydrogen Csl and Power Supply**

023660	Cable, Ar-H2 Csl/PS	15 ft (4.6 m)
023661	Cable, Ar-H2 Csl/PS	25 ft (7.6 m)
023662	Cable, Ar-H2 Csl/PS	50 ft (15.3 m)
023663	Cable, Ar-H2 Csl/PS	75 ft (22.9 m)
023664	Cable, Ar-H2 Csl/PS	100 ft (30.5 m)
023665	Cable, Ar-H2 Csl/PS	150 ft (45.8 m)

**26 Hose Between Argon/Hydrogen Csl and Torch**

024354	Hose, Ar-H2 Csl/Trch	10 ft (3 m)
024355	Hose, Ar-H2 Csl/Trch	12 ft (3.7 m)
024368	Hose, Ar-H2 Csl/Trch	20 ft (6.1 m)
024369	Hose, Ar-H2 Csl/Trch	30 ft (9.2 m)
024370	Hose, Ar-H2 Csl/Trch	40 ft (12.2 m)
024443	Hose, Ar-H2 Csl/Trch	50 ft (15.3 m)
024467	Hose, Ar-H2 Csl/Trch	75 ft (22.9 m)

Figure 2-11 Steps 24 through 26



# ORDERING PROCEDURE

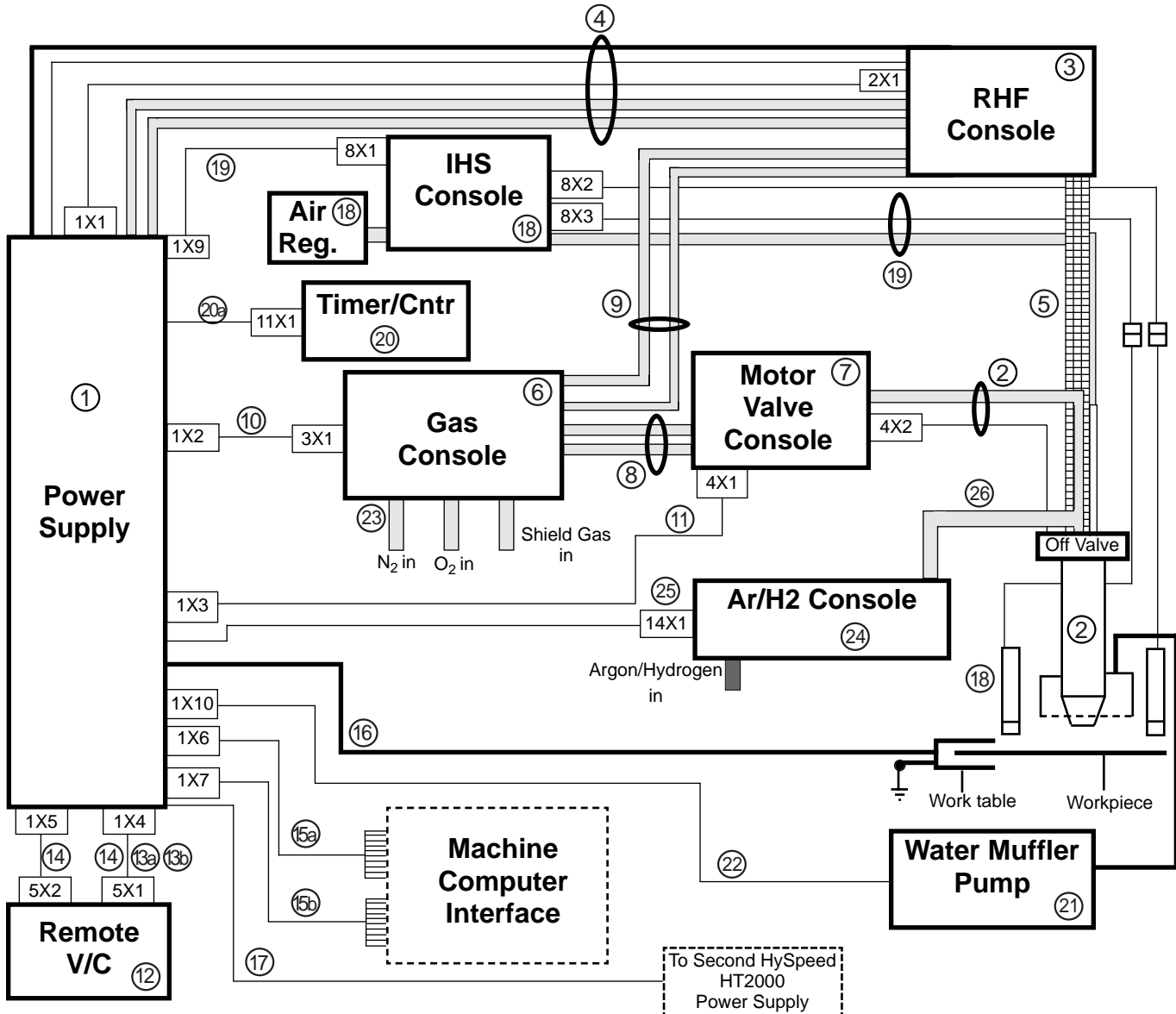

- |  |  |
|--|--|
| <ul style="list-style-type: none"> <li>1 Power Supply</li> <li>2 Torch Assembly</li> <li>3 Remote High Frequency Console</li> <li>4 Leads Between Power Supply and Remote High Frequency Console</li> <li>5 Shielded Leads Between PS and Dig. Remote</li> <li>6 Gas Console</li> <li>7 Motor Valve Console</li> <li>8 Leads Between Gas Console and Motor Valve Console</li> <li>9 Shield Gas Hose Set Between Gas Console and RHF Console</li> <li>10 Cable Between Gas Console and Power Supply</li> <li>11 Cable Between Motor Valve Console and Power Supply</li> <li>12 Remote Voltage/Current (V/C) Control</li> <li>13a Cable Between PS and Dig. Remote</li> <li>13b Cable Between PS and Current Remote</li> <li>14 Cables Between PS and Progr. Remote</li> <li>15a Cable Between PS and Machine Computer I/O Interface</li> <li>15b Cable Between PS and Machine Computer V/C Interface</li> </ul> | <ul style="list-style-type: none"> <li>16 Cable Between PS and Work Table</li> <li>17 Hold Cable Between Power Supplies in Multi-Torch Systems</li> <li>18 Inductive IHS System/Air Regulator/Mntg Brckt</li> <li>19 Inductive IHS Lead Set</li> <li>20 Timer / Counter</li> <li>20a Cable Between Tmr/Cntr and Power Supply</li> <li>21 Water Muffler System (not used with the S.S. torch)</li> <li>22 Cable Between Water Muffler Pump and Power Supply</li> <li>23 Hosing Between Supply Gases and Gas Console</li> <li>24 Argon/Hydrogen Console</li> <li>25 Cable Between Argon/Hydrogen Console and Power Supply</li> <li>26 Hose Between Argon/Hydrogen Console and Torch</li> </ul> |
|--|--|

HySpeed HT2000 System layout on page 2-23

Figure 2-12 Final System Interconnect with Options – Block Diagram

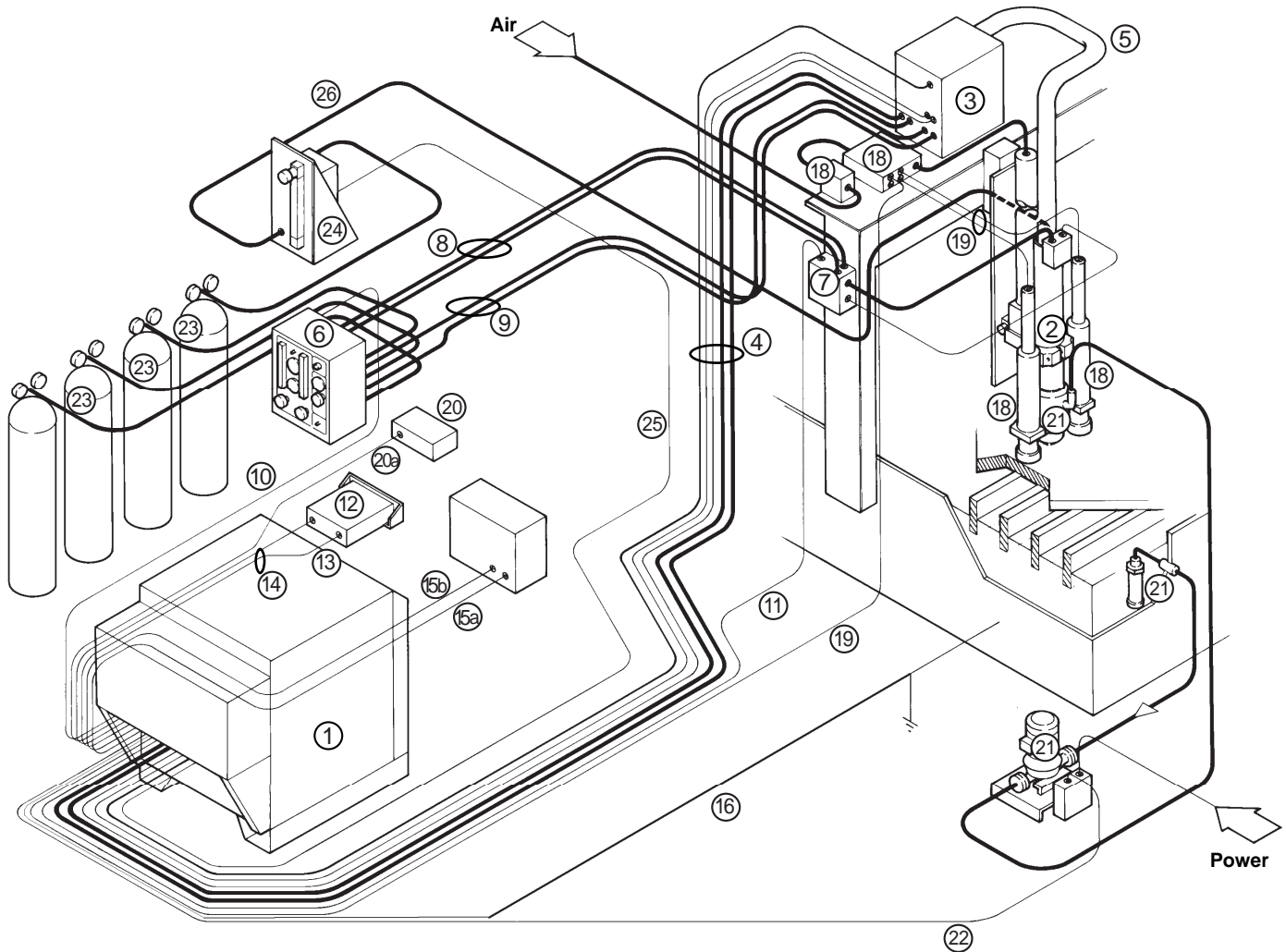

- |   |   |
|---|---|
| <ul style="list-style-type: none"> <li>1 Power Supply</li> <li>2 Torch Assembly</li> <li>3 Remote High Frequency Console</li> <li>4 Leads Between Power Supply and Remote High Frequency Csl</li> <li>5 Shielded Leads Between Torch and Remote High Frequency Csl</li> <li>6 Gas Console</li> <li>7 Motor Valve Console</li> <li>8 Leads Between Gas Csl and Motor Valve Csl</li> <li>9 Shield Gas Hose Set Between Gas Csl and RHF Csl</li> <li>10 Cable Between Gas Csl and Power Supply</li> <li>11 Cable Between Motor Valve Csl and Power Supply</li> <li>12 Remote Voltage/Current (V/C) Control</li> <li>13 Cable Between PS and Dig. Remote/Current Remote</li> <li>14 Cables Between PS and Progr. Remote</li> <li>15a Cable Between PS and Machine Computer I/O Interface</li> </ul> | <ul style="list-style-type: none"> <li>15b Cable Between PS and Machine Computer V/C Interface</li> <li>16 Cable Between PS and Work Table</li> <li>17* Hold Cable Between Power Supplies in Multi-Torch Systems</li> <li>18 Inductive IHS System/Air Regulator/Mntg Brckt</li> <li>19 Inductive IHS Lead Set</li> <li>20 Timer / Counter</li> <li>20a Cable Between Tmr/Cntr and Power Supply</li> <li>21 Water Muffer System</li> <li>22 Cable Between Water Muffer Pump and Power Supply</li> <li>23 Hosing Between Supply Gases and Gas Csl</li> <li>24 Argon/Hydrogen Console</li> <li>25 Cable Between Argon/Hydrogen Console and Power Supply</li> <li>26 Hose Between Argon/Hydrogen Console and Torch</li> </ul> |
|---|---|

\* Not Shown

Block Diagram representation on page 2-22

Figure 2-13 Final System Interconnect with Options – System Layout



Distributor Information:

HYPERTHERM  
HySpeed HT2000 Order Form

Customer Information:

① Power Supply \*

- 073063 Power Supply, 200V,60 Hz,w/THC
- 073064 Power Supply, 208V,60 Hz,w/THC
- 073065 Power Supply, 220/**380**/415V,50 Hz,w/THC
- 073198 Power Supply, 400V,CE,50 Hz,w/THC
- 073054 Power Supply, 240/**480**V,60 Hz,w/THC
- 073196 Power Supply, 440/**460**V,50-50 Hz,w/THC
- 073066 Power Supply, 575/**600**V,60 Hz,w/THC
  
- 073104 Power Supply, 200V,60 Hz,wo/THC
- 073105 Power Supply, 208V,60 Hz,wo/THC
- 073107 Power Supply, 220/**380**/415V,50 Hz,wo/THC
- 073199 Power Supply, 400V,CE,50 Hz,wo/THC
- 073106 Power Supply, 240/**480**V,60 Hz,wo/THC
- 073108 Power Supply, 575/**600**V,60 Hz,wo/THC

② Machine Torch Assembly with 2" Dia. Sleeve

- 128381 With HySpeed consumables

② Stainless Steel Machine Torch Assembly with 2" Dia. Sleeve

- 128367 With standard consumables

② Optional Machine Torch Assembly with 1-3/4" Dia. Sleeve

- 128141 With standard consumables

②a Torch Mounting Bracket – For 2" Dia. Sleeve

- 020046 Torch Mounting Bracket for 2" Dia. Sleeve

②a Torch Mounting Bracket – For 1-3/4" Dia. Sleeve

- 020522 Torch Mounting Bracket for 1-3/4" Dia. Sleeve

③ Remote High Frequency Console

- 073067 Rem. High Frequency Console

④ Leads Between PS and RHF Csl

- |  |  |
|--|--|
| <input type="checkbox"/> 028604 25 Ft  | <input type="checkbox"/> 028901 110 Ft |
| <input type="checkbox"/> 028605 50 Ft  | <input type="checkbox"/> 028895 115 Ft |
| <input type="checkbox"/> 128051 60 Ft  | <input type="checkbox"/> 128128 120 Ft |
| <input type="checkbox"/> 028606 75 Ft  | <input type="checkbox"/> 028746 125 Ft |
| <input type="checkbox"/> 128077 85 Ft  | <input type="checkbox"/> 028608 150 Ft |
| <input type="checkbox"/> 028607 100 Ft | <input type="checkbox"/> 028651 200 Ft |

⑤ Shielded Leads Between Torch and RHF Csl

- |                                       |  |
|---------------------------------------|--|
| <input type="checkbox"/> 028657 10 Ft | <input type="checkbox"/> 028662 40 Ft  |
| <input type="checkbox"/> 028658 15 Ft | <input type="checkbox"/> 028663 45 Ft  |
| <input type="checkbox"/> 028659 20 Ft | <input type="checkbox"/> 028547 50 Ft  |
| <input type="checkbox"/> 028546 25 Ft | <input type="checkbox"/> 028767 55 Ft  |
| <input type="checkbox"/> 028660 30 Ft | <input type="checkbox"/> 028608 150 Ft |
| <input type="checkbox"/> 028661 35 Ft | <input type="checkbox"/> 028768 60 Ft  |

⑥ Gas Console II

- 073218 Gas Console II

⑦ Motor Valve Console II

- 073219 Motor Valve Console II

⑧ Leads Between Gas Csl and Mtr Valve Csl

- |                                       |  |
|---------------------------------------|--|
| <input type="checkbox"/> 028622 10 Ft | <input type="checkbox"/> 028774 45 Ft  |
| <input type="checkbox"/> 028623 15 Ft | <input type="checkbox"/> 028654 50 Ft  |
| <input type="checkbox"/> 028624 20 Ft | <input type="checkbox"/> 028852 61 Ft  |
| <input type="checkbox"/> 028625 25 Ft | <input type="checkbox"/> 028655 75 Ft  |
| <input type="checkbox"/> 028626 30 Ft | <input type="checkbox"/> 028656 100 Ft |
| <input type="checkbox"/> 028627 35 Ft |  |

⑨ Shield Gas Hose Set – Gas Csl/RHF Csl

- |                                       |                                       |
|---------------------------------------|---------------------------------------|
| <input type="checkbox"/> 028683 10 Ft | <input type="checkbox"/> 028687 30 Ft |
| <input type="checkbox"/> 028684 15 Ft | <input type="checkbox"/> 028688 35 Ft |
| <input type="checkbox"/> 028685 20 Ft | <input type="checkbox"/> 028689 50 Ft |
| <input type="checkbox"/> 028686 25 Ft | <input type="checkbox"/> 128040 75 Ft |

⑩ Cable Between Gas Csl and PS

- |                                       |  |
|---------------------------------------|--|
| <input type="checkbox"/> 023989 10 Ft | <input type="checkbox"/> 123077 85 Ft  |
| <input type="checkbox"/> 023549 15 Ft | <input type="checkbox"/> 023608 100 Ft |
| <input type="checkbox"/> 023605 25 Ft | <input type="checkbox"/> 023963 115 Ft |
| <input type="checkbox"/> 023757 38 Ft | <input type="checkbox"/> 123147 120 Ft |
| <input type="checkbox"/> 023606 50 Ft | <input type="checkbox"/> 023743 125 Ft |
| <input type="checkbox"/> 123044 60 Ft | <input type="checkbox"/> 023609 150 Ft |
| <input type="checkbox"/> 023607 75 Ft | <input type="checkbox"/> 023953 200 Ft |

\*Power supply voltages are factory pre-set. See bold type under ①

Please specify for optional voltage. \_\_\_\_\_

⑪ Cable Between Mtr Vlv Csl and PS

- |                                       |  |
|---------------------------------------|--|
| <input type="checkbox"/> 023551 15 Ft | <input type="checkbox"/> 023593 100 Ft |
| <input type="checkbox"/> 023590 25 Ft | <input type="checkbox"/> 123078 110 Ft |
| <input type="checkbox"/> 023776 35 Ft | <input type="checkbox"/> 023967 120 Ft |
| <input type="checkbox"/> 023591 50 Ft | <input type="checkbox"/> 123143 130 Ft |
| <input type="checkbox"/> 023592 75 Ft | <input type="checkbox"/> 023594 150 Ft |
| <input type="checkbox"/> 123045 85 Ft | <input type="checkbox"/> 023658 200 Ft |

⑫ Remote Voltage/Current (V/C) Control

- 073007 Control, Digital V/C (DR)
- 055004 Control, Programmable V/C (PR)
- 073045 Control, Remote Current

⑬a Cable Between PS and Digital Remote

- |  |  |
|--|--|
| <input type="checkbox"/> 023990 7 Ft   | <input type="checkbox"/> 123188 120 Ft |
| <input type="checkbox"/> 023911 15 Ft  | <input type="checkbox"/> 023882 125 Ft |
| <input type="checkbox"/> 023878 25 Ft  | <input type="checkbox"/> 023883 150 Ft |
| <input type="checkbox"/> 023879 50 Ft  | <input type="checkbox"/> 023884 200 Ft |
| <input type="checkbox"/> 123040 60 Ft  | <input type="checkbox"/> 023885 250 Ft |
| <input type="checkbox"/> 023880 75 Ft  | <input type="checkbox"/> 023886 275 Ft |
| <input type="checkbox"/> 123073 85 Ft  | <input type="checkbox"/> 023887 300 Ft |
| <input type="checkbox"/> 023881 100 Ft |  |

⑬b Cable Between PS and Current Remote

- |  |  |
|--|--|
| <input type="checkbox"/> 123150 10 Ft  | <input type="checkbox"/> 123068 110 Ft |
| <input type="checkbox"/> 023871 25 Ft  | <input type="checkbox"/> 123088 125 Ft |
| <input type="checkbox"/> 023872 38 Ft  | <input type="checkbox"/> 023876 150 Ft |
| <input type="checkbox"/> 023873 50 Ft  | <input type="checkbox"/> 123032 170 Ft |
| <input type="checkbox"/> 023874 75 Ft  | <input type="checkbox"/> 023877 200 Ft |
| <input type="checkbox"/> 023875 100 Ft |  |

⑭ Cables Between PS and Prog. Remote

- |  |  |
|--|--|
| <input type="checkbox"/> 028831 15 Ft  | <input type="checkbox"/> 028613 150 Ft |
| <input type="checkbox"/> 028609 25 Ft  | <input type="checkbox"/> 028614 200 Ft |
| <input type="checkbox"/> 028610 50 Ft  | <input type="checkbox"/> 028833 250 Ft |
| <input type="checkbox"/> 028611 75 Ft  | <input type="checkbox"/> 028834 275 Ft |
| <input type="checkbox"/> 028612 100 Ft | <input type="checkbox"/> 028835 300 Ft |
| <input type="checkbox"/> 028832 125 Ft |  |

**15a) Cable Between PS and Mach. Comp. I/O Int.**

- |                                       |   |
|---------------------------------------|---|
| <input type="checkbox"/> 023841 6 Ft  | <input type="checkbox"/> 123080 85 Ft   |
| <input type="checkbox"/> 023842 15 Ft | <input type="checkbox"/> 0023847 100 Ft |
| <input type="checkbox"/> 023843 25 Ft | <input type="checkbox"/> 023962 115 Ft  |
| <input type="checkbox"/> 023844 35 Ft | <input type="checkbox"/> 123148 120 Ft  |
| <input type="checkbox"/> 023845 50 Ft | <input type="checkbox"/> 023848 125 Ft  |
| <input type="checkbox"/> 123047 60 Ft | <input type="checkbox"/> 023849 150 Ft  |
| <input type="checkbox"/> 023846 75 Ft | <input type="checkbox"/> 023850 200 Ft  |

**15b) Cable Between PS and Mach. Comp. V/C Int.**

- |                                       |  |
|---------------------------------------|--|
| <input type="checkbox"/> 023902 6 Ft  | <input type="checkbox"/> 023855 75 Ft  |
| <input type="checkbox"/> 023851 15 Ft | <input type="checkbox"/> 023856 100 Ft |
| <input type="checkbox"/> 023852 25 Ft | <input type="checkbox"/> 023903 125 Ft |
| <input type="checkbox"/> 023853 35 Ft | <input type="checkbox"/> 023857 150 Ft |
| <input type="checkbox"/> 023854 50 Ft | <input type="checkbox"/> 023858 200 Ft |

**16) Cable Between PS and Work Table**

- |                                       |                                       |
|---------------------------------------|---------------------------------------|
| <input type="checkbox"/> 023755 4 Ft  | <input type="checkbox"/> 023404 25 Ft |
| <input type="checkbox"/> 023920 8 Ft  | <input type="checkbox"/> 023968 30 Ft |
| <input type="checkbox"/> 023508 10 Ft | <input type="checkbox"/> 023986 35 Ft |
| <input type="checkbox"/> 023403 15 Ft | <input type="checkbox"/> 023405 50 Ft |

**17) Hold Cable Between Power Supplies**

- |                                       |  |
|---------------------------------------|--|
| <input type="checkbox"/> 023340 15 Ft | <input type="checkbox"/> 023343 100 Ft |
| <input type="checkbox"/> 023341 25 Ft | <input type="checkbox"/> 023344 150 Ft |
| <input type="checkbox"/> 023342 50 Ft |  |

**18) Ind. Initial Height Sensing (IHS) System for 2" Torch**

- 028720 IHS System, Inductive for 2" Dia. Torch

**18) Ind. Initial Height Sensing (IHS) System for 1-3/4" Torch**

- 028390 IHS System, Inductive for 1-3/4" Dia. Torch

**18a) IHS Pressure Regulator Assembly**

- 029758 IHS Pressure Regulator SA

**19) Inductive IHS Lead Set**

- |                                       |  |
|---------------------------------------|--|
| <input type="checkbox"/> 028811 25 Ft | <input type="checkbox"/> 028814 100 Ft |
| <input type="checkbox"/> 028812 50 Ft | <input type="checkbox"/> 028815 150 Ft |
| <input type="checkbox"/> 028813 75 Ft | <input type="checkbox"/> 028816 200 Ft |

**20) Timer/Counter**

- 073194 Tmr-Cntr

**20a) Cable Between Timer/Counter and PS**

- |                                       |  |
|---------------------------------------|--|
| <input type="checkbox"/> 023687 10 Ft | <input type="checkbox"/> 123079 85 Ft  |
| <input type="checkbox"/> 023692 25 Ft | <input type="checkbox"/> 023695 100 Ft |
| <input type="checkbox"/> 023758 38 Ft | <input type="checkbox"/> 023993 115 Ft |
| <input type="checkbox"/> 023693 50 Ft | <input type="checkbox"/> 123189 120 Ft |
| <input type="checkbox"/> 123046 60 Ft | <input type="checkbox"/> 023696 150 Ft |
| <input type="checkbox"/> 023694 75 Ft | <input type="checkbox"/> 023954 200 Ft |

**21) Water Muffler System-with Hoses (not used with stnls. steel torch)**

- |  |                     |
|--|---------------------|
| <input type="checkbox"/> 034096 WM Sys/w hoses | 240/480V, 3Ø, 60 Hz |
| <input type="checkbox"/> 034100 WM Sys/w hoses | 380/415V, 3Ø, 60 Hz |
| <input type="checkbox"/> 034098 WM Sys/w hoses | 600V, 3Ø, 60 Hz     |

**21) Water Muffler System-without Hoses (not used with stnls. steel torch)**

- |   |                     |
|---|---------------------|
| <input type="checkbox"/> 034097 WM Sys/wo hoses | 240/480V, 3Ø, 60 H  |
| <input type="checkbox"/> 034101 WM Sys/wo hoses | 380/415V, 3Ø, 60 Hz |
| <input type="checkbox"/> 034099 WM Sys/wo hoses | 600V, 3Ø, 60 Hz     |

**21a) Additional Length WM Hose, Specify Length (Ft)**

- 034051 Add'l Length W-M Hose (Qty in Ft.)

**22) Cable Between WM Pump and Power Supply**

- |  |
|--|
| <input type="checkbox"/> 023866 50 Ft  |
| <input type="checkbox"/> 023867 75 Ft  |
| <input type="checkbox"/> 023868 100 Ft |

**23a) Hose Between O<sub>2</sub> Supply and Gas Csl**

- |  |  |
|--|--|
| <input type="checkbox"/> 024204 15 Ft  | <input type="checkbox"/> 024450 115 Ft |
| <input type="checkbox"/> 024205 25 Ft  | <input type="checkbox"/> 024516 120 Ft |
| <input type="checkbox"/> 024155 50 Ft  | <input type="checkbox"/> 024490 125 Ft |
| <input type="checkbox"/> 024398 75 Ft  | <input type="checkbox"/> 024159 150 Ft |
| <input type="checkbox"/> 024487 85 Ft  | <input type="checkbox"/> 024470 180 Ft |
| <input type="checkbox"/> 024206 100 Ft | <input type="checkbox"/> 024333 200 Ft |
| <input type="checkbox"/> 024481 110 Ft |  |

**23b) Hose Between N<sub>2</sub> Supply and Gas Csl**

- |                                       |  |
|---------------------------------------|--|
| <input type="checkbox"/> 024505 6 Ft  | <input type="checkbox"/> 024116 100 Ft |
| <input type="checkbox"/> 024210 10 Ft | <input type="checkbox"/> 024482 110 Ft |
| <input type="checkbox"/> 024203 15 Ft | <input type="checkbox"/> 024451 115 Ft |
| <input type="checkbox"/> 024232 20 Ft | <input type="checkbox"/> 024517 120 Ft |
| <input type="checkbox"/> 024134 25 Ft | <input type="checkbox"/> 024491 125 Ft |
| <input type="checkbox"/> 024211 35 Ft | <input type="checkbox"/> 024120 150 Ft |
| <input type="checkbox"/> 024112 50 Ft | <input type="checkbox"/> 024185 180 Ft |
| <input type="checkbox"/> 024148 75 Ft | <input type="checkbox"/> 024124 200 Ft |
| <input type="checkbox"/> 024488 85 Ft |  |

**23c) Hose Between Shield Gas Supply and Gas Csl**

- |                                       |  |
|---------------------------------------|--|
| <input type="checkbox"/> 024043 4 Ft  | <input type="checkbox"/> 024486 85 Ft  |
| <input type="checkbox"/> 024341 10 Ft | <input type="checkbox"/> 024115 100 Ft |
| <input type="checkbox"/> 024200 15 Ft | <input type="checkbox"/> 024452 110 Ft |
| <input type="checkbox"/> 024342 20 Ft | <input type="checkbox"/> 024449 115 Ft |
| <input type="checkbox"/> 024133 25 Ft | <input type="checkbox"/> 024515 120 Ft |
| <input type="checkbox"/> 024448 35 Ft | <input type="checkbox"/> 024395 125 Ft |
| <input type="checkbox"/> 024407 45 Ft | <input type="checkbox"/> 024119 150 Ft |
| <input type="checkbox"/> 024012 50 Ft | <input type="checkbox"/> 024480 170 Ft |
| <input type="checkbox"/> 024472 60 Ft | <input type="checkbox"/> 024184 180 Ft |
| <input type="checkbox"/> 024147 75 Ft | <input type="checkbox"/> 024123 200 Ft |

**24) Argon/Hydrogen Console**

- 073109 Ar/H2 Csl

**25) Cable Between Ar/H2 Csl and PS**

- |                                       |  |
|---------------------------------------|--|
| <input type="checkbox"/> 023660 15 Ft | <input type="checkbox"/> 023663 75 Ft  |
| <input type="checkbox"/> 023661 25 Ft | <input type="checkbox"/> 023664 100 Ft |
| <input type="checkbox"/> 023662 50 Ft | <input type="checkbox"/> 023665 150 Ft |

**26) Hose Between Ar/H2 Csl and Trch**

- |                                       |                                       |
|---------------------------------------|---------------------------------------|
| <input type="checkbox"/> 024354 10 Ft | <input type="checkbox"/> 024370 40 Ft |
| <input type="checkbox"/> 024355 12 Ft | <input type="checkbox"/> 024443 50 Ft |
| <input type="checkbox"/> 024368 20 Ft | <input type="checkbox"/> 024467 75 Ft |
| <input type="checkbox"/> 024369 30 Ft |                                       |

**Spare Parts Kit**

- |                                 |                           |
|---------------------------------|---------------------------|
| <input type="checkbox"/> 128825 | Kit: HySpeed consumables  |
| <input type="checkbox"/> 028602 | Kit: Standard consumables |

Distributor Information:

HYPERTHERM  
HySpeed HT2000 Order Form

Customer Information:

① Power Supply \*

- 073063 Power Supply, 200V,60 Hz,w/THC
- 073064 Power Supply, 208V,60 Hz,w/THC
- 073065 Power Supply, 220/**380**/415V,50 Hz,w/THC
- 073198 Power Supply, 400V,CE,50 Hz,w/THC
- 073054 Power Supply, 240/**480**V,60 Hz,w/THC
- 073196 Power Supply, 440/**460**V,50-50 Hz,w/THC
- 073066 Power Supply, 575/**600**V,60 Hz,w/THC
  
- 073104 Power Supply, 200V,60 Hz,wo/THC
- 073105 Power Supply, 208V,60 Hz,wo/THC
- 073107 Power Supply, 220/**380**/415V,50 Hz,wo/THC
- 073199 Power Supply, 400V,CE,50 Hz,wo/THC
- 073106 Power Supply, 240/**480**V,60 Hz,wo/THC
- 073108 Power Supply, 575/**600**V,60 Hz,wo/THC

② Machine Torch Assembly with 2" Dia. Sleeve

- 128381 With HySpeed consumables

② Stainless Steel Machine Torch Assembly with 2" Dia. Sleeve

- 128367 With standard consumables

② Optional Machine Torch Assembly with 1-3/4" Dia. Sleeve

- 128141 With standard consumables

②a Torch Mounting Bracket – For 2" Dia. Sleeve

- 020046 Torch Mounting Bracket for 2" Dia. Sleeve

②a Torch Mounting Bracket – For 1-3/4" Dia. Sleeve

- 020522 Torch Mounting Bracket for 1-3/4" Dia. Sleeve

③ Remote High Frequency Console

- 073067 Rem. High Frequency Console

④ Leads Between PS and RHF Csl

- |  |  |
|--|--|
| <input type="checkbox"/> 028604 25 Ft  | <input type="checkbox"/> 028901 110 Ft |
| <input type="checkbox"/> 028605 50 Ft  | <input type="checkbox"/> 028895 115 Ft |
| <input type="checkbox"/> 128051 60 Ft  | <input type="checkbox"/> 128128 120 Ft |
| <input type="checkbox"/> 028606 75 Ft  | <input type="checkbox"/> 028746 125 Ft |
| <input type="checkbox"/> 128077 85 Ft  | <input type="checkbox"/> 028608 150 Ft |
| <input type="checkbox"/> 028607 100 Ft | <input type="checkbox"/> 028651 200 Ft |

⑤ Shielded Leads Between Torch and RHF Csl

- |                                       |  |
|---------------------------------------|--|
| <input type="checkbox"/> 028657 10 Ft | <input type="checkbox"/> 028662 40 Ft  |
| <input type="checkbox"/> 028658 15 Ft | <input type="checkbox"/> 028663 45 Ft  |
| <input type="checkbox"/> 028659 20 Ft | <input type="checkbox"/> 028547 50 Ft  |
| <input type="checkbox"/> 028546 25 Ft | <input type="checkbox"/> 028767 55 Ft  |
| <input type="checkbox"/> 028660 30 Ft | <input type="checkbox"/> 028608 150 Ft |
| <input type="checkbox"/> 028661 35 Ft | <input type="checkbox"/> 028768 60 Ft  |

⑥ Gas Console II

- 073218 Gas Console II

⑦ Motor Valve Console II

- 073219 Motor Valve Console II

⑧ Leads Between Gas Csl and Mtr Valve Csl

- |                                       |  |
|---------------------------------------|--|
| <input type="checkbox"/> 028622 10 Ft | <input type="checkbox"/> 028774 45 Ft  |
| <input type="checkbox"/> 028623 15 Ft | <input type="checkbox"/> 028654 50 Ft  |
| <input type="checkbox"/> 028624 20 Ft | <input type="checkbox"/> 028852 61 Ft  |
| <input type="checkbox"/> 028625 25 Ft | <input type="checkbox"/> 028655 75 Ft  |
| <input type="checkbox"/> 028626 30 Ft | <input type="checkbox"/> 028656 100 Ft |
| <input type="checkbox"/> 028627 35 Ft |  |

⑨ Shield Gas Hose Set – Gas Csl/RHF Csl

- |                                       |                                       |
|---------------------------------------|---------------------------------------|
| <input type="checkbox"/> 028683 10 Ft | <input type="checkbox"/> 028687 30 Ft |
| <input type="checkbox"/> 028684 15 Ft | <input type="checkbox"/> 028688 35 Ft |
| <input type="checkbox"/> 028685 20 Ft | <input type="checkbox"/> 028689 50 Ft |
| <input type="checkbox"/> 028686 25 Ft | <input type="checkbox"/> 128040 75 Ft |

⑩ Cable Between Gas Csl and PS

- |                                       |  |
|---------------------------------------|--|
| <input type="checkbox"/> 023989 10 Ft | <input type="checkbox"/> 123077 85 Ft  |
| <input type="checkbox"/> 023549 15 Ft | <input type="checkbox"/> 023608 100 Ft |
| <input type="checkbox"/> 023605 25 Ft | <input type="checkbox"/> 023963 115 Ft |
| <input type="checkbox"/> 023757 38 Ft | <input type="checkbox"/> 123147 120 Ft |
| <input type="checkbox"/> 023606 50 Ft | <input type="checkbox"/> 023743 125 Ft |
| <input type="checkbox"/> 123044 60 Ft | <input type="checkbox"/> 023609 150 Ft |
| <input type="checkbox"/> 023607 75 Ft | <input type="checkbox"/> 023953 200 Ft |

\*Power supply voltages are factory pre-set. See bold type under ①

Please specify for optional voltage. \_\_\_\_\_

⑪ Cable Between Mtr Vlv Csl and PS

- |                                       |  |
|---------------------------------------|--|
| <input type="checkbox"/> 023551 15 Ft | <input type="checkbox"/> 023593 100 Ft |
| <input type="checkbox"/> 023590 25 Ft | <input type="checkbox"/> 123078 110 Ft |
| <input type="checkbox"/> 023776 35 Ft | <input type="checkbox"/> 023967 120 Ft |
| <input type="checkbox"/> 023591 50 Ft | <input type="checkbox"/> 123143 130 Ft |
| <input type="checkbox"/> 023592 75 Ft | <input type="checkbox"/> 023594 150 Ft |
| <input type="checkbox"/> 123045 85 Ft | <input type="checkbox"/> 023658 200 Ft |

⑫ Remote Voltage/Current (V/C) Control

- 073007 Control, Digital V/C (DR)
- 055004 Control, Programmable V/C (PR)
- 073045 Control, Remote Current

⑬a Cable Between PS and Digital Remote

- |  |  |
|--|--|
| <input type="checkbox"/> 023990 7 Ft   | <input type="checkbox"/> 123188 120 Ft |
| <input type="checkbox"/> 023911 15 Ft  | <input type="checkbox"/> 023882 125 Ft |
| <input type="checkbox"/> 023878 25 Ft  | <input type="checkbox"/> 023883 150 Ft |
| <input type="checkbox"/> 023879 50 Ft  | <input type="checkbox"/> 023884 200 Ft |
| <input type="checkbox"/> 123040 60 Ft  | <input type="checkbox"/> 023885 250 Ft |
| <input type="checkbox"/> 023880 75 Ft  | <input type="checkbox"/> 023886 275 Ft |
| <input type="checkbox"/> 123073 85 Ft  | <input type="checkbox"/> 023887 300 Ft |
| <input type="checkbox"/> 023881 100 Ft |  |

⑬b Cable Between PS and Current Remote

- |  |  |
|--|--|
| <input type="checkbox"/> 123150 10 Ft  | <input type="checkbox"/> 123068 110 Ft |
| <input type="checkbox"/> 023871 25 Ft  | <input type="checkbox"/> 123088 125 Ft |
| <input type="checkbox"/> 023872 38 Ft  | <input type="checkbox"/> 023876 150 Ft |
| <input type="checkbox"/> 023873 50 Ft  | <input type="checkbox"/> 123032 170 Ft |
| <input type="checkbox"/> 023874 75 Ft  | <input type="checkbox"/> 023877 200 Ft |
| <input type="checkbox"/> 023875 100 Ft |  |

⑭ Cables Between PS and Prog. Remote

- |  |  |
|--|--|
| <input type="checkbox"/> 028831 15 Ft  | <input type="checkbox"/> 028613 150 Ft |
| <input type="checkbox"/> 028609 25 Ft  | <input type="checkbox"/> 028614 200 Ft |
| <input type="checkbox"/> 028610 50 Ft  | <input type="checkbox"/> 028833 250 Ft |
| <input type="checkbox"/> 028611 75 Ft  | <input type="checkbox"/> 028834 275 Ft |
| <input type="checkbox"/> 028612 100 Ft | <input type="checkbox"/> 028835 300 Ft |
| <input type="checkbox"/> 028832 125 Ft |  |

**15a) Cable Between PS and Mach. Comp. I/O Int.**

- |                                       |   |
|---------------------------------------|---|
| <input type="checkbox"/> 023841 6 Ft  | <input type="checkbox"/> 123080 85 Ft   |
| <input type="checkbox"/> 023842 15 Ft | <input type="checkbox"/> 0023847 100 Ft |
| <input type="checkbox"/> 023843 25 Ft | <input type="checkbox"/> 023962 115 Ft  |
| <input type="checkbox"/> 023844 35 Ft | <input type="checkbox"/> 123148 120 Ft  |
| <input type="checkbox"/> 023845 50 Ft | <input type="checkbox"/> 023848 125 Ft  |
| <input type="checkbox"/> 123047 60 Ft | <input type="checkbox"/> 023849 150 Ft  |
| <input type="checkbox"/> 023846 75 Ft | <input type="checkbox"/> 023850 200 Ft  |

**15b) Cable Between PS and Mach. Comp. V/C Int.**

- |                                       |  |
|---------------------------------------|--|
| <input type="checkbox"/> 023902 6 Ft  | <input type="checkbox"/> 023855 75 Ft  |
| <input type="checkbox"/> 023851 15 Ft | <input type="checkbox"/> 023856 100 Ft |
| <input type="checkbox"/> 023852 25 Ft | <input type="checkbox"/> 023903 125 Ft |
| <input type="checkbox"/> 023853 35 Ft | <input type="checkbox"/> 023857 150 Ft |
| <input type="checkbox"/> 023854 50 Ft | <input type="checkbox"/> 023858 200 Ft |

**16) Cable Between PS and Work Table**

- |                                       |                                       |
|---------------------------------------|---------------------------------------|
| <input type="checkbox"/> 023755 4 Ft  | <input type="checkbox"/> 023404 25 Ft |
| <input type="checkbox"/> 023920 8 Ft  | <input type="checkbox"/> 023968 30 Ft |
| <input type="checkbox"/> 023508 10 Ft | <input type="checkbox"/> 023986 35 Ft |
| <input type="checkbox"/> 023403 15 Ft | <input type="checkbox"/> 023405 50 Ft |

**17) Hold Cable Between Power Supplies**

- |                                       |  |
|---------------------------------------|--|
| <input type="checkbox"/> 023340 15 Ft | <input type="checkbox"/> 023343 100 Ft |
| <input type="checkbox"/> 023341 25 Ft | <input type="checkbox"/> 023344 150 Ft |
| <input type="checkbox"/> 023342 50 Ft |  |

**18) Ind. Initial Height Sensing (IHS) System for 2" Torch**

- 028720 IHS System, Inductive for 2" Dia. Torch

**18) Ind. Initial Height Sensing (IHS) System for 1-3/4" Torch**

- 028390 IHS System, Inductive for 1-3/4" Dia. Torch

**18a) IHS Pressure Regulator Assembly**

- 029758 IHS Pressure Regulator SA

**19) Inductive IHS Lead Set**

- |                                       |  |
|---------------------------------------|--|
| <input type="checkbox"/> 028811 25 Ft | <input type="checkbox"/> 028814 100 Ft |
| <input type="checkbox"/> 028812 50 Ft | <input type="checkbox"/> 028815 150 Ft |
| <input type="checkbox"/> 028813 75 Ft | <input type="checkbox"/> 028816 200 Ft |

**20) Timer/Counter**

- 073194 Tmr-Cntr

**20a) Cable Between Timer/Counter and PS**

- |                                       |  |
|---------------------------------------|--|
| <input type="checkbox"/> 023687 10 Ft | <input type="checkbox"/> 123079 85 Ft  |
| <input type="checkbox"/> 023692 25 Ft | <input type="checkbox"/> 023695 100 Ft |
| <input type="checkbox"/> 023758 38 Ft | <input type="checkbox"/> 023993 115 Ft |
| <input type="checkbox"/> 023693 50 Ft | <input type="checkbox"/> 123189 120 Ft |
| <input type="checkbox"/> 123046 60 Ft | <input type="checkbox"/> 023696 150 Ft |
| <input type="checkbox"/> 023694 75 Ft | <input type="checkbox"/> 023954 200 Ft |

**21) Water Muffler System-with Hoses (not used with stnls. steel torch)**

- |  |                     |
|--|---------------------|
| <input type="checkbox"/> 034096 WM Sys/w hoses | 240/480V, 3Ø, 60 Hz |
| <input type="checkbox"/> 034100 WM Sys/w hoses | 380/415V, 3Ø, 60 Hz |
| <input type="checkbox"/> 034098 WM Sys/w hoses | 600V, 3Ø, 60 Hz     |

**21) Water Muffler System-without Hoses (not used with stnls. steel torch)**

- |   |                     |
|---|---------------------|
| <input type="checkbox"/> 034097 WM Sys/wo hoses | 240/480V, 3Ø, 60 H  |
| <input type="checkbox"/> 034101 WM Sys/wo hoses | 380/415V, 3Ø, 60 Hz |
| <input type="checkbox"/> 034099 WM Sys/wo hoses | 600V, 3Ø, 60 Hz     |

**21a) Additional Length WM Hose, Specify Length (Ft)**

- 034051 Add'l Length W-M Hose (Qty in Ft.)

**22) Cable Between WM Pump and Power Supply**

- |  |
|--|
| <input type="checkbox"/> 023866 50 Ft  |
| <input type="checkbox"/> 023867 75 Ft  |
| <input type="checkbox"/> 023868 100 Ft |

**23a) Hose Between O<sub>2</sub> Supply and Gas Csl**

- |  |  |
|--|--|
| <input type="checkbox"/> 024204 15 Ft  | <input type="checkbox"/> 024450 115 Ft |
| <input type="checkbox"/> 024205 25 Ft  | <input type="checkbox"/> 024516 120 Ft |
| <input type="checkbox"/> 024155 50 Ft  | <input type="checkbox"/> 024490 125 Ft |
| <input type="checkbox"/> 024398 75 Ft  | <input type="checkbox"/> 024159 150 Ft |
| <input type="checkbox"/> 024487 85 Ft  | <input type="checkbox"/> 024470 180 Ft |
| <input type="checkbox"/> 024206 100 Ft | <input type="checkbox"/> 024333 200 Ft |
| <input type="checkbox"/> 024481 110 Ft |  |

**23b) Hose Between N<sub>2</sub> Supply and Gas Csl**

- |                                       |  |
|---------------------------------------|--|
| <input type="checkbox"/> 024505 6 Ft  | <input type="checkbox"/> 024116 100 Ft |
| <input type="checkbox"/> 024210 10 Ft | <input type="checkbox"/> 024482 110 Ft |
| <input type="checkbox"/> 024203 15 Ft | <input type="checkbox"/> 024451 115 Ft |
| <input type="checkbox"/> 024232 20 Ft | <input type="checkbox"/> 024517 120 Ft |
| <input type="checkbox"/> 024134 25 Ft | <input type="checkbox"/> 024491 125 Ft |
| <input type="checkbox"/> 024211 35 Ft | <input type="checkbox"/> 024120 150 Ft |
| <input type="checkbox"/> 024112 50 Ft | <input type="checkbox"/> 024185 180 Ft |
| <input type="checkbox"/> 024148 75 Ft | <input type="checkbox"/> 024124 200 Ft |
| <input type="checkbox"/> 024488 85 Ft |  |

**23c) Hose Between Shield Gas Supply and Gas Csl**

- |                                       |  |
|---------------------------------------|--|
| <input type="checkbox"/> 024043 4 Ft  | <input type="checkbox"/> 024486 85 Ft  |
| <input type="checkbox"/> 024341 10 Ft | <input type="checkbox"/> 024115 100 Ft |
| <input type="checkbox"/> 024200 15 Ft | <input type="checkbox"/> 024452 110 Ft |
| <input type="checkbox"/> 024342 20 Ft | <input type="checkbox"/> 024449 115 Ft |
| <input type="checkbox"/> 024133 25 Ft | <input type="checkbox"/> 024515 120 Ft |
| <input type="checkbox"/> 024448 35 Ft | <input type="checkbox"/> 024395 125 Ft |
| <input type="checkbox"/> 024407 45 Ft | <input type="checkbox"/> 024119 150 Ft |
| <input type="checkbox"/> 024012 50 Ft | <input type="checkbox"/> 024480 170 Ft |
| <input type="checkbox"/> 024472 60 Ft | <input type="checkbox"/> 024184 180 Ft |
| <input type="checkbox"/> 024147 75 Ft | <input type="checkbox"/> 024123 200 Ft |

**24) Argon/Hydrogen Console**

- 073109 Ar/H2 Csl

**25) Cable Between Ar/H2 Csl and PS**

- |                                       |  |
|---------------------------------------|--|
| <input type="checkbox"/> 023660 15 Ft | <input type="checkbox"/> 023663 75 Ft  |
| <input type="checkbox"/> 023661 25 Ft | <input type="checkbox"/> 023664 100 Ft |
| <input type="checkbox"/> 023662 50 Ft | <input type="checkbox"/> 023665 150 Ft |

**26) Hose Between Ar/H2 Csl and Trch**

- |                                       |                                       |
|---------------------------------------|---------------------------------------|
| <input type="checkbox"/> 024354 10 Ft | <input type="checkbox"/> 024370 40 Ft |
| <input type="checkbox"/> 024355 12 Ft | <input type="checkbox"/> 024443 50 Ft |
| <input type="checkbox"/> 024368 20 Ft | <input type="checkbox"/> 024467 75 Ft |
| <input type="checkbox"/> 024369 30 Ft |                                       |

**Spare Parts Kit**

- |                                 |                           |
|---------------------------------|---------------------------|
| <input type="checkbox"/> 128825 | Kit: HySpeed consumables  |
| <input type="checkbox"/> 028602 | Kit: Standard consumables |

Distributor Information:

HYPERTHERM  
HySpeed HT2000 Order Form

Customer Information:

① Power Supply \*

- 073063 Power Supply, 200V,60 Hz,w/THC
- 073064 Power Supply, 208V,60 Hz,w/THC
- 073065 Power Supply, 220/**380**/415V,50 Hz,w/THC
- 073198 Power Supply, 400V,CE,50 Hz,w/THC
- 073054 Power Supply, 240/**480**V,60 Hz,w/THC
- 073196 Power Supply, 440/**460**V,50-50 Hz,w/THC
- 073066 Power Supply, 575/**600**V,60 Hz,w/THC
  
- 073104 Power Supply, 200V,60 Hz,wo/THC
- 073105 Power Supply, 208V,60 Hz,wo/THC
- 073107 Power Supply, 220/**380**/415V,50 Hz,wo/THC
- 073199 Power Supply, 400V,CE,50 Hz,wo/THC
- 073106 Power Supply, 240/**480**V,60 Hz,wo/THC
- 073108 Power Supply, 575/**600**V,60 Hz,wo/THC

② Machine Torch Assembly with 2" Dia. Sleeve

- 128381 With HySpeed consumables

② Stainless Steel Machine Torch Assembly with 2" Dia. Sleeve

- 128367 With standard consumables

② Optional Machine Torch Assembly with 1-3/4" Dia. Sleeve

- 128141 With standard consumables

②a Torch Mounting Bracket – For 2" Dia. Sleeve

- 020046 Torch Mounting Bracket for 2" Dia. Sleeve

②a Torch Mounting Bracket – For 1-3/4" Dia. Sleeve

- 020522 Torch Mounting Bracket for 1-3/4" Dia. Sleeve

③ Remote High Frequency Console

- 073067 Rem. High Frequency Console

④ Leads Between PS and RHF Csl

- |  |  |
|--|--|
| <input type="checkbox"/> 028604 25 Ft  | <input type="checkbox"/> 028901 110 Ft |
| <input type="checkbox"/> 028605 50 Ft  | <input type="checkbox"/> 028895 115 Ft |
| <input type="checkbox"/> 128051 60 Ft  | <input type="checkbox"/> 128128 120 Ft |
| <input type="checkbox"/> 028606 75 Ft  | <input type="checkbox"/> 028746 125 Ft |
| <input type="checkbox"/> 128077 85 Ft  | <input type="checkbox"/> 028608 150 Ft |
| <input type="checkbox"/> 028607 100 Ft | <input type="checkbox"/> 028651 200 Ft |

⑤ Shielded Leads Between Torch and RHF Csl

- |                                       |  |
|---------------------------------------|--|
| <input type="checkbox"/> 028657 10 Ft | <input type="checkbox"/> 028662 40 Ft  |
| <input type="checkbox"/> 028658 15 Ft | <input type="checkbox"/> 028663 45 Ft  |
| <input type="checkbox"/> 028659 20 Ft | <input type="checkbox"/> 028547 50 Ft  |
| <input type="checkbox"/> 028546 25 Ft | <input type="checkbox"/> 028767 55 Ft  |
| <input type="checkbox"/> 028660 30 Ft | <input type="checkbox"/> 028608 150 Ft |
| <input type="checkbox"/> 028661 35 Ft | <input type="checkbox"/> 028768 60 Ft  |

⑥ Gas Console II

- 073218 Gas Console II

⑦ Motor Valve Console II

- 073219 Motor Valve Console II

⑧ Leads Between Gas Csl and Mtr Valve Csl

- |                                       |  |
|---------------------------------------|--|
| <input type="checkbox"/> 028622 10 Ft | <input type="checkbox"/> 028774 45 Ft  |
| <input type="checkbox"/> 028623 15 Ft | <input type="checkbox"/> 028654 50 Ft  |
| <input type="checkbox"/> 028624 20 Ft | <input type="checkbox"/> 028852 61 Ft  |
| <input type="checkbox"/> 028625 25 Ft | <input type="checkbox"/> 028655 75 Ft  |
| <input type="checkbox"/> 028626 30 Ft | <input type="checkbox"/> 028656 100 Ft |
| <input type="checkbox"/> 028627 35 Ft |  |

⑨ Shield Gas Hose Set – Gas Csl/RHF Csl

- |                                       |                                       |
|---------------------------------------|---------------------------------------|
| <input type="checkbox"/> 028683 10 Ft | <input type="checkbox"/> 028687 30 Ft |
| <input type="checkbox"/> 028684 15 Ft | <input type="checkbox"/> 028688 35 Ft |
| <input type="checkbox"/> 028685 20 Ft | <input type="checkbox"/> 028689 50 Ft |
| <input type="checkbox"/> 028686 25 Ft | <input type="checkbox"/> 128040 75 Ft |

⑩ Cable Between Gas Csl and PS

- |                                       |  |
|---------------------------------------|--|
| <input type="checkbox"/> 023989 10 Ft | <input type="checkbox"/> 123077 85 Ft  |
| <input type="checkbox"/> 023549 15 Ft | <input type="checkbox"/> 023608 100 Ft |
| <input type="checkbox"/> 023605 25 Ft | <input type="checkbox"/> 023963 115 Ft |
| <input type="checkbox"/> 023757 38 Ft | <input type="checkbox"/> 123147 120 Ft |
| <input type="checkbox"/> 023606 50 Ft | <input type="checkbox"/> 023743 125 Ft |
| <input type="checkbox"/> 123044 60 Ft | <input type="checkbox"/> 023609 150 Ft |
| <input type="checkbox"/> 023607 75 Ft | <input type="checkbox"/> 023953 200 Ft |

\*Power supply voltages are factory pre-set. See bold type under ①

Please specify for optional voltage. \_\_\_\_\_

⑪ Cable Between Mtr Vlv Csl and PS

- |                                       |  |
|---------------------------------------|--|
| <input type="checkbox"/> 023551 15 Ft | <input type="checkbox"/> 023593 100 Ft |
| <input type="checkbox"/> 023590 25 Ft | <input type="checkbox"/> 123078 110 Ft |
| <input type="checkbox"/> 023776 35 Ft | <input type="checkbox"/> 023967 120 Ft |
| <input type="checkbox"/> 023591 50 Ft | <input type="checkbox"/> 123143 130 Ft |
| <input type="checkbox"/> 023592 75 Ft | <input type="checkbox"/> 023594 150 Ft |
| <input type="checkbox"/> 123045 85 Ft | <input type="checkbox"/> 023658 200 Ft |

⑫ Remote Voltage/Current (V/C) Control

- 073007 Control, Digital V/C (DR)
- 055004 Control, Programmable V/C (PR)
- 073045 Control, Remote Current

⑬a Cable Between PS and Digital Remote

- |  |  |
|--|--|
| <input type="checkbox"/> 023990 7 Ft   | <input type="checkbox"/> 123188 120 Ft |
| <input type="checkbox"/> 023911 15 Ft  | <input type="checkbox"/> 023882 125 Ft |
| <input type="checkbox"/> 023878 25 Ft  | <input type="checkbox"/> 023883 150 Ft |
| <input type="checkbox"/> 023879 50 Ft  | <input type="checkbox"/> 023884 200 Ft |
| <input type="checkbox"/> 123040 60 Ft  | <input type="checkbox"/> 023885 250 Ft |
| <input type="checkbox"/> 023880 75 Ft  | <input type="checkbox"/> 023886 275 Ft |
| <input type="checkbox"/> 123073 85 Ft  | <input type="checkbox"/> 023887 300 Ft |
| <input type="checkbox"/> 023881 100 Ft |  |

⑬b Cable Between PS and Current Remote

- |  |  |
|--|--|
| <input type="checkbox"/> 123150 10 Ft  | <input type="checkbox"/> 123068 110 Ft |
| <input type="checkbox"/> 023871 25 Ft  | <input type="checkbox"/> 123088 125 Ft |
| <input type="checkbox"/> 023872 38 Ft  | <input type="checkbox"/> 023876 150 Ft |
| <input type="checkbox"/> 023873 50 Ft  | <input type="checkbox"/> 123032 170 Ft |
| <input type="checkbox"/> 023874 75 Ft  | <input type="checkbox"/> 023877 200 Ft |
| <input type="checkbox"/> 023875 100 Ft |  |

⑭ Cables Between PS and Prog. Remote

- |  |  |
|--|--|
| <input type="checkbox"/> 028831 15 Ft  | <input type="checkbox"/> 028613 150 Ft |
| <input type="checkbox"/> 028609 25 Ft  | <input type="checkbox"/> 028614 200 Ft |
| <input type="checkbox"/> 028610 50 Ft  | <input type="checkbox"/> 028833 250 Ft |
| <input type="checkbox"/> 028611 75 Ft  | <input type="checkbox"/> 028834 275 Ft |
| <input type="checkbox"/> 028612 100 Ft | <input type="checkbox"/> 028835 300 Ft |
| <input type="checkbox"/> 028832 125 Ft |  |



**15a) Cable Between PS and Mach. Comp. I/O Int.**

- |                                       |   |
|---------------------------------------|---|
| <input type="checkbox"/> 023841 6 Ft  | <input type="checkbox"/> 123080 85 Ft   |
| <input type="checkbox"/> 023842 15 Ft | <input type="checkbox"/> 0023847 100 Ft |
| <input type="checkbox"/> 023843 25 Ft | <input type="checkbox"/> 023962 115 Ft  |
| <input type="checkbox"/> 023844 35 Ft | <input type="checkbox"/> 123148 120 Ft  |
| <input type="checkbox"/> 023845 50 Ft | <input type="checkbox"/> 023848 125 Ft  |
| <input type="checkbox"/> 123047 60 Ft | <input type="checkbox"/> 023849 150 Ft  |
| <input type="checkbox"/> 023846 75 Ft | <input type="checkbox"/> 023850 200 Ft  |

**15b) Cable Between PS and Mach. Comp. V/C Int.**

- |                                       |  |
|---------------------------------------|--|
| <input type="checkbox"/> 023902 6 Ft  | <input type="checkbox"/> 023855 75 Ft  |
| <input type="checkbox"/> 023851 15 Ft | <input type="checkbox"/> 023856 100 Ft |
| <input type="checkbox"/> 023852 25 Ft | <input type="checkbox"/> 023903 125 Ft |
| <input type="checkbox"/> 023853 35 Ft | <input type="checkbox"/> 023857 150 Ft |
| <input type="checkbox"/> 023854 50 Ft | <input type="checkbox"/> 023858 200 Ft |

**16) Cable Between PS and Work Table**

- |                                       |                                       |
|---------------------------------------|---------------------------------------|
| <input type="checkbox"/> 023755 4 Ft  | <input type="checkbox"/> 023404 25 Ft |
| <input type="checkbox"/> 023920 8 Ft  | <input type="checkbox"/> 023968 30 Ft |
| <input type="checkbox"/> 023508 10 Ft | <input type="checkbox"/> 023986 35 Ft |
| <input type="checkbox"/> 023403 15 Ft | <input type="checkbox"/> 023405 50 Ft |

**17) Hold Cable Between Power Supplies**

- |                                       |  |
|---------------------------------------|--|
| <input type="checkbox"/> 023340 15 Ft | <input type="checkbox"/> 023343 100 Ft |
| <input type="checkbox"/> 023341 25 Ft | <input type="checkbox"/> 023344 150 Ft |
| <input type="checkbox"/> 023342 50 Ft |  |

**18) Ind. Initial Height Sensing (IHS) System for 2" Torch**

- 028720 IHS System, Inductive for 2" Dia. Torch

**18) Ind. Initial Height Sensing (IHS) System for 1-3/4" Torch**

- 028390 IHS System, Inductive for 1-3/4" Dia. Torch

**18a) IHS Pressure Regulator Assembly**

- 029758 IHS Pressure Regulator SA

**19) Inductive IHS Lead Set**

- |                                       |  |
|---------------------------------------|--|
| <input type="checkbox"/> 028811 25 Ft | <input type="checkbox"/> 028814 100 Ft |
| <input type="checkbox"/> 028812 50 Ft | <input type="checkbox"/> 028815 150 Ft |
| <input type="checkbox"/> 028813 75 Ft | <input type="checkbox"/> 028816 200 Ft |

**20) Timer/Counter**

- 073194 Tmr-Cntr

**20a) Cable Between Timer/Counter and PS**

- |                                       |  |
|---------------------------------------|--|
| <input type="checkbox"/> 023687 10 Ft | <input type="checkbox"/> 123079 85 Ft  |
| <input type="checkbox"/> 023692 25 Ft | <input type="checkbox"/> 023695 100 Ft |
| <input type="checkbox"/> 023758 38 Ft | <input type="checkbox"/> 023993 115 Ft |
| <input type="checkbox"/> 023693 50 Ft | <input type="checkbox"/> 123189 120 Ft |
| <input type="checkbox"/> 123046 60 Ft | <input type="checkbox"/> 023696 150 Ft |
| <input type="checkbox"/> 023694 75 Ft | <input type="checkbox"/> 023954 200 Ft |

**21) Water Muffler System-with Hoses (not used with stnls. steel torch)**

- |  |                     |
|--|---------------------|
| <input type="checkbox"/> 034096 WM Sys/w hoses | 240/480V, 3Ø, 60 Hz |
| <input type="checkbox"/> 034100 WM Sys/w hoses | 380/415V, 3Ø, 60 Hz |
| <input type="checkbox"/> 034098 WM Sys/w hoses | 600V, 3Ø, 60 Hz     |

**21) Water Muffler System-without Hoses (not used with stnls. steel torch)**

- |   |                     |
|---|---------------------|
| <input type="checkbox"/> 034097 WM Sys/wo hoses | 240/480V, 3Ø, 60 H  |
| <input type="checkbox"/> 034101 WM Sys/wo hoses | 380/415V, 3Ø, 60 Hz |
| <input type="checkbox"/> 034099 WM Sys/wo hoses | 600V, 3Ø, 60 Hz     |

**21a) Additional Length WM Hose, Specify Length (Ft)**

- 034051 Add'l Length W-M Hose (Qty in Ft.)

**22) Cable Between WM Pump and Power Supply**

- |  |
|--|
| <input type="checkbox"/> 023866 50 Ft  |
| <input type="checkbox"/> 023867 75 Ft  |
| <input type="checkbox"/> 023868 100 Ft |

**23a) Hose Between O<sub>2</sub> Supply and Gas Csl**

- |  |  |
|--|--|
| <input type="checkbox"/> 024204 15 Ft  | <input type="checkbox"/> 024450 115 Ft |
| <input type="checkbox"/> 024205 25 Ft  | <input type="checkbox"/> 024516 120 Ft |
| <input type="checkbox"/> 024155 50 Ft  | <input type="checkbox"/> 024490 125 Ft |
| <input type="checkbox"/> 024398 75 Ft  | <input type="checkbox"/> 024159 150 Ft |
| <input type="checkbox"/> 024487 85 Ft  | <input type="checkbox"/> 024470 180 Ft |
| <input type="checkbox"/> 024206 100 Ft | <input type="checkbox"/> 024333 200 Ft |
| <input type="checkbox"/> 024481 110 Ft |  |

**23b) Hose Between N<sub>2</sub> Supply and Gas Csl**

- |                                       |  |
|---------------------------------------|--|
| <input type="checkbox"/> 024505 6 Ft  | <input type="checkbox"/> 024116 100 Ft |
| <input type="checkbox"/> 024210 10 Ft | <input type="checkbox"/> 024482 110 Ft |
| <input type="checkbox"/> 024203 15 Ft | <input type="checkbox"/> 024451 115 Ft |
| <input type="checkbox"/> 024232 20 Ft | <input type="checkbox"/> 024517 120 Ft |
| <input type="checkbox"/> 024134 25 Ft | <input type="checkbox"/> 024491 125 Ft |
| <input type="checkbox"/> 024211 35 Ft | <input type="checkbox"/> 024120 150 Ft |
| <input type="checkbox"/> 024112 50 Ft | <input type="checkbox"/> 024185 180 Ft |
| <input type="checkbox"/> 024148 75 Ft | <input type="checkbox"/> 024124 200 Ft |
| <input type="checkbox"/> 024488 85 Ft |  |

**23c) Hose Between Shield Gas Supply and Gas Csl**

- |                                       |  |
|---------------------------------------|--|
| <input type="checkbox"/> 024043 4 Ft  | <input type="checkbox"/> 024486 85 Ft  |
| <input type="checkbox"/> 024341 10 Ft | <input type="checkbox"/> 024115 100 Ft |
| <input type="checkbox"/> 024200 15 Ft | <input type="checkbox"/> 024452 110 Ft |
| <input type="checkbox"/> 024342 20 Ft | <input type="checkbox"/> 024449 115 Ft |
| <input type="checkbox"/> 024133 25 Ft | <input type="checkbox"/> 024515 120 Ft |
| <input type="checkbox"/> 024448 35 Ft | <input type="checkbox"/> 024395 125 Ft |
| <input type="checkbox"/> 024407 45 Ft | <input type="checkbox"/> 024119 150 Ft |
| <input type="checkbox"/> 024012 50 Ft | <input type="checkbox"/> 024480 170 Ft |
| <input type="checkbox"/> 024472 60 Ft | <input type="checkbox"/> 024184 180 Ft |
| <input type="checkbox"/> 024147 75 Ft | <input type="checkbox"/> 024123 200 Ft |

**24) Argon/Hydrogen Console**

- 073109 Ar/H2 Csl

**25) Cable Between Ar/H2 Csl and PS**

- |                                       |  |
|---------------------------------------|--|
| <input type="checkbox"/> 023660 15 Ft | <input type="checkbox"/> 023663 75 Ft  |
| <input type="checkbox"/> 023661 25 Ft | <input type="checkbox"/> 023664 100 Ft |
| <input type="checkbox"/> 023662 50 Ft | <input type="checkbox"/> 023665 150 Ft |

**26) Hose Between Ar/H2 Csl and Trch**

- |                                       |                                       |
|---------------------------------------|---------------------------------------|
| <input type="checkbox"/> 024354 10 Ft | <input type="checkbox"/> 024370 40 Ft |
| <input type="checkbox"/> 024355 12 Ft | <input type="checkbox"/> 024443 50 Ft |
| <input type="checkbox"/> 024368 20 Ft | <input type="checkbox"/> 024467 75 Ft |
| <input type="checkbox"/> 024369 30 Ft |                                       |

**Spare Parts Kit**

- |                                 |                           |
|---------------------------------|---------------------------|
| <input type="checkbox"/> 128825 | Kit: HySpeed consumables  |
| <input type="checkbox"/> 028602 | Kit: Standard consumables |

Distributor Information:

HYPERTHERM  
HySpeed HT2000 Order Form

Customer Information:

① Power Supply \*

- 073063 Power Supply, 200V,60 Hz,w/THC
- 073064 Power Supply, 208V,60 Hz,w/THC
- 073065 Power Supply, 220/**380**/415V,50 Hz,w/THC
- 073198 Power Supply, 400V,CE,50 Hz,w/THC
- 073054 Power Supply, 240/**480**V,60 Hz,w/THC
- 073196 Power Supply, 440/**460**V,50-50 Hz,w/THC
- 073066 Power Supply, 575/**600**V,60 Hz,w/THC
  
- 073104 Power Supply, 200V,60 Hz,wo/THC
- 073105 Power Supply, 208V,60 Hz,wo/THC
- 073107 Power Supply, 220/**380**/415V,50 Hz,wo/THC
- 073199 Power Supply, 400V,CE,50 Hz,wo/THC
- 073106 Power Supply, 240/**480**V,60 Hz,wo/THC
- 073108 Power Supply, 575/**600**V,60 Hz,wo/THC

② Machine Torch Assembly with 2" Dia. Sleeve

- 128381 With HySpeed consumables

② Stainless Steel Machine Torch Assembly with 2" Dia. Sleeve

- 128367 With standard consumables

② Optional Machine Torch Assembly with 1-3/4" Dia. Sleeve

- 128141 With standard consumables

②a Torch Mounting Bracket – For 2" Dia. Sleeve

- 020046 Torch Mounting Bracket for 2" Dia. Sleeve

②a Torch Mounting Bracket – For 1-3/4" Dia. Sleeve

- 020522 Torch Mounting Bracket for 1-3/4" Dia. Sleeve

③ Remote High Frequency Console

- 073067 Rem. High Frequency Console

④ Leads Between PS and RHF Csl

- |  |  |
|--|--|
| <input type="checkbox"/> 028604 25 Ft  | <input type="checkbox"/> 028901 110 Ft |
| <input type="checkbox"/> 028605 50 Ft  | <input type="checkbox"/> 028895 115 Ft |
| <input type="checkbox"/> 128051 60 Ft  | <input type="checkbox"/> 128128 120 Ft |
| <input type="checkbox"/> 028606 75 Ft  | <input type="checkbox"/> 028746 125 Ft |
| <input type="checkbox"/> 128077 85 Ft  | <input type="checkbox"/> 028608 150 Ft |
| <input type="checkbox"/> 028607 100 Ft | <input type="checkbox"/> 028651 200 Ft |

⑤ Shielded Leads Between Torch and RHF Csl

- |                                       |  |
|---------------------------------------|--|
| <input type="checkbox"/> 028657 10 Ft | <input type="checkbox"/> 028662 40 Ft  |
| <input type="checkbox"/> 028658 15 Ft | <input type="checkbox"/> 028663 45 Ft  |
| <input type="checkbox"/> 028659 20 Ft | <input type="checkbox"/> 028547 50 Ft  |
| <input type="checkbox"/> 028546 25 Ft | <input type="checkbox"/> 028767 55 Ft  |
| <input type="checkbox"/> 028660 30 Ft | <input type="checkbox"/> 028608 150 Ft |
| <input type="checkbox"/> 028661 35 Ft | <input type="checkbox"/> 028768 60 Ft  |

⑥ Gas Console II

- 073218 Gas Console II

⑦ Motor Valve Console II

- 073219 Motor Valve Console II

⑧ Leads Between Gas Csl and Mtr Valve Csl

- |                                       |  |
|---------------------------------------|--|
| <input type="checkbox"/> 028622 10 Ft | <input type="checkbox"/> 028774 45 Ft  |
| <input type="checkbox"/> 028623 15 Ft | <input type="checkbox"/> 028654 50 Ft  |
| <input type="checkbox"/> 028624 20 Ft | <input type="checkbox"/> 028852 61 Ft  |
| <input type="checkbox"/> 028625 25 Ft | <input type="checkbox"/> 028655 75 Ft  |
| <input type="checkbox"/> 028626 30 Ft | <input type="checkbox"/> 028656 100 Ft |
| <input type="checkbox"/> 028627 35 Ft |  |

⑨ Shield Gas Hose Set – Gas Csl/RHF Csl

- |                                       |                                       |
|---------------------------------------|---------------------------------------|
| <input type="checkbox"/> 028683 10 Ft | <input type="checkbox"/> 028687 30 Ft |
| <input type="checkbox"/> 028684 15 Ft | <input type="checkbox"/> 028688 35 Ft |
| <input type="checkbox"/> 028685 20 Ft | <input type="checkbox"/> 028689 50 Ft |
| <input type="checkbox"/> 028686 25 Ft | <input type="checkbox"/> 128040 75 Ft |

⑩ Cable Between Gas Csl and PS

- |                                       |  |
|---------------------------------------|--|
| <input type="checkbox"/> 023989 10 Ft | <input type="checkbox"/> 123077 85 Ft  |
| <input type="checkbox"/> 023549 15 Ft | <input type="checkbox"/> 023608 100 Ft |
| <input type="checkbox"/> 023605 25 Ft | <input type="checkbox"/> 023963 115 Ft |
| <input type="checkbox"/> 023757 38 Ft | <input type="checkbox"/> 123147 120 Ft |
| <input type="checkbox"/> 023606 50 Ft | <input type="checkbox"/> 023743 125 Ft |
| <input type="checkbox"/> 123044 60 Ft | <input type="checkbox"/> 023609 150 Ft |
| <input type="checkbox"/> 023607 75 Ft | <input type="checkbox"/> 023953 200 Ft |

\*Power supply voltages are factory pre-set. See bold type under ①

Please specify for optional voltage. \_\_\_\_\_

⑪ Cable Between Mtr Vlv Csl and PS

- |                                       |  |
|---------------------------------------|--|
| <input type="checkbox"/> 023551 15 Ft | <input type="checkbox"/> 023593 100 Ft |
| <input type="checkbox"/> 023590 25 Ft | <input type="checkbox"/> 123078 110 Ft |
| <input type="checkbox"/> 023776 35 Ft | <input type="checkbox"/> 023967 120 Ft |
| <input type="checkbox"/> 023591 50 Ft | <input type="checkbox"/> 123143 130 Ft |
| <input type="checkbox"/> 023592 75 Ft | <input type="checkbox"/> 023594 150 Ft |
| <input type="checkbox"/> 123045 85 Ft | <input type="checkbox"/> 023658 200 Ft |

⑫ Remote Voltage/Current (V/C) Control

- 073007 Control, Digital V/C (DR)
- 055004 Control, Programmable V/C (PR)
- 073045 Control, Remote Current

⑬a Cable Between PS and Digital Remote

- |  |  |
|--|--|
| <input type="checkbox"/> 023990 7 Ft   | <input type="checkbox"/> 123188 120 Ft |
| <input type="checkbox"/> 023911 15 Ft  | <input type="checkbox"/> 023882 125 Ft |
| <input type="checkbox"/> 023878 25 Ft  | <input type="checkbox"/> 023883 150 Ft |
| <input type="checkbox"/> 023879 50 Ft  | <input type="checkbox"/> 023884 200 Ft |
| <input type="checkbox"/> 123040 60 Ft  | <input type="checkbox"/> 023885 250 Ft |
| <input type="checkbox"/> 023880 75 Ft  | <input type="checkbox"/> 023886 275 Ft |
| <input type="checkbox"/> 123073 85 Ft  | <input type="checkbox"/> 023887 300 Ft |
| <input type="checkbox"/> 023881 100 Ft |  |

⑬b Cable Between PS and Current Remote

- |  |  |
|--|--|
| <input type="checkbox"/> 123150 10 Ft  | <input type="checkbox"/> 123068 110 Ft |
| <input type="checkbox"/> 023871 25 Ft  | <input type="checkbox"/> 123088 125 Ft |
| <input type="checkbox"/> 023872 38 Ft  | <input type="checkbox"/> 023876 150 Ft |
| <input type="checkbox"/> 023873 50 Ft  | <input type="checkbox"/> 123032 170 Ft |
| <input type="checkbox"/> 023874 75 Ft  | <input type="checkbox"/> 023877 200 Ft |
| <input type="checkbox"/> 023875 100 Ft |  |

⑭ Cables Between PS and Prog. Remote

- |  |  |
|--|--|
| <input type="checkbox"/> 028831 15 Ft  | <input type="checkbox"/> 028613 150 Ft |
| <input type="checkbox"/> 028609 25 Ft  | <input type="checkbox"/> 028614 200 Ft |
| <input type="checkbox"/> 028610 50 Ft  | <input type="checkbox"/> 028833 250 Ft |
| <input type="checkbox"/> 028611 75 Ft  | <input type="checkbox"/> 028834 275 Ft |
| <input type="checkbox"/> 028612 100 Ft | <input type="checkbox"/> 028835 300 Ft |
| <input type="checkbox"/> 028832 125 Ft |  |

**15a) Cable Between PS and Mach. Comp. I/O Int.**

- |                                       |   |
|---------------------------------------|---|
| <input type="checkbox"/> 023841 6 Ft  | <input type="checkbox"/> 123080 85 Ft   |
| <input type="checkbox"/> 023842 15 Ft | <input type="checkbox"/> 0023847 100 Ft |
| <input type="checkbox"/> 023843 25 Ft | <input type="checkbox"/> 023962 115 Ft  |
| <input type="checkbox"/> 023844 35 Ft | <input type="checkbox"/> 123148 120 Ft  |
| <input type="checkbox"/> 023845 50 Ft | <input type="checkbox"/> 023848 125 Ft  |
| <input type="checkbox"/> 123047 60 Ft | <input type="checkbox"/> 023849 150 Ft  |
| <input type="checkbox"/> 023846 75 Ft | <input type="checkbox"/> 023850 200 Ft  |

**15b) Cable Between PS and Mach. Comp. V/C Int.**

- |                                       |  |
|---------------------------------------|--|
| <input type="checkbox"/> 023902 6 Ft  | <input type="checkbox"/> 023855 75 Ft  |
| <input type="checkbox"/> 023851 15 Ft | <input type="checkbox"/> 023856 100 Ft |
| <input type="checkbox"/> 023852 25 Ft | <input type="checkbox"/> 023903 125 Ft |
| <input type="checkbox"/> 023853 35 Ft | <input type="checkbox"/> 023857 150 Ft |
| <input type="checkbox"/> 023854 50 Ft | <input type="checkbox"/> 023858 200 Ft |

**16) Cable Between PS and Work Table**

- |                                       |                                       |
|---------------------------------------|---------------------------------------|
| <input type="checkbox"/> 023755 4 Ft  | <input type="checkbox"/> 023404 25 Ft |
| <input type="checkbox"/> 023920 8 Ft  | <input type="checkbox"/> 023968 30 Ft |
| <input type="checkbox"/> 023508 10 Ft | <input type="checkbox"/> 023986 35 Ft |
| <input type="checkbox"/> 023403 15 Ft | <input type="checkbox"/> 023405 50 Ft |

**17) Hold Cable Between Power Supplies**

- |                                       |  |
|---------------------------------------|--|
| <input type="checkbox"/> 023340 15 Ft | <input type="checkbox"/> 023343 100 Ft |
| <input type="checkbox"/> 023341 25 Ft | <input type="checkbox"/> 023344 150 Ft |
| <input type="checkbox"/> 023342 50 Ft |  |

**18) Ind. Initial Height Sensing (IHS) System for 2" Torch**

- 028720 IHS System, Inductive for 2" Dia. Torch

**18) Ind. Initial Height Sensing (IHS) System for 1-3/4" Torch**

- 028390 IHS System, Inductive for 1-3/4" Dia. Torch

**18a) IHS Pressure Regulator Assembly**

- 029758 IHS Pressure Regulator SA

**19) Inductive IHS Lead Set**

- |                                       |  |
|---------------------------------------|--|
| <input type="checkbox"/> 028811 25 Ft | <input type="checkbox"/> 028814 100 Ft |
| <input type="checkbox"/> 028812 50 Ft | <input type="checkbox"/> 028815 150 Ft |
| <input type="checkbox"/> 028813 75 Ft | <input type="checkbox"/> 028816 200 Ft |

**20) Timer/Counter**

- 073194 Tmr-Cntr

**20a) Cable Between Timer/Counter and PS**

- |                                       |  |
|---------------------------------------|--|
| <input type="checkbox"/> 023687 10 Ft | <input type="checkbox"/> 123079 85 Ft  |
| <input type="checkbox"/> 023692 25 Ft | <input type="checkbox"/> 023695 100 Ft |
| <input type="checkbox"/> 023758 38 Ft | <input type="checkbox"/> 023993 115 Ft |
| <input type="checkbox"/> 023693 50 Ft | <input type="checkbox"/> 123189 120 Ft |
| <input type="checkbox"/> 123046 60 Ft | <input type="checkbox"/> 023696 150 Ft |
| <input type="checkbox"/> 023694 75 Ft | <input type="checkbox"/> 023954 200 Ft |

**21) Water Muffler System-with Hoses (not used with stnls. steel torch)**

- |  |                     |
|--|---------------------|
| <input type="checkbox"/> 034096 WM Sys/w hoses | 240/480V, 3Ø, 60 Hz |
| <input type="checkbox"/> 034100 WM Sys/w hoses | 380/415V, 3Ø, 60 Hz |
| <input type="checkbox"/> 034098 WM Sys/w hoses | 600V, 3Ø, 60 Hz     |

**21) Water Muffler System-without Hoses (not used with stnls. steel torch)**

- |   |                     |
|---|---------------------|
| <input type="checkbox"/> 034097 WM Sys/wo hoses | 240/480V, 3Ø, 60 H  |
| <input type="checkbox"/> 034101 WM Sys/wo hoses | 380/415V, 3Ø, 60 Hz |
| <input type="checkbox"/> 034099 WM Sys/wo hoses | 600V, 3Ø, 60 Hz     |

**21a) Additional Length WM Hose, Specify Length (Ft)**

- 034051 Add'l Length W-M Hose (Qty in Ft.)

**22) Cable Between WM Pump and Power Supply**

- |  |
|--|
| <input type="checkbox"/> 023866 50 Ft  |
| <input type="checkbox"/> 023867 75 Ft  |
| <input type="checkbox"/> 023868 100 Ft |

**23a) Hose Between O<sub>2</sub> Supply and Gas Csl**

- |  |  |
|--|--|
| <input type="checkbox"/> 024204 15 Ft  | <input type="checkbox"/> 024450 115 Ft |
| <input type="checkbox"/> 024205 25 Ft  | <input type="checkbox"/> 024516 120 Ft |
| <input type="checkbox"/> 024155 50 Ft  | <input type="checkbox"/> 024490 125 Ft |
| <input type="checkbox"/> 024398 75 Ft  | <input type="checkbox"/> 024159 150 Ft |
| <input type="checkbox"/> 024487 85 Ft  | <input type="checkbox"/> 024470 180 Ft |
| <input type="checkbox"/> 024206 100 Ft | <input type="checkbox"/> 024333 200 Ft |
| <input type="checkbox"/> 024481 110 Ft |  |

**23b) Hose Between N<sub>2</sub> Supply and Gas Csl**

- |                                       |  |
|---------------------------------------|--|
| <input type="checkbox"/> 024505 6 Ft  | <input type="checkbox"/> 024116 100 Ft |
| <input type="checkbox"/> 024210 10 Ft | <input type="checkbox"/> 024482 110 Ft |
| <input type="checkbox"/> 024203 15 Ft | <input type="checkbox"/> 024451 115 Ft |
| <input type="checkbox"/> 024232 20 Ft | <input type="checkbox"/> 024517 120 Ft |
| <input type="checkbox"/> 024134 25 Ft | <input type="checkbox"/> 024491 125 Ft |
| <input type="checkbox"/> 024211 35 Ft | <input type="checkbox"/> 024120 150 Ft |
| <input type="checkbox"/> 024112 50 Ft | <input type="checkbox"/> 024185 180 Ft |
| <input type="checkbox"/> 024148 75 Ft | <input type="checkbox"/> 024124 200 Ft |
| <input type="checkbox"/> 024488 85 Ft |  |

**23c) Hose Between Shield Gas Supply and Gas Csl**

- |                                       |  |
|---------------------------------------|--|
| <input type="checkbox"/> 024043 4 Ft  | <input type="checkbox"/> 024486 85 Ft  |
| <input type="checkbox"/> 024341 10 Ft | <input type="checkbox"/> 024115 100 Ft |
| <input type="checkbox"/> 024200 15 Ft | <input type="checkbox"/> 024452 110 Ft |
| <input type="checkbox"/> 024342 20 Ft | <input type="checkbox"/> 024449 115 Ft |
| <input type="checkbox"/> 024133 25 Ft | <input type="checkbox"/> 024515 120 Ft |
| <input type="checkbox"/> 024448 35 Ft | <input type="checkbox"/> 024395 125 Ft |
| <input type="checkbox"/> 024407 45 Ft | <input type="checkbox"/> 024119 150 Ft |
| <input type="checkbox"/> 024012 50 Ft | <input type="checkbox"/> 024480 170 Ft |
| <input type="checkbox"/> 024472 60 Ft | <input type="checkbox"/> 024184 180 Ft |
| <input type="checkbox"/> 024147 75 Ft | <input type="checkbox"/> 024123 200 Ft |

**24) Argon/Hydrogen Console**

- 073109 Ar/H2 Csl

**25) Cable Between Ar/H2 Csl and PS**

- |                                       |  |
|---------------------------------------|--|
| <input type="checkbox"/> 023660 15 Ft | <input type="checkbox"/> 023663 75 Ft  |
| <input type="checkbox"/> 023661 25 Ft | <input type="checkbox"/> 023664 100 Ft |
| <input type="checkbox"/> 023662 50 Ft | <input type="checkbox"/> 023665 150 Ft |

**26) Hose Between Ar/H2 Csl and Trch**

- |                                       |                                       |
|---------------------------------------|---------------------------------------|
| <input type="checkbox"/> 024354 10 Ft | <input type="checkbox"/> 024370 40 Ft |
| <input type="checkbox"/> 024355 12 Ft | <input type="checkbox"/> 024443 50 Ft |
| <input type="checkbox"/> 024368 20 Ft | <input type="checkbox"/> 024467 75 Ft |
| <input type="checkbox"/> 024369 30 Ft |                                       |

**Spare Parts Kit**

- |                                 |                           |
|---------------------------------|---------------------------|
| <input type="checkbox"/> 128825 | Kit: HySpeed consumables  |
| <input type="checkbox"/> 028602 | Kit: Standard consumables |

Distributor Information:

HYPERTHERM  
HySpeed HT2000 Order Form

Customer Information:

① Power Supply \*

- 073063 Power Supply, 200V,60 Hz,w/THC
- 073064 Power Supply, 208V,60 Hz,w/THC
- 073065 Power Supply, 220/**380**/415V,50 Hz,w/THC
- 073198 Power Supply, 400V,CE,50 Hz,w/THC
- 073054 Power Supply, 240/**480**V,60 Hz,w/THC
- 073196 Power Supply, 440/**460**V,50-50 Hz,w/THC
- 073066 Power Supply, 575/**600**V,60 Hz,w/THC
  
- 073104 Power Supply, 200V,60 Hz,wo/THC
- 073105 Power Supply, 208V,60 Hz,wo/THC
- 073107 Power Supply, 220/**380**/415V,50 Hz,wo/THC
- 073199 Power Supply, 400V,CE,50 Hz,wo/THC
- 073106 Power Supply, 240/**480**V,60 Hz,wo/THC
- 073108 Power Supply, 575/**600**V,60 Hz,wo/THC

② Machine Torch Assembly with 2" Dia. Sleeve

- 128381 With HySpeed consumables

② Stainless Steel Machine Torch Assembly with 2" Dia. Sleeve

- 128367 With standard consumables

② Optional Machine Torch Assembly with 1-3/4" Dia. Sleeve

- 128141 With standard consumables

②a Torch Mounting Bracket – For 2" Dia. Sleeve

- 020046 Torch Mounting Bracket for 2" Dia. Sleeve

②a Torch Mounting Bracket – For 1-3/4" Dia. Sleeve

- 020522 Torch Mounting Bracket for 1-3/4" Dia. Sleeve

③ Remote High Frequency Console

- 073067 Rem. High Frequency Console

④ Leads Between PS and RHF Csl

- |  |  |
|--|--|
| <input type="checkbox"/> 028604 25 Ft  | <input type="checkbox"/> 028901 110 Ft |
| <input type="checkbox"/> 028605 50 Ft  | <input type="checkbox"/> 028895 115 Ft |
| <input type="checkbox"/> 128051 60 Ft  | <input type="checkbox"/> 128128 120 Ft |
| <input type="checkbox"/> 028606 75 Ft  | <input type="checkbox"/> 028746 125 Ft |
| <input type="checkbox"/> 128077 85 Ft  | <input type="checkbox"/> 028608 150 Ft |
| <input type="checkbox"/> 028607 100 Ft | <input type="checkbox"/> 028651 200 Ft |

⑤ Shielded Leads Between Torch and RHF Csl

- |                                       |  |
|---------------------------------------|--|
| <input type="checkbox"/> 028657 10 Ft | <input type="checkbox"/> 028662 40 Ft  |
| <input type="checkbox"/> 028658 15 Ft | <input type="checkbox"/> 028663 45 Ft  |
| <input type="checkbox"/> 028659 20 Ft | <input type="checkbox"/> 028547 50 Ft  |
| <input type="checkbox"/> 028546 25 Ft | <input type="checkbox"/> 028767 55 Ft  |
| <input type="checkbox"/> 028660 30 Ft | <input type="checkbox"/> 028608 150 Ft |
| <input type="checkbox"/> 028661 35 Ft | <input type="checkbox"/> 028768 60 Ft  |

⑥ Gas Console II

- 073218 Gas Console II

⑦ Motor Valve Console II

- 073219 Motor Valve Console II

⑧ Leads Between Gas Csl and Mtr Valve Csl

- |                                       |  |
|---------------------------------------|--|
| <input type="checkbox"/> 028622 10 Ft | <input type="checkbox"/> 028774 45 Ft  |
| <input type="checkbox"/> 028623 15 Ft | <input type="checkbox"/> 028654 50 Ft  |
| <input type="checkbox"/> 028624 20 Ft | <input type="checkbox"/> 028852 61 Ft  |
| <input type="checkbox"/> 028625 25 Ft | <input type="checkbox"/> 028655 75 Ft  |
| <input type="checkbox"/> 028626 30 Ft | <input type="checkbox"/> 028656 100 Ft |
| <input type="checkbox"/> 028627 35 Ft |  |

⑨ Shield Gas Hose Set – Gas Csl/RHF Csl

- |                                       |                                       |
|---------------------------------------|---------------------------------------|
| <input type="checkbox"/> 028683 10 Ft | <input type="checkbox"/> 028687 30 Ft |
| <input type="checkbox"/> 028684 15 Ft | <input type="checkbox"/> 028688 35 Ft |
| <input type="checkbox"/> 028685 20 Ft | <input type="checkbox"/> 028689 50 Ft |
| <input type="checkbox"/> 028686 25 Ft | <input type="checkbox"/> 128040 75 Ft |

⑩ Cable Between Gas Csl and PS

- |                                       |  |
|---------------------------------------|--|
| <input type="checkbox"/> 023989 10 Ft | <input type="checkbox"/> 123077 85 Ft  |
| <input type="checkbox"/> 023549 15 Ft | <input type="checkbox"/> 023608 100 Ft |
| <input type="checkbox"/> 023605 25 Ft | <input type="checkbox"/> 023963 115 Ft |
| <input type="checkbox"/> 023757 38 Ft | <input type="checkbox"/> 123147 120 Ft |
| <input type="checkbox"/> 023606 50 Ft | <input type="checkbox"/> 023743 125 Ft |
| <input type="checkbox"/> 123044 60 Ft | <input type="checkbox"/> 023609 150 Ft |
| <input type="checkbox"/> 023607 75 Ft | <input type="checkbox"/> 023953 200 Ft |

\*Power supply voltages are factory pre-set. See bold type under ①

Please specify for optional voltage. \_\_\_\_\_

⑪ Cable Between Mtr Vlv Csl and PS

- |                                       |  |
|---------------------------------------|--|
| <input type="checkbox"/> 023551 15 Ft | <input type="checkbox"/> 023593 100 Ft |
| <input type="checkbox"/> 023590 25 Ft | <input type="checkbox"/> 123078 110 Ft |
| <input type="checkbox"/> 023776 35 Ft | <input type="checkbox"/> 023967 120 Ft |
| <input type="checkbox"/> 023591 50 Ft | <input type="checkbox"/> 123143 130 Ft |
| <input type="checkbox"/> 023592 75 Ft | <input type="checkbox"/> 023594 150 Ft |
| <input type="checkbox"/> 123045 85 Ft | <input type="checkbox"/> 023658 200 Ft |

⑫ Remote Voltage/Current (V/C) Control

- 073007 Control, Digital V/C (DR)
- 055004 Control, Programmable V/C (PR)
- 073045 Control, Remote Current

⑬a Cable Between PS and Digital Remote

- |  |  |
|--|--|
| <input type="checkbox"/> 023990 7 Ft   | <input type="checkbox"/> 123188 120 Ft |
| <input type="checkbox"/> 023911 15 Ft  | <input type="checkbox"/> 023882 125 Ft |
| <input type="checkbox"/> 023878 25 Ft  | <input type="checkbox"/> 023883 150 Ft |
| <input type="checkbox"/> 023879 50 Ft  | <input type="checkbox"/> 023884 200 Ft |
| <input type="checkbox"/> 123040 60 Ft  | <input type="checkbox"/> 023885 250 Ft |
| <input type="checkbox"/> 023880 75 Ft  | <input type="checkbox"/> 023886 275 Ft |
| <input type="checkbox"/> 123073 85 Ft  | <input type="checkbox"/> 023887 300 Ft |
| <input type="checkbox"/> 023881 100 Ft |  |

⑬b Cable Between PS and Current Remote

- |  |  |
|--|--|
| <input type="checkbox"/> 123150 10 Ft  | <input type="checkbox"/> 123068 110 Ft |
| <input type="checkbox"/> 023871 25 Ft  | <input type="checkbox"/> 123088 125 Ft |
| <input type="checkbox"/> 023872 38 Ft  | <input type="checkbox"/> 023876 150 Ft |
| <input type="checkbox"/> 023873 50 Ft  | <input type="checkbox"/> 123032 170 Ft |
| <input type="checkbox"/> 023874 75 Ft  | <input type="checkbox"/> 023877 200 Ft |
| <input type="checkbox"/> 023875 100 Ft |  |

⑭ Cables Between PS and Prog. Remote

- |  |  |
|--|--|
| <input type="checkbox"/> 028831 15 Ft  | <input type="checkbox"/> 028613 150 Ft |
| <input type="checkbox"/> 028609 25 Ft  | <input type="checkbox"/> 028614 200 Ft |
| <input type="checkbox"/> 028610 50 Ft  | <input type="checkbox"/> 028833 250 Ft |
| <input type="checkbox"/> 028611 75 Ft  | <input type="checkbox"/> 028834 275 Ft |
| <input type="checkbox"/> 028612 100 Ft | <input type="checkbox"/> 028835 300 Ft |
| <input type="checkbox"/> 028832 125 Ft |  |

**15a) Cable Between PS and Mach. Comp. I/O Int.**

- |                                       |   |
|---------------------------------------|---|
| <input type="checkbox"/> 023841 6 Ft  | <input type="checkbox"/> 123080 85 Ft   |
| <input type="checkbox"/> 023842 15 Ft | <input type="checkbox"/> 0023847 100 Ft |
| <input type="checkbox"/> 023843 25 Ft | <input type="checkbox"/> 023962 115 Ft  |
| <input type="checkbox"/> 023844 35 Ft | <input type="checkbox"/> 123148 120 Ft  |
| <input type="checkbox"/> 023845 50 Ft | <input type="checkbox"/> 023848 125 Ft  |
| <input type="checkbox"/> 123047 60 Ft | <input type="checkbox"/> 023849 150 Ft  |
| <input type="checkbox"/> 023846 75 Ft | <input type="checkbox"/> 023850 200 Ft  |

**15b) Cable Between PS and Mach. Comp. V/C Int.**

- |                                       |  |
|---------------------------------------|--|
| <input type="checkbox"/> 023902 6 Ft  | <input type="checkbox"/> 023855 75 Ft  |
| <input type="checkbox"/> 023851 15 Ft | <input type="checkbox"/> 023856 100 Ft |
| <input type="checkbox"/> 023852 25 Ft | <input type="checkbox"/> 023903 125 Ft |
| <input type="checkbox"/> 023853 35 Ft | <input type="checkbox"/> 023857 150 Ft |
| <input type="checkbox"/> 023854 50 Ft | <input type="checkbox"/> 023858 200 Ft |

**16) Cable Between PS and Work Table**

- |                                       |                                       |
|---------------------------------------|---------------------------------------|
| <input type="checkbox"/> 023755 4 Ft  | <input type="checkbox"/> 023404 25 Ft |
| <input type="checkbox"/> 023920 8 Ft  | <input type="checkbox"/> 023968 30 Ft |
| <input type="checkbox"/> 023508 10 Ft | <input type="checkbox"/> 023986 35 Ft |
| <input type="checkbox"/> 023403 15 Ft | <input type="checkbox"/> 023405 50 Ft |

**17) Hold Cable Between Power Supplies**

- |                                       |  |
|---------------------------------------|--|
| <input type="checkbox"/> 023340 15 Ft | <input type="checkbox"/> 023343 100 Ft |
| <input type="checkbox"/> 023341 25 Ft | <input type="checkbox"/> 023344 150 Ft |
| <input type="checkbox"/> 023342 50 Ft |  |

**18) Ind. Initial Height Sensing (IHS) System for 2" Torch**

- 028720 IHS System, Inductive for 2" Dia. Torch

**18) Ind. Initial Height Sensing (IHS) System for 1-3/4" Torch**

- 028390 IHS System, Inductive for 1-3/4" Dia. Torch

**18a) IHS Pressure Regulator Assembly**

- 029758 IHS Pressure Regulator SA

**19) Inductive IHS Lead Set**

- |                                       |  |
|---------------------------------------|--|
| <input type="checkbox"/> 028811 25 Ft | <input type="checkbox"/> 028814 100 Ft |
| <input type="checkbox"/> 028812 50 Ft | <input type="checkbox"/> 028815 150 Ft |
| <input type="checkbox"/> 028813 75 Ft | <input type="checkbox"/> 028816 200 Ft |

**20) Timer/Counter**

- 073194 Tmr-Cntr

**20a) Cable Between Timer/Counter and PS**

- |                                       |  |
|---------------------------------------|--|
| <input type="checkbox"/> 023687 10 Ft | <input type="checkbox"/> 123079 85 Ft  |
| <input type="checkbox"/> 023692 25 Ft | <input type="checkbox"/> 023695 100 Ft |
| <input type="checkbox"/> 023758 38 Ft | <input type="checkbox"/> 023993 115 Ft |
| <input type="checkbox"/> 023693 50 Ft | <input type="checkbox"/> 123189 120 Ft |
| <input type="checkbox"/> 123046 60 Ft | <input type="checkbox"/> 023696 150 Ft |
| <input type="checkbox"/> 023694 75 Ft | <input type="checkbox"/> 023954 200 Ft |

**21) Water Muffler System-with Hoses (not used with stnls. steel torch)**

- |  |                     |
|--|---------------------|
| <input type="checkbox"/> 034096 WM Sys/w hoses | 240/480V, 3Ø, 60 Hz |
| <input type="checkbox"/> 034100 WM Sys/w hoses | 380/415V, 3Ø, 60 Hz |
| <input type="checkbox"/> 034098 WM Sys/w hoses | 600V, 3Ø, 60 Hz     |

**21) Water Muffler System-without Hoses (not used with stnls. steel torch)**

- |   |                     |
|---|---------------------|
| <input type="checkbox"/> 034097 WM Sys/wo hoses | 240/480V, 3Ø, 60 H  |
| <input type="checkbox"/> 034101 WM Sys/wo hoses | 380/415V, 3Ø, 60 Hz |
| <input type="checkbox"/> 034099 WM Sys/wo hoses | 600V, 3Ø, 60 Hz     |

**21a) Additional Length WM Hose, Specify Length (Ft)**

- 034051 Add'l Length W-M Hose (Qty in Ft.)

**22) Cable Between WM Pump and Power Supply**

- |  |
|--|
| <input type="checkbox"/> 023866 50 Ft  |
| <input type="checkbox"/> 023867 75 Ft  |
| <input type="checkbox"/> 023868 100 Ft |

**23a) Hose Between O<sub>2</sub> Supply and Gas Csl**

- |  |  |
|--|--|
| <input type="checkbox"/> 024204 15 Ft  | <input type="checkbox"/> 024450 115 Ft |
| <input type="checkbox"/> 024205 25 Ft  | <input type="checkbox"/> 024516 120 Ft |
| <input type="checkbox"/> 024155 50 Ft  | <input type="checkbox"/> 024490 125 Ft |
| <input type="checkbox"/> 024398 75 Ft  | <input type="checkbox"/> 024159 150 Ft |
| <input type="checkbox"/> 024487 85 Ft  | <input type="checkbox"/> 024470 180 Ft |
| <input type="checkbox"/> 024206 100 Ft | <input type="checkbox"/> 024333 200 Ft |
| <input type="checkbox"/> 024481 110 Ft |  |

**23b) Hose Between N<sub>2</sub> Supply and Gas Csl**

- |                                       |  |
|---------------------------------------|--|
| <input type="checkbox"/> 024505 6 Ft  | <input type="checkbox"/> 024116 100 Ft |
| <input type="checkbox"/> 024210 10 Ft | <input type="checkbox"/> 024482 110 Ft |
| <input type="checkbox"/> 024203 15 Ft | <input type="checkbox"/> 024451 115 Ft |
| <input type="checkbox"/> 024232 20 Ft | <input type="checkbox"/> 024517 120 Ft |
| <input type="checkbox"/> 024134 25 Ft | <input type="checkbox"/> 024491 125 Ft |
| <input type="checkbox"/> 024211 35 Ft | <input type="checkbox"/> 024120 150 Ft |
| <input type="checkbox"/> 024112 50 Ft | <input type="checkbox"/> 024185 180 Ft |
| <input type="checkbox"/> 024148 75 Ft | <input type="checkbox"/> 024124 200 Ft |
| <input type="checkbox"/> 024488 85 Ft |  |

**23c) Hose Between Shield Gas Supply and Gas Csl**

- |                                       |  |
|---------------------------------------|--|
| <input type="checkbox"/> 024043 4 Ft  | <input type="checkbox"/> 024486 85 Ft  |
| <input type="checkbox"/> 024341 10 Ft | <input type="checkbox"/> 024115 100 Ft |
| <input type="checkbox"/> 024200 15 Ft | <input type="checkbox"/> 024452 110 Ft |
| <input type="checkbox"/> 024342 20 Ft | <input type="checkbox"/> 024449 115 Ft |
| <input type="checkbox"/> 024133 25 Ft | <input type="checkbox"/> 024515 120 Ft |
| <input type="checkbox"/> 024448 35 Ft | <input type="checkbox"/> 024395 125 Ft |
| <input type="checkbox"/> 024407 45 Ft | <input type="checkbox"/> 024119 150 Ft |
| <input type="checkbox"/> 024012 50 Ft | <input type="checkbox"/> 024480 170 Ft |
| <input type="checkbox"/> 024472 60 Ft | <input type="checkbox"/> 024184 180 Ft |
| <input type="checkbox"/> 024147 75 Ft | <input type="checkbox"/> 024123 200 Ft |

**24) Argon/Hydrogen Console**

- 073109 Ar/H2 Csl

**25) Cable Between Ar/H2 Csl and PS**

- |                                       |  |
|---------------------------------------|--|
| <input type="checkbox"/> 023660 15 Ft | <input type="checkbox"/> 023663 75 Ft  |
| <input type="checkbox"/> 023661 25 Ft | <input type="checkbox"/> 023664 100 Ft |
| <input type="checkbox"/> 023662 50 Ft | <input type="checkbox"/> 023665 150 Ft |

**26) Hose Between Ar/H2 Csl and Trch**

- |                                       |                                       |
|---------------------------------------|---------------------------------------|
| <input type="checkbox"/> 024354 10 Ft | <input type="checkbox"/> 024370 40 Ft |
| <input type="checkbox"/> 024355 12 Ft | <input type="checkbox"/> 024443 50 Ft |
| <input type="checkbox"/> 024368 20 Ft | <input type="checkbox"/> 024467 75 Ft |
| <input type="checkbox"/> 024369 30 Ft |                                       |

**Spare Parts Kit**

- |   |
|---|
| <input type="checkbox"/> 128825 Kit: HySpeed consumables  |
| <input type="checkbox"/> 028602 Kit: Standard consumables |